

Frame

Tall units

Salvatore Indriolo, 2021

archiproducts
AWARDS
WINNER

Frame columns are available in two heights and in two widths, and can be fitted with doors, drawers and appliances, with no compositional limits.

Frame made of 35 x 35 mm (1.38" x 1.38") square tubes. Concealed levelling feet, laterally adjustable.

Doors inset in the frame, made of a double layer of bent sheet metal. Door thickness: 20 mm (0.79"). Metal handles with a coating in a colour to match the doors. Soft-close dampening hinges. Door opening 95°.

Sides and bases inset in the frame, made of bent sheet metal.

Optional backs in metal, flush to the frame.

Central foot standard for all models L128 cm H219 cm, optional for the others.

Internal shelves made of bent sheet metal.

Optional appliances with custom installation kit, from AEG, Barazza, Electrolux.

This product is delivered flat-packed (the units with a height of 173 cm can be assembled on request, following payment of a supplement).

Le colonne Frame sono proposte in due altezze e in due larghezze, e possono essere dotate di ante, cassetti ed elettrodomestici, senza limiti compositivi.

Telaio in tubolare quadrato 35 x 35 mm (1.38" x 1.38"). Piedini livellatori nascosti, regolabili lateralmente.

Ante in luce al telaio, in doppia lamiera piegata. Spessore delle ante 20 mm (0.79"). Maniglie in metallo verniciate in tinta con le ante. Cerniere ammortizzate. Apertura ante 95°.

Fianchi e fondi in luce al telaio, in lamiera piegata.

Schiene opzionali in metallo in luce al telaio.

Piedino centrale di serie per tutti i modelli L128 cm H219 cm, opzionale per gli altri.

Ripiani interni in lamiera piegata.

Elettrodomestici opzionali - con kit di installazione personalizzato - AEG, Barazza, Electrolux.

Il prodotto viene fornito smontato (solo le colonne H 173 cm possono essere montate su richiesta e con sovrapprezzo).

Frame-Hochschränke sind in zwei Höhen und in zwei Breiten erhältlich, und können mit Türen, Schubladen und Geräten ausgestattet werden, wobei es keine kompositorischen Grenzen gibt.

Gestell aus Vierkantröhr 35 x 35 mm (1.38" x 1.38"). Unsichtbare, seitlich einstellbare Füße.

Türen aus Doppelfalz-Blech, bündig mit dem Gestell. Stärke der Türen 20 mm (0.79"). Pulverbeschichtete Metallgriffe gleichfarbig mit den Türen. Gedämpfte Scharniere. Türen öffnen 95°.

Seiten und Basen aus Falzblech, bündig mit dem Gestell.

Optionale Rückwände aus Metall, bündig mit dem Gestell.

Mittelfuß, serienmäßig bei allen Modellen L128 cm H219 cm, optional bei den anderen.

Innere Einlegeböden aus Falzblech.

Optionales Haushaltsgeräte mit benutzerdefiniertes Bausatz, von AEG, Barazza, Electrolux.

Das Produkt wird zerlegt geliefert (nur die Hochschränke H 173 cm können auf Wunsch und mit Aufpreis montiert geliefert werden).



H173 cm / H173 cm / H173 cm

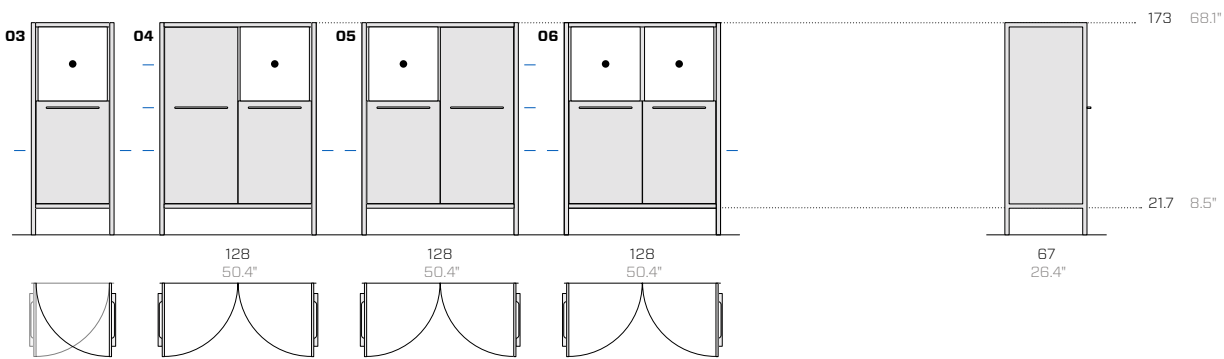
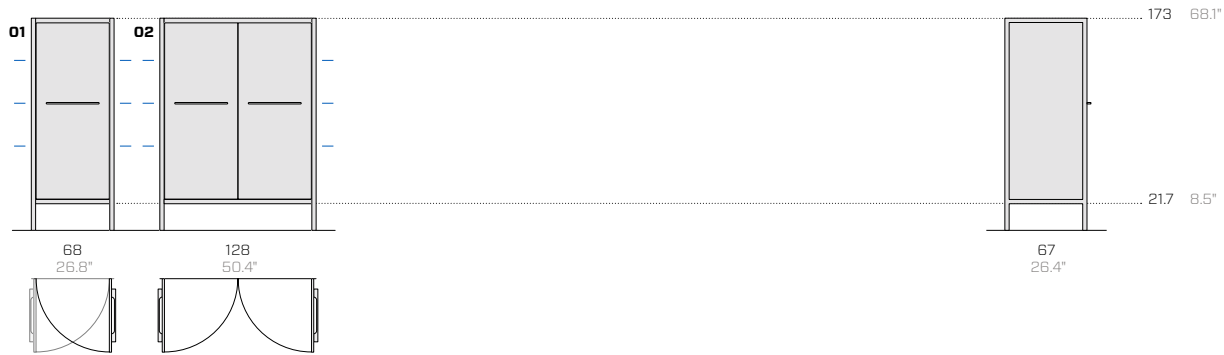

H173 cm for refrigerator / H173 cm per frigorifero / H173 cm für Kühlschrank

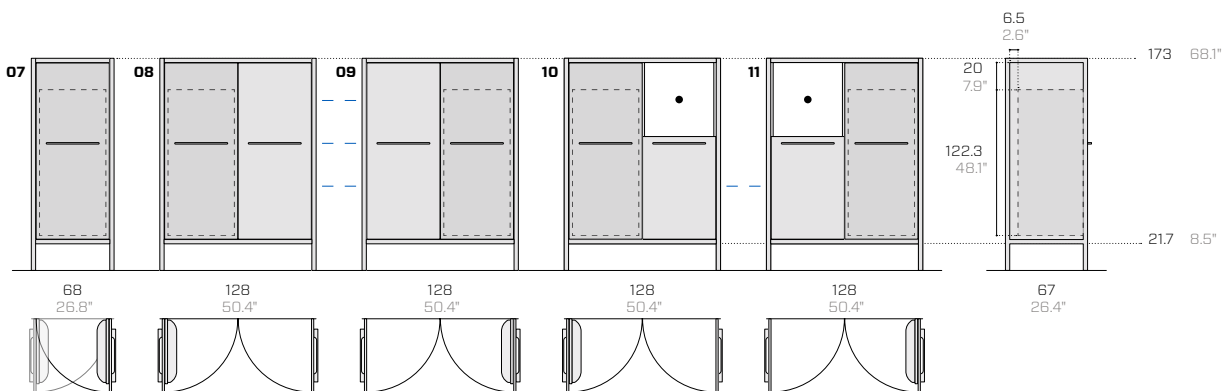

- Compartment for household appliances without Fantin door / Vano per elettrodomestici senza anta Fantin / Fach für Haushaltsgeräte ohne Fantin-Tür

Product / Prodotto / Produkt

No. / No. / N°	Price / Prezzo / Preis	Code / Codice / Code	Brand code / Codice marca / Herstellercode	Dimensions (w-d-h) / Dimensioni (l-p-h) / Abmessungen (b-t-h)	Weight / Peso / Gewicht	Dimensions (w-d-h) / Dimensioni (l-p-h) / Abmessungen (b-t-h)	Weight / Peso / Gewicht
	euro			cm	kg	cm	kg

H173 cm / H173 cm / H173 cm

01	—	FRC201	—	68 67 173	94	200 80 55	109
02	—	FRC202	—	128 67 173	149	200 80 95	164
03	—	FRC203	—	68 67 173	87	200 80 55	102
04	—	FRC204	—	128 67 173	140	200 80 95	155
05	—	FRC205	—	128 67 173	140	200 80 95	155
06	—	FRC206	—	128 67 173	132	200 80 95	147

H173 cm for refrigerator / H173 cm per frigorifero / H173 cm für Kühlschrank

07	—	FRC207	—	68 67 173	80	200 80 55	95
08	—	FRC208	—	128 67 173	140	200 80 95	155
09	—	FRC209	—	128 67 173	140	200 80 95	155
10	—	FRC210	—	128 67 173	130	200 80 95	145
11	—	FRC211	—	128 67 173	130	200 80 95	145

Back panels for freestanding tall unit / Schiene per colonna freestanding / Rückwände für freistehende Säule

—	—	FRK85F1	—	60 3 144	8	63 6 150	10
—	—	FRK86F2	—	120 3 144	16	63 6 150	18

Floor attachment cover kit / Kit di copertura allacciamenti a pavimento / Set für Abdeckung der Anschlüsse am Boden

—	—	FRK03A1	—	60 20 25	3	62 22 27	5
---	---	---------	---	----------	---	----------	---

Central foot kit / Kit piedino centrale / Mittelfuß-Bausatz

—	—	FRK16PC	—	3.5 3.5 21	1	7.5 7.5 25	1
---	---	---------	---	------------	---	------------	---

"Metal Design" finishes: 15% surcharge / Finiture "Metal Design": maggiorazione del 15% / "Metal Design"-Oberflächen: 15% Aufschlag

Optional packaging with wooden crate / Imballaggio opzionale con cassa in legno / Optionale Verpackung mit Holzkiste (260x90xH130) = € 900,00



- Scan the QR code to get information on **appliances**. Frame Tall units are compatible with Miele appliances.
- Scansiona il QR-Code per ottenere informazioni sugli **elettrodomestici**. Le colonne Frame sono compatibili con l'installazione di elettrodomestici Miele.
- Über den QR-Code erhalten Sie Informationen zu **Geräte**. Frame-Hochschränke sind mit der Installation von Geräten der Marke Miele kompatibel.

Useful information / Informazioni utili / Nützliche Informationen

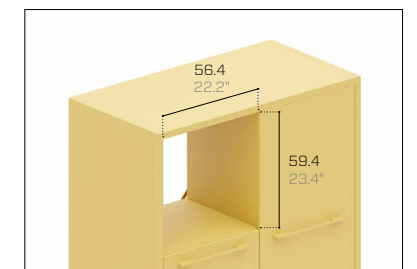

H173 cm for dishwasher / H173 cm per lavastoviglie / H173 cm für Geschirrspüler

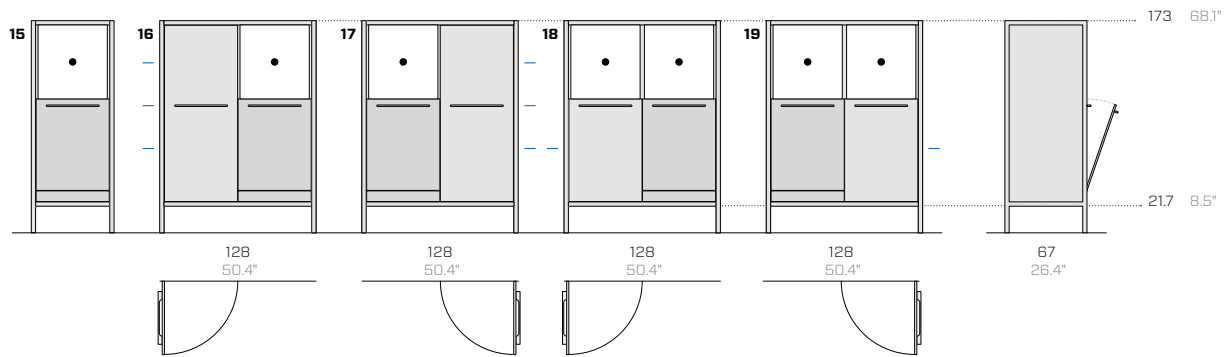
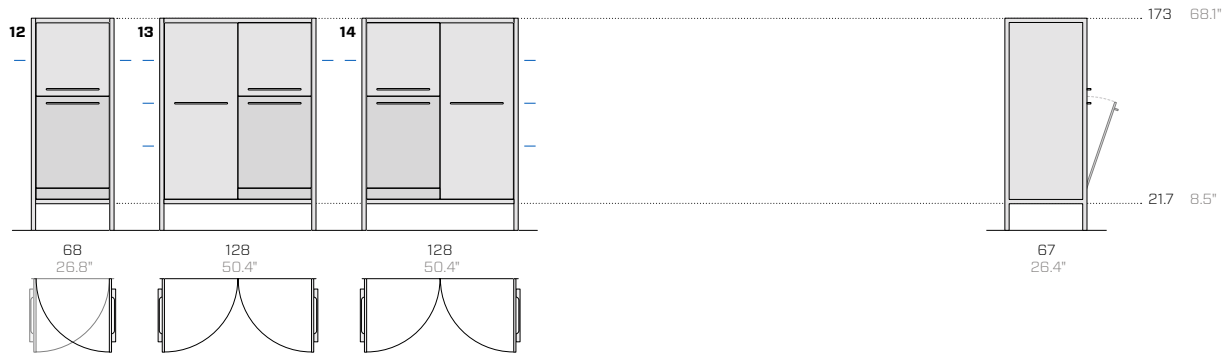

H173 cm for dishwasher and refrigerator / H173 cm per lavastoviglie e frigorifero / H173 cm für Geschirrspüler und Kühlschrank

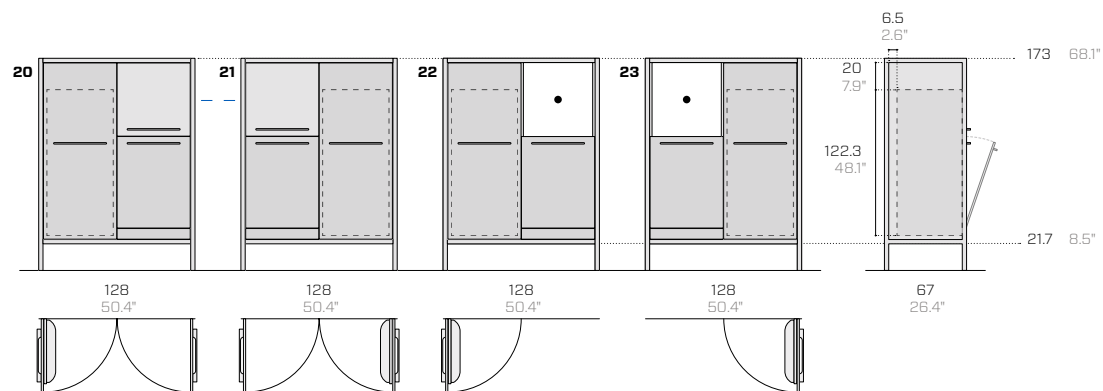

• Compartment for household appliances without Fantin door / Vano per elettrodomestici senza anta Fantin / Fach für Haushaltsgeräte ohne Fantin-Tür

Product / Prodotto / Produkt						Packaging / Imballo / Verpackung		
No.	Price	Code	Brand code	Dimensions (w-d-h)	Weight	Dimensions (w-d-h)	Weight	
No.	Prezzo	Codice	Codice marca	Dimensioni (l-p-h)	Peso	Dimensioni (l-p-h)	Peso	
N°	Preis	Code	Herstellercode	Abmessungen (b-t-h)	Gewicht	Abmessungen (b-t-h)	Gewicht	
	euro			cm	kg	cm	kg	

H173 cm for dishwasher / H173 cm per lavastoviglie / H173 cm für Geschirrspüler

12	-	FRC212	-	68 67 173	91	200 80 55	106
13	-	FRC213	-	128 67 173	147	200 80 95	162
14	-	FRC214	-	128 67 173	147	200 80 95	162
15	-	FRC215	-	68 67 173	80	200 80 55	95
16	-	FRC216	-	128 67 173	134	200 80 95	149
17	-	FRC217	-	128 67 173	134	200 80 95	149
18	-	FRC218	-	128 67 173	125	200 80 95	140
19	-	FRC219	-	128 67 173	125	200 80 95	140

H173 cm for dishwasher and refrigerator / H173 cm per lavastoviglie e frigorifero / H173 cm für Geschirrspüler und Kühlschrank

20	-	FRC220	-	128 67 173	134	200 80 95	149
21	-	FRC221	-	128 67 173	134	200 80 95	149
22	-	FRC222	-	128 67 173	123	200 80 95	138
23	-	FRC223	-	128 67 173	123	200 80 95	138

Back panels for freestanding tall unit / Schiene per colonna freestanding / Rückwände für freistehende Säule

-	-	FRK85F1	-	60 3 144	8	63 6 150	10
-	-	FRK86F2	-	120 3 144	16	63 6 150	18

Floor attachment cover kit / Kit di copertura allacciamenti a pavimento / Set für Abdeckung der Anschlüsse am Boden

-	-	FRK03A1	-	60 20 25	3	62 22 27	5
---	---	---------	---	----------	---	----------	---

Central foot kit / Kit piedino centrale / Mittelfuß-Bausatz

-	-	FRK16PC	-	3.5 3.5 21	1	7.5 7.5 25	1
---	---	---------	---	------------	---	------------	---

"Metal Design" finishes: 15% surcharge / Finiture "Metal Design": maggiorazione del 15% / "Metal Design"-Oberflächen: 15% Aufschlag

Optional packaging with wooden crate / Imballaggio opzionale con cassa in legno / Optionale Verpackung mit Holzkiste (260x90xH130) = € 900,00



- Scan the QR code to get information on **appliances**. Frame Tall units are compatible with Miele appliances.
- Scansiona il QR-Code per ottenere informazioni sugli **elettrodomestici**. Le colonne Frame sono compatibili con l'installazione di elettrodomestici Miele.
- Über den QR-Code erhalten Sie Informationen zu **Geräte**. Frame-Hochschränke sind mit der Installation von Geräten der Marke Miele kompatibel.

H219 cm / H219 cm / H219 cm

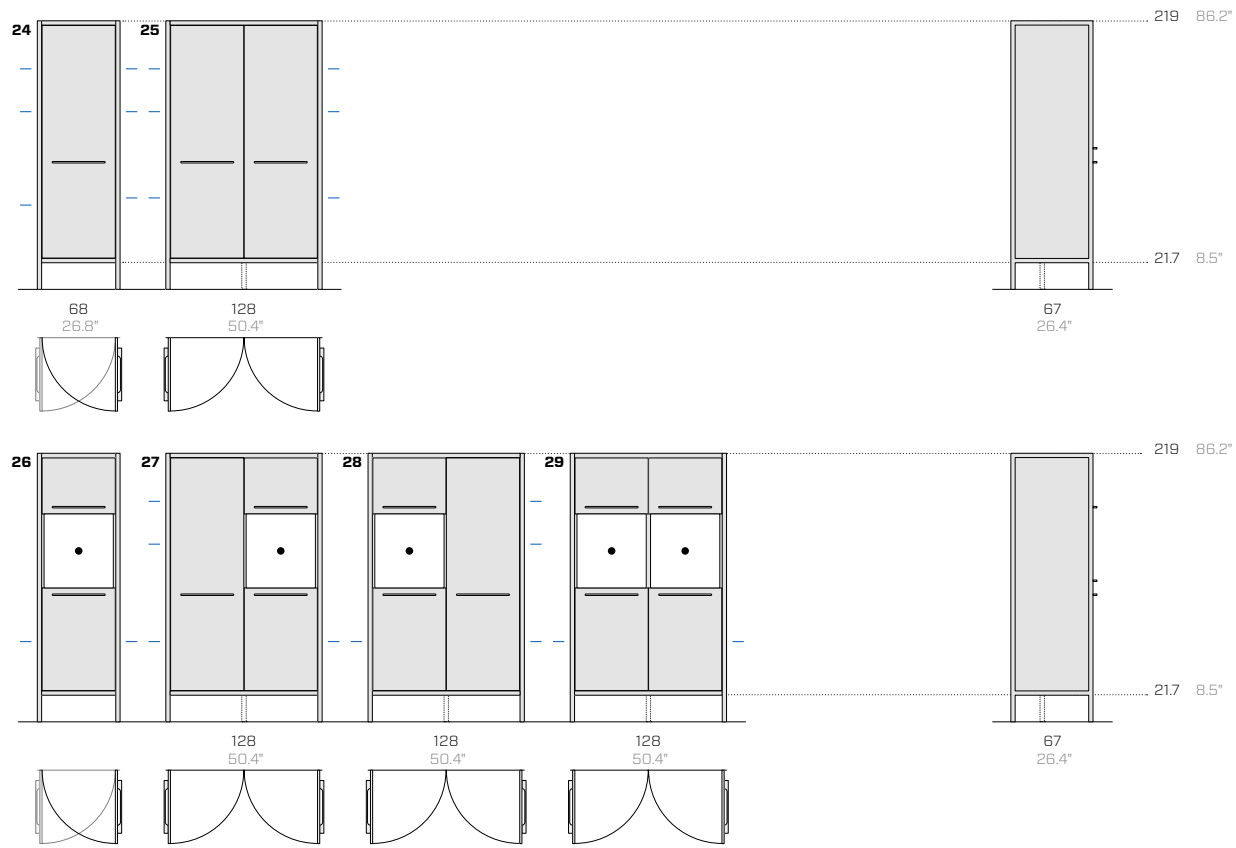

H219 cm for refrigerator / H219 cm per frigorifero / H219 cm für Kühlschrank

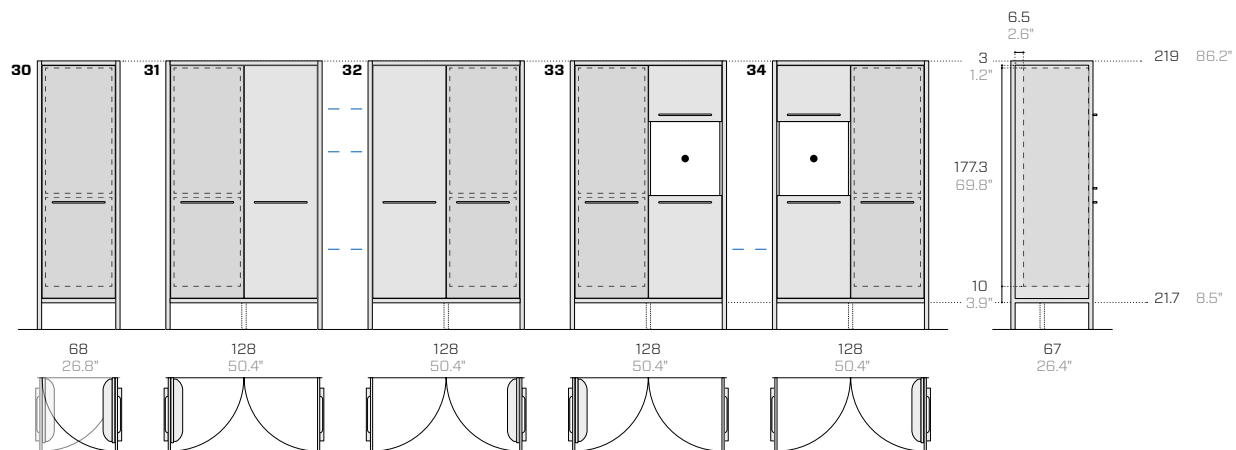

• Compartment for household appliances without Fantin door / Vano per elettrodomestici senza anta Fantin / Fach für Haushaltsgeräte ohne Fantin-Tür

Product / Prodotto / Produkt

Packaging / Imballo / Verpackung

No.	Price	Code	Brand code	Dimensions (w-d-h)	Weight	Dimensions (w-d-h)	Weight
No.	Prezzo	Codice	Codice marca	Dimensioni (l-p-h)	Peso	Dimensioni (l-p-h)	Peso
N°	Preis	Code	Herstellercode	Abmessungen (b-t-h)	Gewicht	Abmessungen (b-t-h)	Gewicht
	euro			cm	kg	cm	kg

H219 cm / H219 cm / H219 cm

24	-	FRC247	-	68 67 219	125	240 80 55	160
25	-	FRC248	-	128 67 219	200	240 80 95	235
26	-	FRC226	-	68 67 219	120	240 80 55	155
27	-	FRC249	-	128 67 219	190	240 80 95	225
28	-	FRC250	-	128 67 219	190	240 80 95	225
29	-	FRC229	-	128 67 219	185	240 80 95	220

H219 cm for refrigerator / H219 cm per frigorifero / H219 cm für Kühlschrank

30	-	FRC251	-	68 67 219	112	240 80 55	147
31	-	FRC252	-	128 67 219	184	240 80 95	219
32	-	FRC253	-	128 67 219	184	240 80 95	219
33	-	FRC254	-	128 67 219	174	240 80 95	209
34	-	FRC255	-	128 67 219	174	240 80 95	209

Back panels for freestanding tall unit / Schiene per colonna freestanding / Rückwände für freistehende Säule

-	-	FRK87F1	-	60 3 190	12	63 6 196	15
-	-	FRK88F1	-	120 3 190	24	63 6 196	27

Floor attachment cover kit / Kit di copertura allacciamenti a pavimento / Set für Abdeckung der Anschlüsse am Boden

-	-	FRK03A1	-	60 20 25	3	62 22 27	5
---	---	---------	---	----------	---	----------	---

"Metal Design" finishes: 15% surcharge / Finiture "Metal Design": maggiorazione del 15% / "Metal Design"-Oberflächen: 15% Aufschlag

Optional packaging with wooden crate / Imballaggio opzionale con cassa in legno / Optionale Verpackung mit Holzkiste (260x90xH130) = € 900,00



- Scan the QR code to get information on **appliances**. Frame Tall units are compatible with Miele appliances.
- Scansiona il QR-Code per ottenere informazioni sugli **elettrodomestici**. Le colonne Frame sono compatibili con l'installazione di elettrodomestici Miele.
- Über den QR-Code erhalten Sie Informationen zu **Geräte**. Frame-Hochschränke sind mit der Installation von Geräten der Marke Miele kompatibel.

H219 cm for dishwasher / H219 cm per lavastoviglie / H219 cm für Geschirrspüler

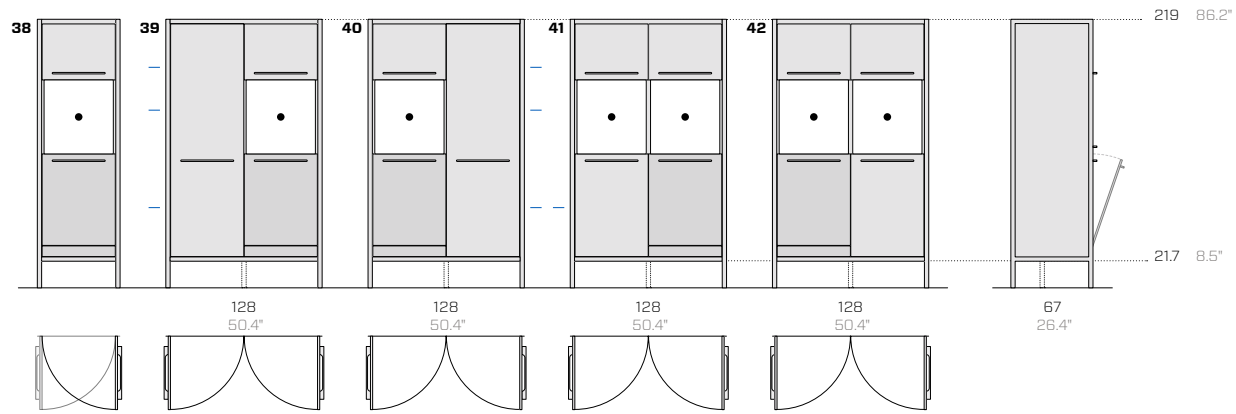
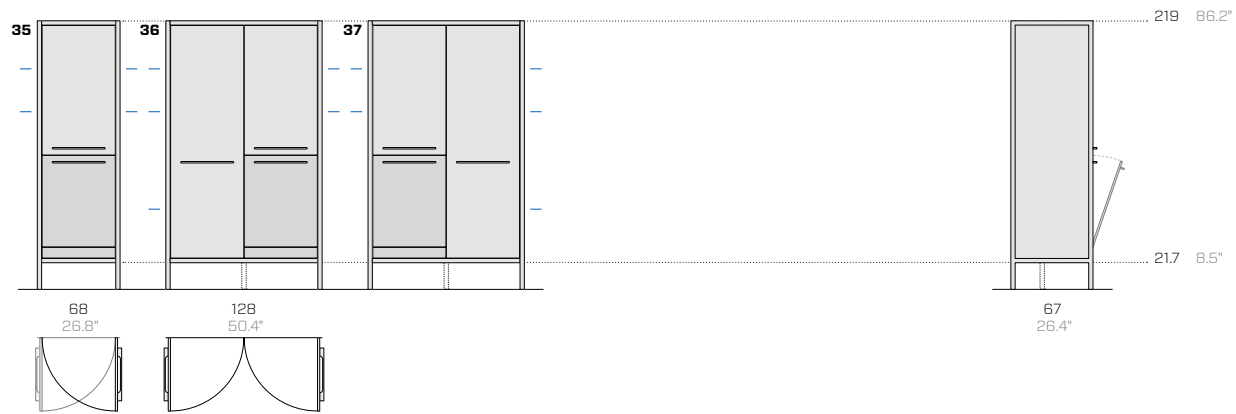

H219 cm for dishwasher and refrigerator / H219 cm per lavastoviglie e frigorifero / H219 cm für Geschirrspüler und Kühlschrank

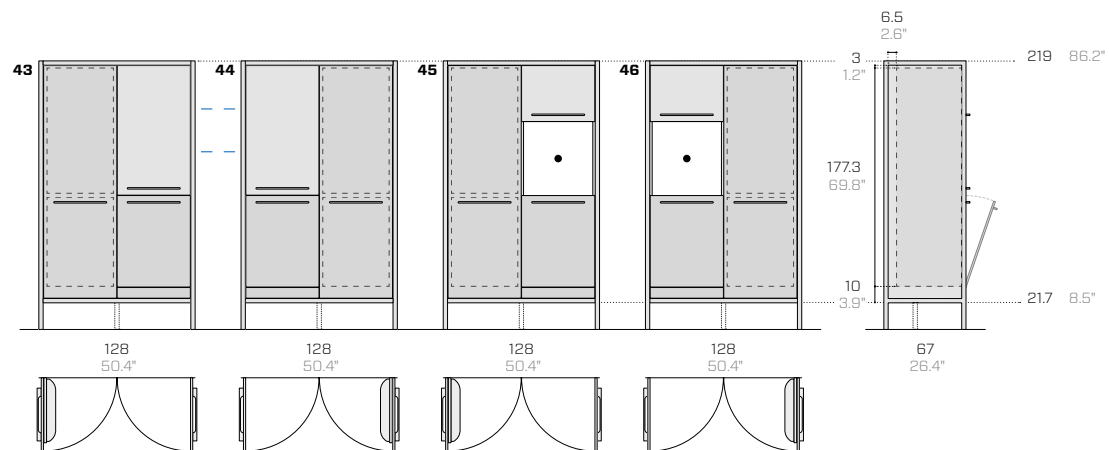

• Compartment for household appliances without Fantin door / Vano per elettrodomestici senza anta Fantin / Fach für Haushaltsgeräte ohne Fantin-Tür

Product / Prodotto / Produkt

Packaging / Imballo / Verpackung

No. / No. / N°	Price / Prezzo / Preis	Code / Codice / Code	Brand code / Codice marca / Herstellercode	Dimensions (w-d-h) / Dimensioni (l-p-h) / Abmessungen (b-t-h)	Weight / Peso / Gewicht	Dimensions (w-d-h) / Dimensioni (l-p-h) / Abmessungen (b-t-h)	Weight / Peso / Gewicht
	euro			cm	kg	cm	kg

H219 cm for dishwasher / H219 cm per lavastoviglie / H219 cm für Geschirrspüler

35	-	FRC235	-	68 67 219	120	240 80 55	155
36	-	FRC256	-	128 67 219	193	240 80 95	228
37	-	FRC257	-	128 67 219	193	240 80 95	228
38	-	FRC238	-	68 67 219	110	240 80 55	145
39	-	FRC258	-	128 67 219	183	240 80 95	218
40	-	FRC259	-	128 67 219	183	240 80 95	218
41	-	FRC241	-	128 67 219	172	240 80 95	207
42	-	FRC242	-	128 67 219	172	240 80 95	207

H219 cm for dishwasher and refrigerator / H219 cm per lavastoviglie e frigorifero / H219 cm für Geschirrspüler und Kühlschrank

43	-	FRC260	-	128 67 219	177	240 80 95	212
44	-	FRC261	-	128 67 219	177	240 80 95	212
45	-	FRC262	-	128 67 219	164	240 80 95	199
46	-	FRC263	-	128 67 219	164	240 80 95	199

Back panels for freestanding tall unit / Schiene per colonna freestanding / Rückwände für freistehende Säule

-	-	FRK87F1	-	60 3 190	12	63 6 196	15
-	-	FRK88F1	-	120 3 190	24	63 6 196	27

Floor attachment cover kit / Kit di copertura allacciamenti a pavimento / Set für Abdeckung der Anschlüsse am Boden

-	-	FRK03A1	-	60 20 25	3	62 22 27	5
---	---	---------	---	----------	---	----------	---

"Metal Design" finishes: 15% surcharge / Finiture "Metal Design": maggiorazione del 15% / "Metal Design"-Oberflächen: 15% Aufschlag

Optional packaging with wooden crate / Imballaggio opzionale con cassa in legno / Optionale Verpackung mit Holzkiste (260x90xH130) = € 900,00









- Scan the QR code to get information on **appliances**. Frame Tall units are compatible with Miele appliances.
- Scansiona il QR-Code per ottenere informazioni sugli **elettrodomestici**. Le colonne Frame sono compatibili con l'installazione di elettrodomestici Miele.
- Über den QR-Code erhalten Sie Informationen zu **Geräte**. Frame-Hochschränke sind mit der Installation von Geräten der Marke Miele kompatibel.

Metal Essentials







 <p>01.18 Black (RAL 9005) Nero / Schwarz --- EM ▲</p>	 <p>08.20 Rose quartz Rosa quarzo / Rosenquarz --- EM ▲</p>	 <p>15.19 Forest green (RAL 6007) Verde bosco / Waldgrün --- EM ▲●</p>
 <p>02.18 Anthracite (RAL 7021) Antracite / Anthrazit --- EM ▲●</p>	 <p>09.24 Terracotta (RAL 8004) Terracotta / Terrakotta --- EM ▲●</p>	 <p>16.24 Cement (RAL 7033) Cemento / Zement --- EM ▲●</p>
 <p>03.18 Fantin grey Grigio Fantin / Fantin-Grau --- EM ▲●</p>	 <p>10.21 Flame red (RAL 3000) Rosso fuoco / Feuerrot --- EM ▲</p>	 <p>17.24 Slate (RAL 7031) Ardesia / Schiefer --- EM ▲●</p>
 <p>04.18 Light grey (RAL 7035) Grigio luce / Lichtgrau --- EM ▲●</p>	 <p>11.21 Melon yellow (RAL 1028) Giallo melone / Melonengelb --- EM ▲●</p>	 <p>18.21 Dusty blue (RAL 5014) Azzurro polvere / Staubiges blau --- EM ▲</p>
 <p>05.19 Cloud grey Grigio nuvola / Walkengrau --- EM ▲</p>	 <p>12.19 Zinc yellow (RAL 1018) Giallo zinco / Zinkgelb --- EM ▲</p>	 <p>19.18 Gentian blue (RAL 5010) Blu genziana / Enzianblau --- EM ▲●</p>
 <p>06.18 White (RAL 9016) Bianco / Weiß --- EM ▲</p>	 <p>13.21 Pastel green (RAL 6019) Verde pastello / Weißgrün --- EM ▲●</p>	 <p>20.19 Steel blue (RAL 5011) Blu acciaio / Stahlblau --- EM ▲</p>
 <p>07.21 Milk white (RAL 9001) Bianco latte / Milchweiß --- EM ▲●</p>	 <p>14.18 Sage green (RAL 6021) Verde salvia / Salbeigrün --- EM ▲●</p>	 <p>21.21 Coffee brown (RAL 8019) Marrone caffè / Kaffeebraun --- EM ▲</p>

Metal Design

Metallic

 <p>61.24 Pale gold Oro chiaro / Hellgold --- EM ▲</p>	 <p>62.24 Copper Rame / Kupfer --- EM ▲●</p>	 <p>47.21 Platinum Platino / Platin --- EM ▲</p>	 <p>43.21 Bronze Bronzo / Bronze --- EM ▲</p>	 <p>63.24 Graphite Grafite / Graphit --- EM ▲●</p>	 <p>64.24 Silver green Verde argento / Silbergrün --- EM ▲●</p>	 <p>65.24 Silver blue Blu argento / Silberblau --- EM ▲●</p>
---	---	---	---	---	--	---

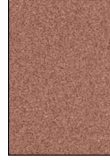
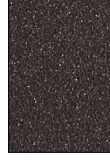
Earth

 <p>51.18 Sand Sabbia / Sand --- EM ▲●</p>	 <p>57.21 Clay Creta / Lehm --- EM ▲●</p>	 <p>52.18 Moss Muschio / Moos --- EM ▲●</p>	 <p>66.24 Lichen Lichene / Flechte --- EM ▲</p>	 <p>67.24 Pink clay Argilla rosa / Rosa Ton --- EM ▲●</p>	 <p>68.24 Sodalite Sodalite / Sodalith --- EM ▲</p>	 <p>56.21 Ocean Oceano / Ozean --- EM ▲</p>
---	--	--	---	--	--	--

For "Metal Design" finishes (Metallic, Earth), a 15% surcharge is applied. For orders with products of the same model in more than three different colours, Fantin reserves the possibility to evaluate a handling fee, discreetly according to order.

Per le finiture "Metal Design" (Metallic, Earth), è prevista una maggiorazione del 15%. Per ordini con prodotti dello stesso modello in più di tre colori, Fantin si riserva la possibilità di valutare un addebito per la gestione.

Für "Metal Design"-Oberflächen (Metallic, Earth) wird ein Aufschlag von 15% erhoben. Im Falle einer Bestellung mit Produkten desselben Modells in mehr als drei Farben, behält sich Fantin die Möglichkeit vor, einen Zuschlag für die Bearbeitung zu berechnen, mit Ermessensspielraum je nach Auftrag.

Surfaces / Superfici / Oberflächen

EM Embossed / Goffrato / Gaufriert













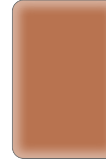

Use / Utilizzo / Verwenden

- ▲ Tops / Top / Arbeitsplatte
- Outdoor / Esterni / Außenbereich
- Food / Alimentare / Lebensmittel

Glass Essentials

 G01.23 Black (RAL 9005) Nero / Schwarz --- ET ▲ ■	 G08.23 Rose quartz Rosa quarzo / Rosenquarz --- ET ▲ ■	 G15.23 Forest green (RAL 6007) Verde bosco / Waldgrün --- ET ▲ ■
 G02.23 Anthracite (RAL 7021) Antracite / Anthrazit --- ET ▲ ■	 G09.24 Terracotta (RAL 8004) Terracotta / Terrakotta --- ET ▲ ■	 G16.24 Cement (RAL 7033) Cemento / Zement --- ET ▲ ■
 G03.23 Fantin grey Grigio Fantin / Fantin-Grau --- ET ▲ ■	 G10.23 Flame red (RAL 3000) Rosso fuoco / Feuerrot --- ET ▲ ■	 G17.24 Slate (RAL 7031) Ardesia / Schiefer --- ET ▲ ■
 G04.23 Light grey (RAL 7035) Grigio luce / Lichtgrau --- ET ▲ ■	 G11.23 Melon yellow (RAL 1028) Giallo melone / Melonengelb --- ET ▲ ■	 G18.23 Dusty blue (RAL 5014) Azzurro polvere / Staubiges blau --- ET ▲ ■
 G05.23 Cloud grey Grigio nuvola / Wolkengrau --- ET ▲ ■	 G12.23 Zinc yellow (RAL 1018) Giallo zinco / Zinkgelb --- ET ▲ ■	 G19.23 Gentian blue (RAL 5010) Blu genziana / Enzianblau --- ET ▲ ■
 G06.23 White (RAL 9016) Bianco / Weiß --- ET ▲ ■	 G13.23 Pastel green (RAL 6019) Verde pastello / Weißgrün --- ET ▲ ■	 G20.23 Steel blue (RAL 5011) Blu acciaio / Stahlblau --- ET ▲ ■
 G07.23 Milk white (RAL 9001) Bianco latte / Milchweiß --- ET ▲ ■	 G14.23 Sage green (RAL 6021) Verde salvia / Salbeigrün --- ET ▲ ■	 G21.23 Coffee brown (RAL 8019) Marrone caffè / Kaffeebraun --- ET ▲ ■

Glass Design

 G61.24 Pale gold Oro chiaro / Hellgold --- ET ▲ ■	 G51.23 Sand Sabbia / Sand --- ET ▲ ■
 G62.24 Copper Rame / Kupfer --- ET ▲ ■	 G57.23 Clay Creta / Lehm --- ET ▲ ■
 G47.23 Platinum Platino / Platin --- ET ▲ ■	 G52.23 Moss Muschio / Moos --- ET ▲ ■
 G43.23 Bronze Bronzo / Bronze --- ET ▲ ■	 G66.24 Lichen Lichene / Flechte --- ET ▲ ■
 G63.24 Graphite Grafite / Graphit --- ET ▲ ■	 G67.24 Pink clay Argilla rosa / Rosa Ton --- ET ▲ ■
 G64.24 Silver green Verde argento / Silbergrün --- ET ▲ ■	 G68.24 Sodalite Sodalite / Sodalith --- ET ▲ ■
 G65.24 Silver blue Blu argento / Silberblau --- ET ▲ ■	 G56.23 Ocean Oceano / Ozean --- ET ▲ ■

For orders containing the same model of a product in more than three different colours, Fantin reserves the right to consider charging a handling fee.

Per ordini con prodotti dello stesso modello in più di tre colori, Fantin si riserva la possibilità di valutare un addebito per la gestione.

Bei Bestellungen von Produkten desselben Modells in mehr als drei verschiedenen Farben, behält sich Fantin die Möglichkeit vor, eine Bearbeitungsgebühr zu berechnen.

Surfaces / Superfici / Oberflächen

ET Etched / Acidato / Geätzt

Use / Utilizzo / Verwenden

- ▲ Tops / Top / Arbeitsplatte
- Outdoor / Esterni / Außenbereich
- Food / Alimentare / Lebensmittel

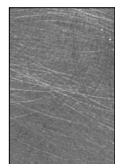
Stainless steel
Acciaio inox
Edelstahl CNS

K1.18
Inox Vintage
 Inox Vintage / Inox Vintage

HG ▲●■



K2.19
Inox Satin
 Inox satinato / Inox satiniert

HG ▲●■

Porcelain stoneware
Gres porcellanato
Feinsteinzeug

S1.26
Dark
 Scuro / Dunkel

EM ▲●■



S2.26
Ash
 Cenere / Asche

EM ▲●■



S3.26
Light
 Chiaro / Hell

EM ▲●■

Melamine coated
Nobilitato
Melaminbeschichtet

M3.21
Black
 Nero / Schwarz

EM ▲



M1.18
Grey
 Grigio / Grau

EM ▲



M2.18
White
 Bianco / Weiß

EM ▲

Fabric
Tessuto
Textil

T1.26
Smoke
 Fumo / Rauch



T2.26
Hemp
 Canapa / Hanf

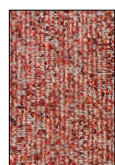

T3.26
Oxide
 Ossido / Oxid



T4.26
Amber
 Ambra / Bernstein

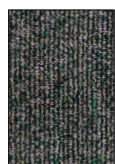

T5.26
Leaf
 Foglia / Blatt



T6.26
Navy
 Navy / Marine

Surfaces / Superfici / Oberflächen

EM Embossed / Goffrato / Gaufriert
HG High Gloss / Lucido / Glänzend

Use / Utilizzo / Verwenden

- ▲ Tops / Top / Arbeitsplatte
- Outdoor / Esterni / Außenbereich
- Food / Alimentare / Lebensmittel

Technical information

Metal Non-toxic powder coating for interior use, with no heavy metals. Cured in an oven at 190 °C, following degreasing and phosphating. Guaranteed minimum thickness of 50 microns. Minimum resistance to salt spray of 200 hours (in accordance with the ASTM B117 standard). Some finishes are suitable for direct contact with food as required by Italian Law Decree D.M. 21/03/73. Requests for other RAL finishes can be considered. On some finishes, any partial discoloration following rubbing and/or abrasion has absolutely no effect on the technical, appearance/colour and chemical/physical characteristics of the product. This phenomenon tends to diminish over the useful life of the product and does not in any case present a health hazard to users.

Glass Extra-clear glass, thickness 6 mm (0.24"), acid-etched on the upper surface, ground with a smooth edge. Back-painted with water-based coatings in the 35 Fantin finishes.

Stainless steel Tops in AISI 304 stainless steel for indoor use and AISI 316 for outdoor use. Satin or Vintage finish (manual processing).

Porcelain stoneware Full-body porcelain stoneware tops, thickness 12 mm (0.47"), highly resistant to impacts, scratches, chemicals and high temperatures, suitable for indoor and outdoor use.

Melamine-faced panel Top with a wood-fibre panel core finished with melamine coatings. Other melamine finishes available on request.

Fabric Upholstery in technical fabric for furniture, made with 100% regenerated yarns certified GRS (Global Recycled Standard), wear-resistant and easy to maintain, suitable for indoor use.

Informazioni tecniche

Metallo Verniciatura per interni a polveri atossiche prive di metalli pesanti, con passaggio in forno a 190 °C, previo trattamento di sgrassaggio e fosfatazione. Spessore minimo garantito 50 micron, resistenza minima in nebbia salina pari a 200 ore (norma ASTM B117). Alcune finiture sono idonee al contatto diretto con alimenti come previsto dal decreto italiano D.M. 21/03/73. Altre finiture RAL valutabili su richiesta. Su alcune finiture, l'eventuale parziale cessione di colore in seguito a strofinamento e/o abrasione non influisce assolutamente sulle caratteristiche tecniche, di aspetto/colore, e chimico-fisiche del prodotto. Tale fenomeno tende a diminuire nel corso della vita utile del manufatto e non comporta in alcun caso pericoli per la salute degli utilizzatori.

Vetro Vetro extra-chiaro di spessore 6 mm (0.24"), acidato superiormente, molato con bordo filo-opaco. Retroverniciato con verniciatura all'acqua nelle 35 finiture Fantin.

Acciaio inox Piani in acciaio inox AISI 304 per uso indoor e AISI 316 per uso outdoor. Finitura satinata o Vintage (lavorazione manuale).

Grès porcellanato Piani in grès porcellanato a tutta massa, spessore 12 mm (0.47"), ad elevata resistenza a urti, graffi, agenti chimici e alte temperature, idonei per utilizzo indoor e outdoor.

Nobilitato Piano con struttura in pannello di fibre di legno rivestito con finiture melaminiche. Altre finiture melaminiche disponibili su richiesta.

Tessuto Rivestimento in tessuto tecnico per arredo, realizzato con filati 100% rigenerati certificati GRS (Global Recycled Standard), resistente all'usura e di facile manutenzione, idoneo per utilizzo indoor.

Technische Informationen

Metall Die Pulverbeschichtung der gift- und schwermetallfreien Pulverlacke für Innenbereiche erfolgt im Lackierofen bei 190 °C nach vorheriger Entfettung und Phosphatierung. Die garantierte Mindeststärke der Lackschicht beträgt 50 Mikron bei einer Mindestprüfungsdauer von 200 Stunden im Salznebel (ASTM-Norm B117). Einige Oberflächen sind für den direkten Kontakt mit Lebensmitteln geeignet, wie in der Verordnung vorgesehen Italienischer D.M. 21/03/73. Auf Anfrage können andere RAL- Finishes in Betracht gezogen werden. Bei einigen Ausführungen hat eine teilweise Verfärbung durch Reiben und/oder Abrieb keine Auswirkungen auf die technischen, optischen/farblichen und chemisch-physikalischen Eigenschaften des Produkts. Dieses Phänomen nimmt im Laufe der Nutzungsdauer des Produkts tendenziell ab und stellt in keinem Fall eine Gefahr für die Gesundheit der Benutzer dar.

Glas Extraklares Glas, Stärke 6 mm (0.24"), oberseitig geätzt, mit geschliffener, glatter Kante. Rückseitig lackiert mit wasserbasiereten Beschichtungen in den 35 Fantin-Oberflächen.

Edelstahl Arbeitsplatten aus Edelstahl AISI 304 für den Innenbereich und AISI 316 für den Außenbereich. Satiniert oder Vintage-Oberfläche (manuelle Bearbeitung).

Feinsteinzeug Arbeitsplatten aus durchgefärbtem Feinsteinzeug, Stärke 12 mm (0.47"), hohe Beständigkeit gegen Stöße, Kratzer, Chemikalien und hohe Temperaturen, geeignet für Innen- und Außenbereiche.

Melaminbeschichtete Platte Platte mit Kern aus Holzfasern und melaminbeschichteter Oberfläche. Weitere melaminbeschichtete Oberflächen auf Anfrage erhältlich.

Textil Bezug aus technischem Möbelstoff, hergestellt aus 100% regenerierten Garnen, GRS-zertifiziert (Global Recycled Standard), verschleißfest und pflegeleicht, geeignet für den Innenbereich.

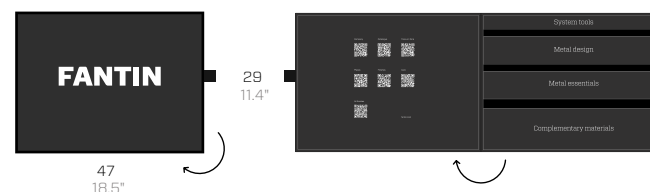
Sample box / Box campionari / Musterbox

- Scan for information
- Scansiona per informazioni
- Scannen Sie nach Informationen

Disclaimer / Esclusione di responsabilità / Haftungsausschluss

Fantin Srl reserves the right to change the dimensions and features of the products contained in this technical data sheet at any time and without prior notice. The finishes illustrated are purely indicative as the accuracy tolerances of printing processes should be taken into account.

Fantin Srl si riserva la facoltà di modificare in qualsiasi momento e senza preavviso le dimensioni e l'esecuzione dei prodotti contenuti nella presente scheda tecnica. Le finiture riportate hanno valore indicativo in quanto soggette alle tolleranze dei processi di stampa.

Fantin Srl behält sich das Recht vor, die angegebenen Maße und Ausführungen der Produkte, welche dieses Produktblatt enthält, jederzeit ohne Vorankündigung zu ändern. Aufgrund drucktechnischer Abweichungen dienen die dargestellten Ausführungen nur der Illustration.

Fantin Srl

via San Vito, 43
33080 - Bannia
di Fiume Veneto (PN)
Italia

t +39 0434 959 133
f +39 0434 560 037
fantin@fantin.com
www.fantin.com

