

# DISASSEMBLY INSTRUCTION MANUAL



## RECYCLING & DISASSEMBLY

All the furniture in this instruction manual is ecolabelled and designed to be long-lasting products made to endure years to come. The furniture is 100% recyclable and parts can be fully separated and recycled. All parts can be delivered to a suitable recycling facility.

AAC 08 .....	5
AAC 12 .....	6
AAC 14 .....	7
AAC 16 .....	8
AAC 18 .....	9
AAC 20 .....	10
AAC 22 .....	11
AAC 24 .....	12
AAC 26 .....	13
AAC 50 .....	14
AAC 52 .....	15
AAS 32 .....	16
AAS 38 .....	17
AMANTA .....	57
ANNEX TABLE   ALUMINIUM LEGS   4 LEGS .....	59
ANNEX TABLE   ALUMINIUM LEGS   6 LEGS .....	60
ANNEX TABLE   WOOD LEGS.....	58
ARBOUR ECO .....	3
BOA TABLE.....	52
CHISEL LOUNGE CHAIR.....	4
COLOUR RACK C-SHAPE.....	54
COLOUR RACK S-SHAPE.....	53
CPH 10 TABLE .....	38
CPH 25 TABLE.....	39
CPH 30 EXTENDABLE TABLE .....	41
CPH 30 TABLE.....	40
CPH 90 TABLE.....	42

CPH 190 TABLE .....	43
CPH DEUX 210 TABLE.....	44
CPH DEUX 215 BENCH.....	45
CPH DEUX 220 TABLE .....	46
LAYOUT ARMCHAIR 211   212   213   214 .....	61
LAYOUT ARMCHAIR 221   222   223   224.....	62
LAYOUT ARMCHAIR 231   232   233   234.....	63
LAYOUT ARMCHAIR 241   242   243   244.....	64
LAYOUT FULL UPHOLSTERY .....	66
LAYOUT SEAT UPHOLSTERY .....	65
LOOP STAND ROUND TABLE.....	51
LOOP STAND TABLE.....	50
PASTIS TABLE .....	47
RESULT ARMCHAIR.....	34
RESULT ARMCHAIR WITH UPHOLSTERY.....	35
RESULT CHAIR.....	32
RESULT CHAIR WITH UPHOLSTERY.....	33
REVOLT CHAIR .....	36
SOFT EDGE 40 CHAIR .....	18
SOFT EDGE 40 CHAIR WITH UPHOLSTERY .....	19
SOFT EDGE 50 SLED .....	20
SOFT EDGE 50 SLED WITH UPHOLSTERY .....	21
SOFT EDGE 60 CHAIR .....	22
SOFT EDGE 60 CHAIR WITH UPHOLSTERY .....	23
SOFT EDGE 70 STOOL.....	24
SOFT EDGE 72 STOOL.....	25
SOFT EDGE 80 BAR STOOL .....	26

SOFT EDGE 82 BAR STOOL.....	27
SOFT EDGE 90 BAR STOOL .....	28
SOFT EDGE 90 BAR STOOL WITH UPHOLSTERY.....	29
SOFT EDGE 100 LOUNGE .....	30
SOFT EDGE 100 LOUNGE WITH UPHOLSTERY.....	31
TABURETE 8 BAR STOOL.....	37
TRIANGLE LEG BENCH .....	48
TRIANGLE LEG TABLE .....	49
X-LINE CHAIR.....	55
X-LINE CHAIR TROLLEY .....	56



ARBOUR ECO

STEP 1  
Remove the cushions

STEP 2  
Turn the sofa upside down and separate the base from the frame by unscrewing all the screws

STEP 3  
Remove the webbing base by lifting it up

STEP 4  
Unscrew all the screws to remove the steel profile and the wood profile from the frame

DISASSEMBLY

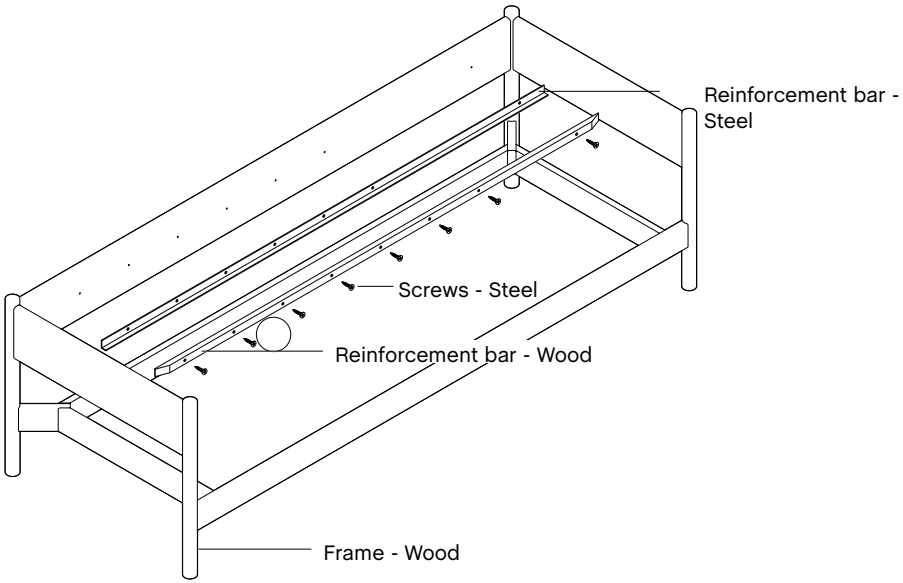
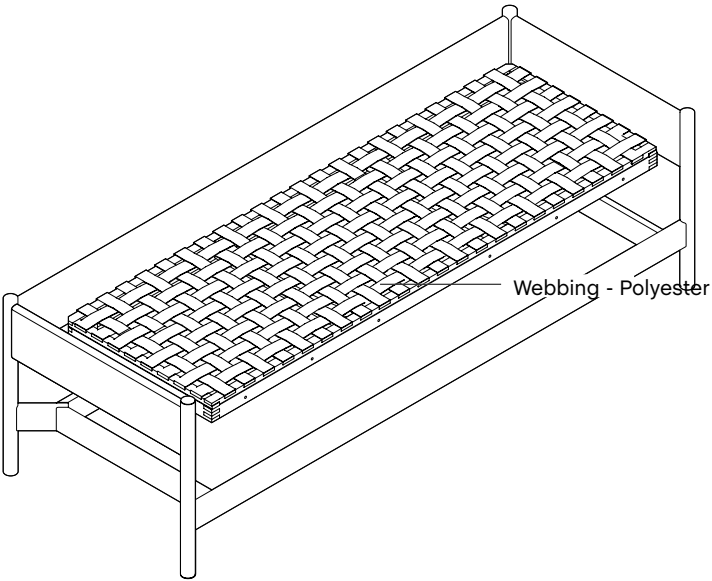
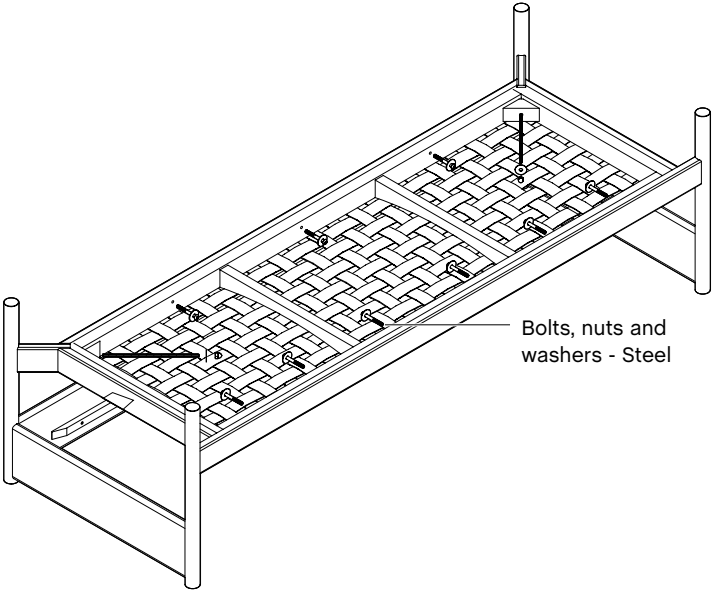
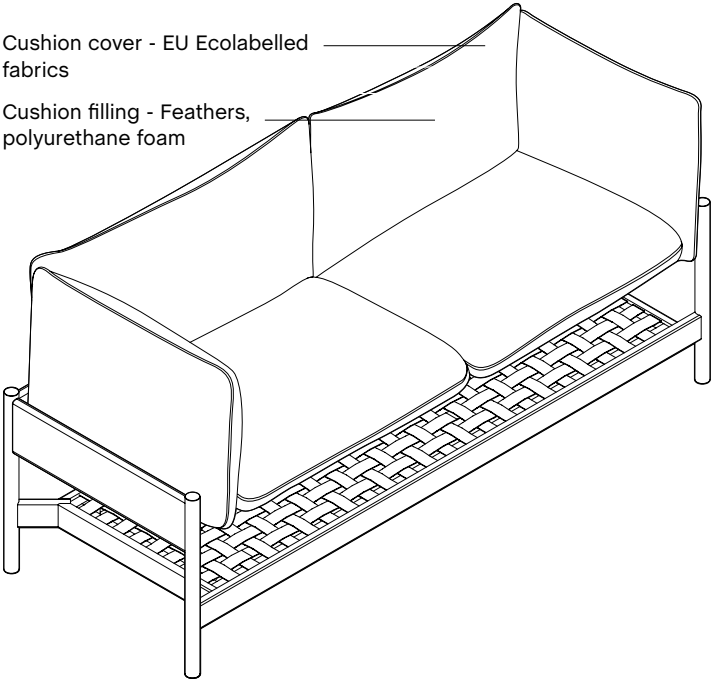



CHISEL LOUNGE CHAIR

STEP 1  
Remove fabric and foam from the frame

---

DISASSEMBLY

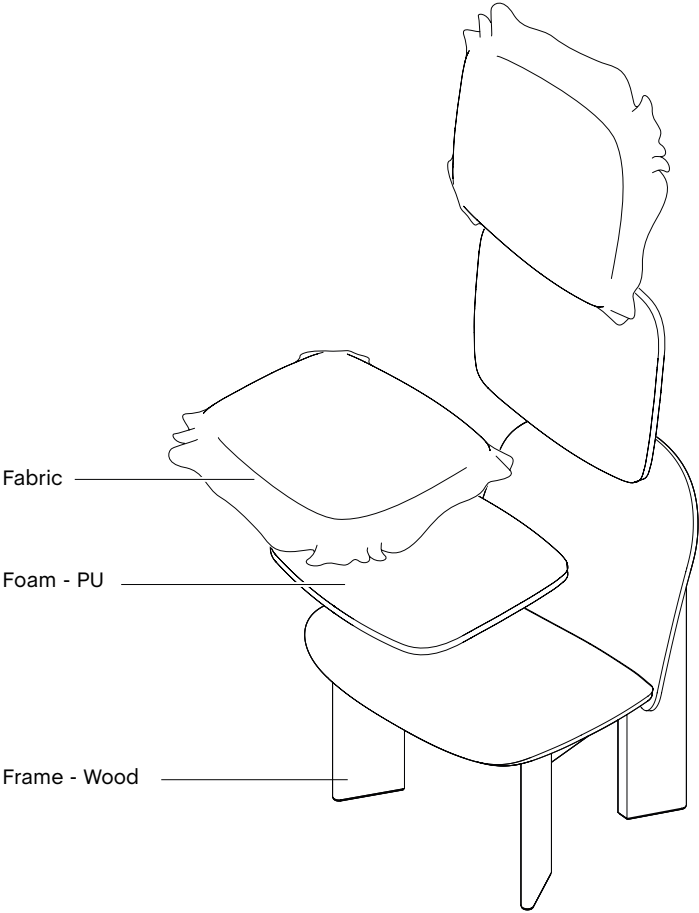





AAC 08

STEP 1  
Turn the chair upside down

STEP 2  
Remove all the bushings from the bottom of the seat

STEP 3  
Remove the gliders from the legs

STEP 4  
Separate the base from the seat

DISASSEMBLY

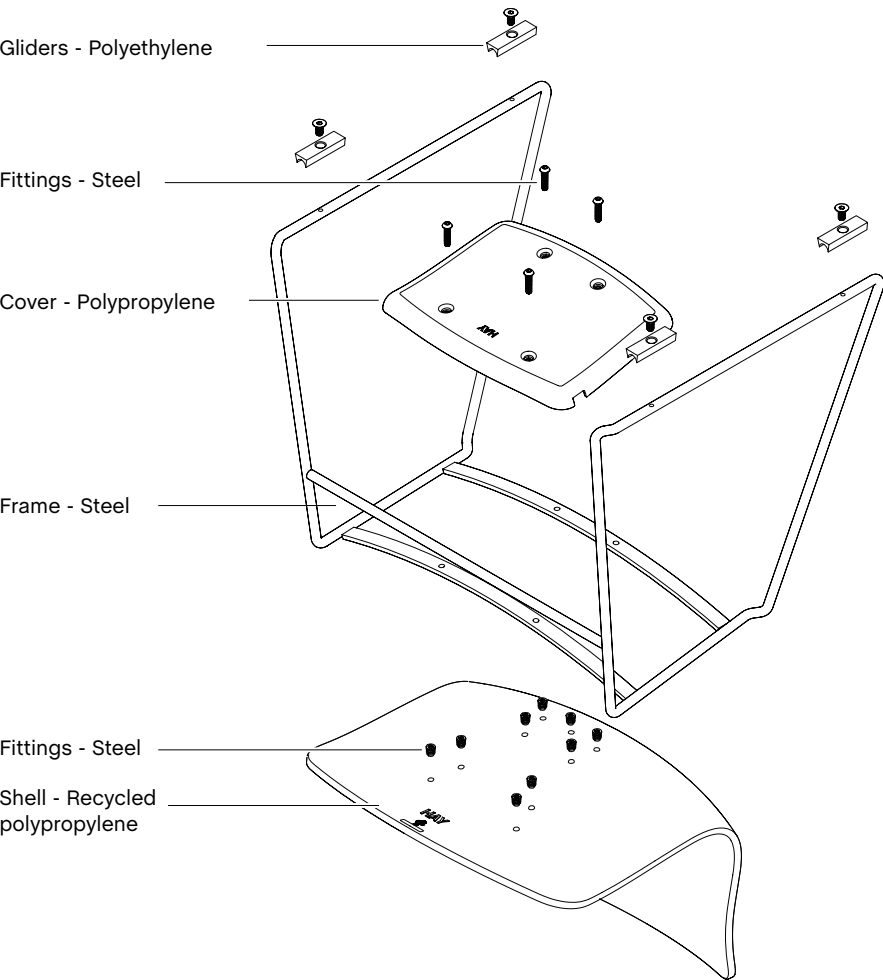



AAC 12

STEP 1  
Turn the chair upside down

---

STEP 2  
Remove all the bushings from the bottom of the seat

---

STEP 3  
Remove the gliders from the legs

---

STEP 4  
Separate the base from the seat

---

DISASSEMBLY

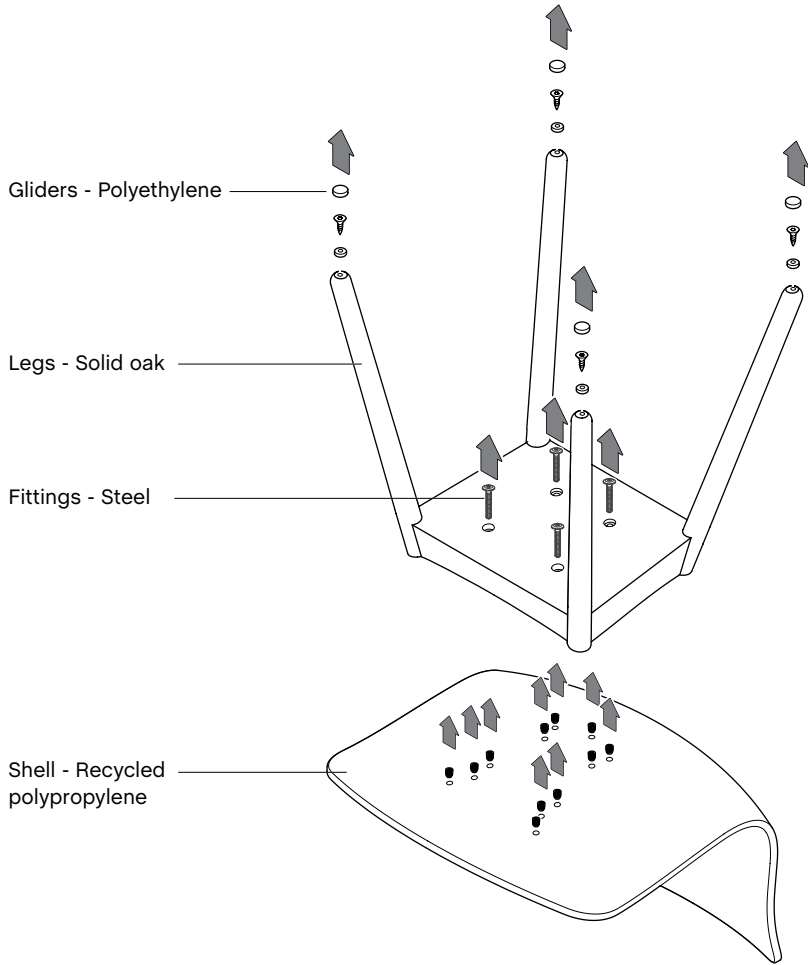



AAC 14

STEP 1  
Turn the chair upside down

---

STEP 2  
Remove all the bushings from the bottom of the seat

---

STEP 3  
Remove the wheels from the legs

---

STEP 4  
Separate the base from the seat

---

DISASSEMBLY

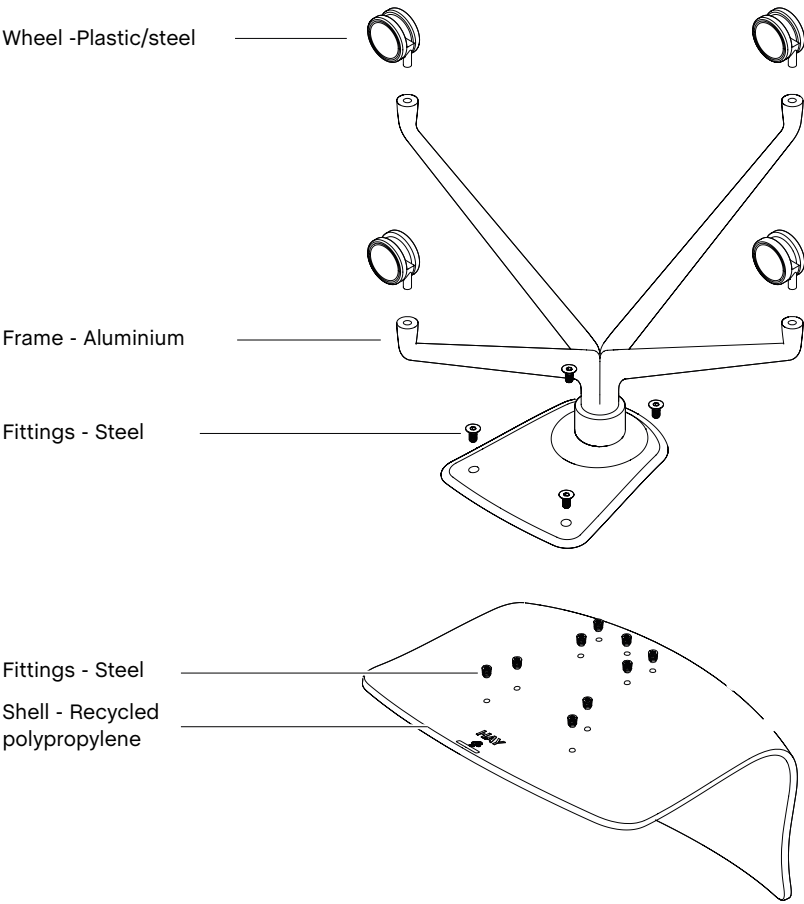



AAC 16

STEP 1  
Turn the chair upside down

STEP 2  
Remove all the bushings from the bottom of the seat

STEP 3  
Remove the gliders from the legs

STEP 4  
Separate the base from the seat

DISASSEMBLY

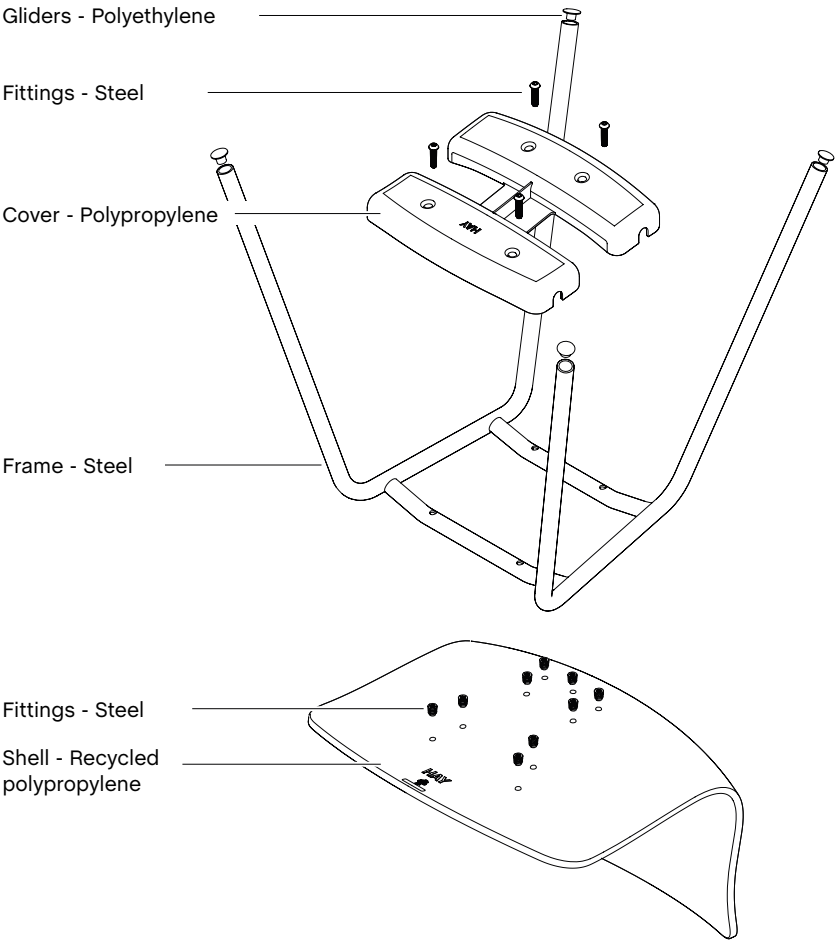



AAC 18

STEP 1  
Turn the chair upside down

STEP 2  
Remove all the bushings from the bottom of the seat

STEP 3  
Remove the gliders from the legs

STEP 4  
Separate the base from the seat

DISASSEMBLY

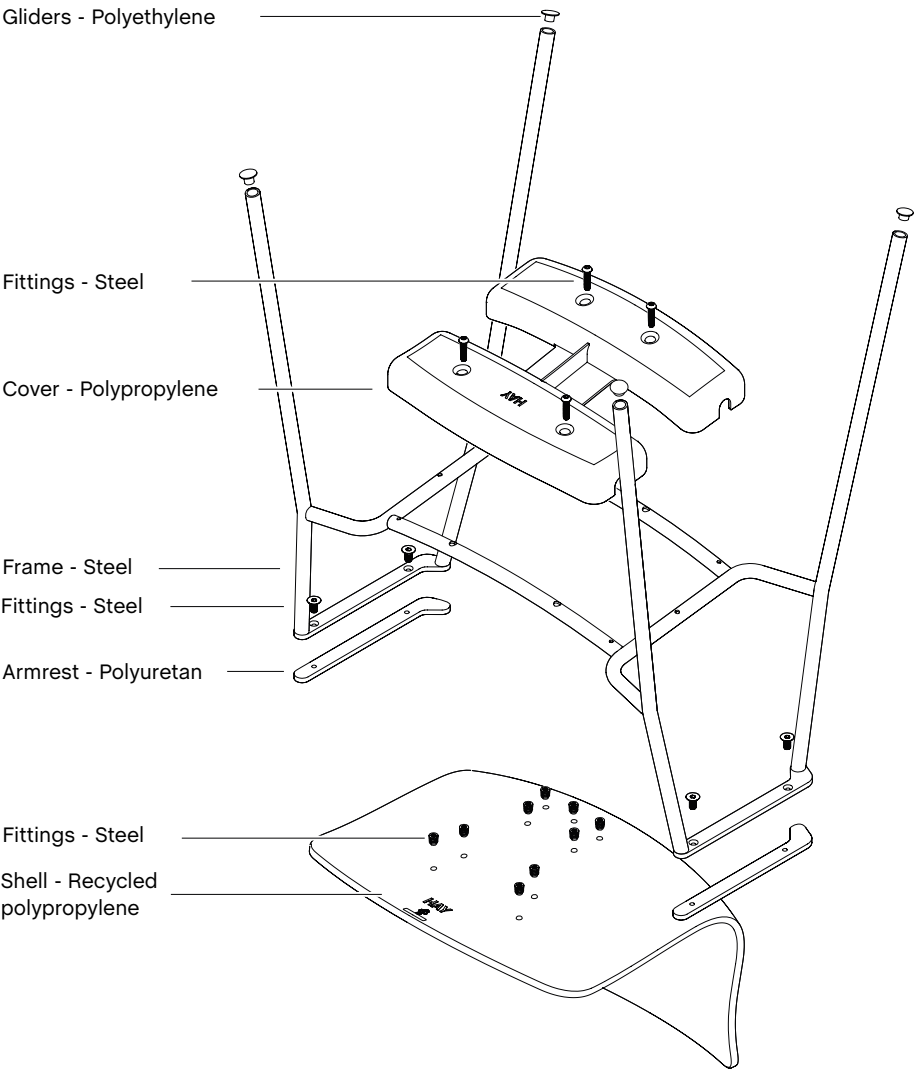



AAC 20

STEP 1  
Turn the chair upside down

---

STEP 2  
Remove all the bushings from the bottom of the seat

---

STEP 3  
Remove the gliders from the legs

---

STEP 4  
Separate the base from the seat

---

DISASSEMBLY

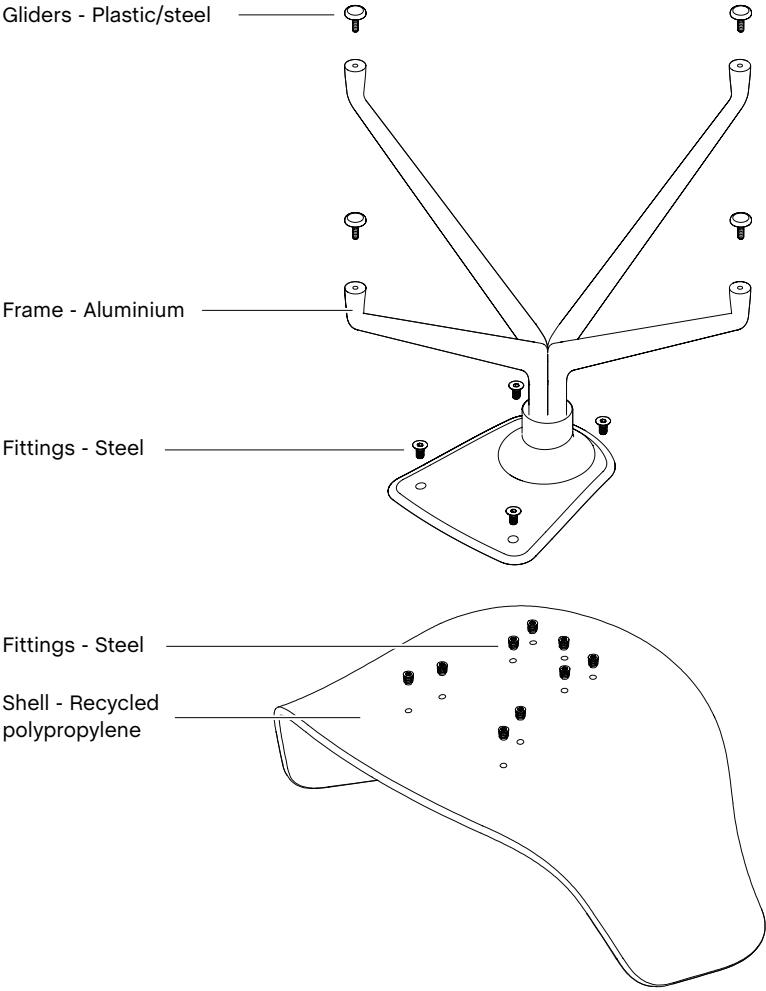



AAC 22

STEP 1  
Turn the chair upside down

STEP 2  
Remove all the bushings from the bottom of the seat

STEP 3  
Remove the gliders from the legs

STEP 4  
Separate the base from the seat

DISASSEMBLY

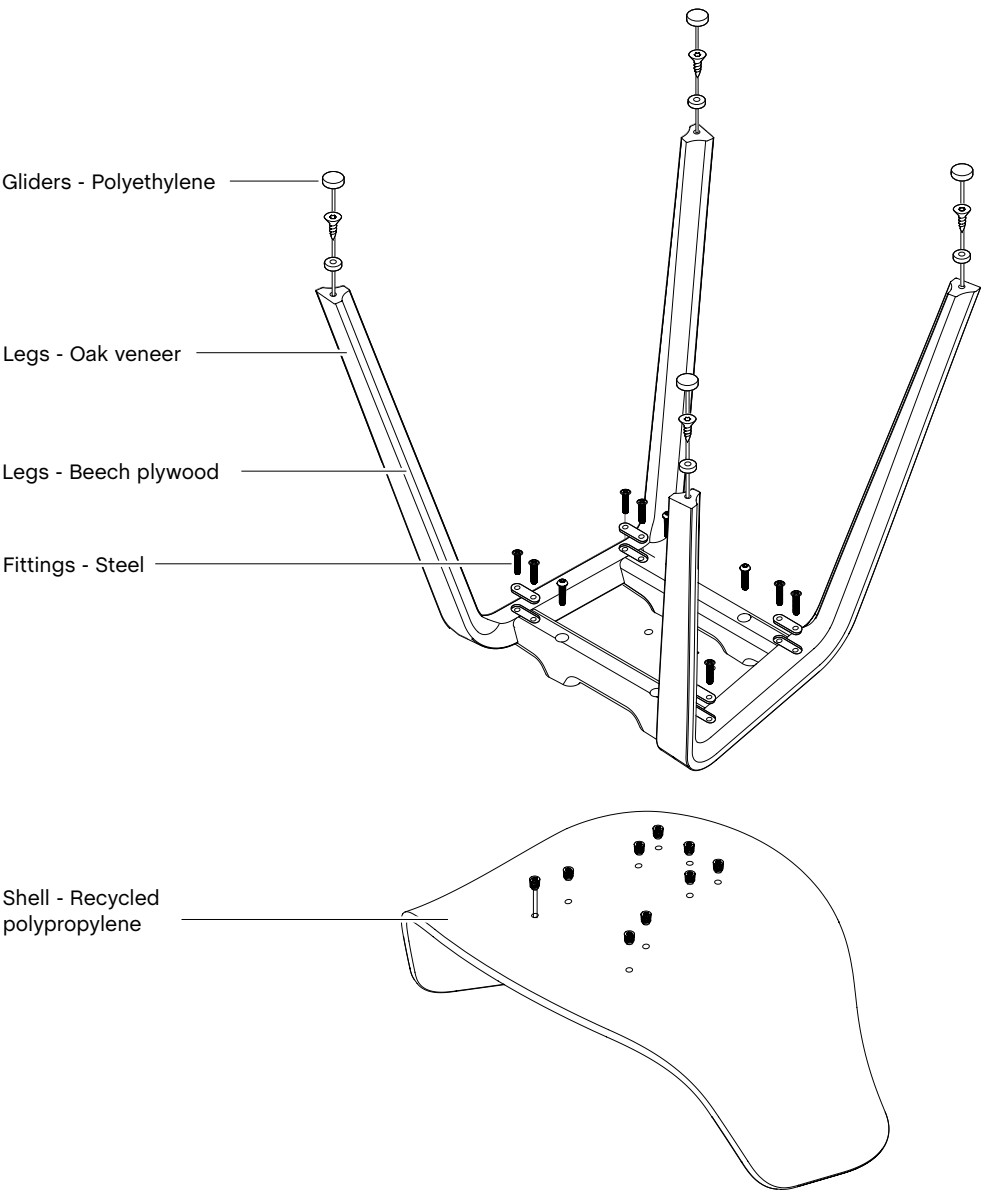



AAC 24

STEP 1  
Turn the chair upside down

STEP 2  
Remove all the bushings from the bottom of the seat

STEP 3  
Remove the wheels from the legs

STEP 4  
Separate the base from the seat

DISASSEMBLY

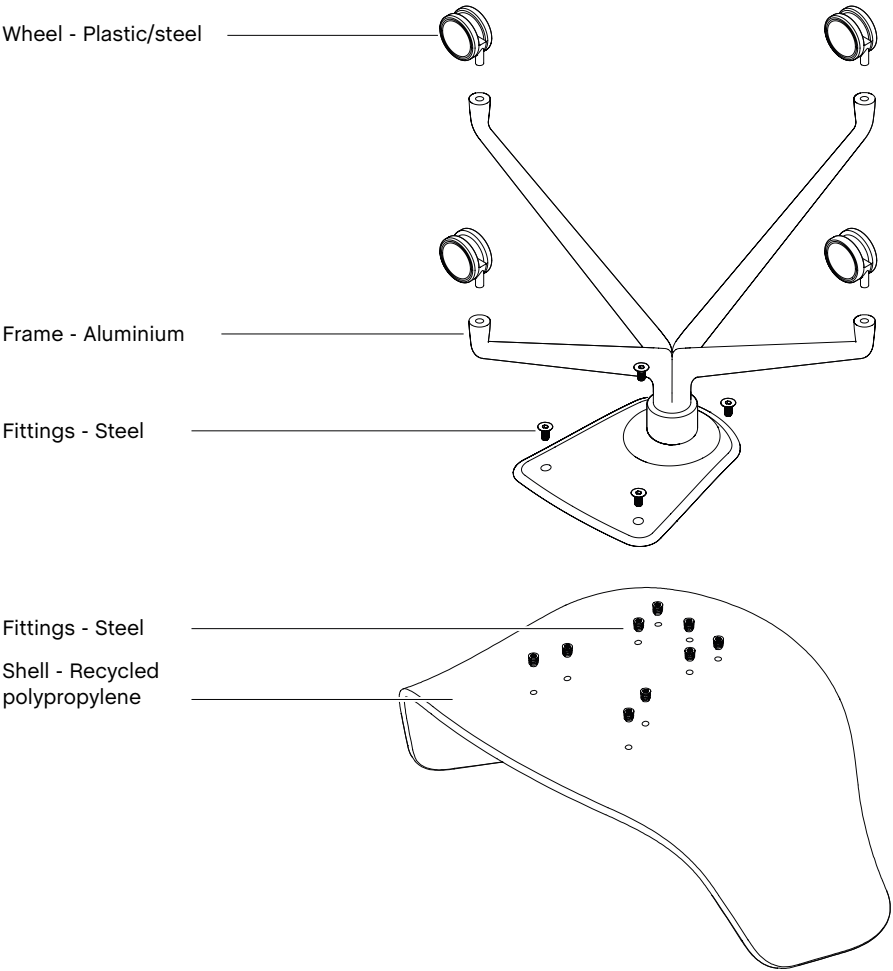





AAC 26

STEP 1  
Turn the chair upside down

STEP 2  
Remove all the bushings from the bottom of the seat

STEP 3  
Remove the gliders from the legs

STEP 4  
Separate the base from the seat

DISASSEMBLY

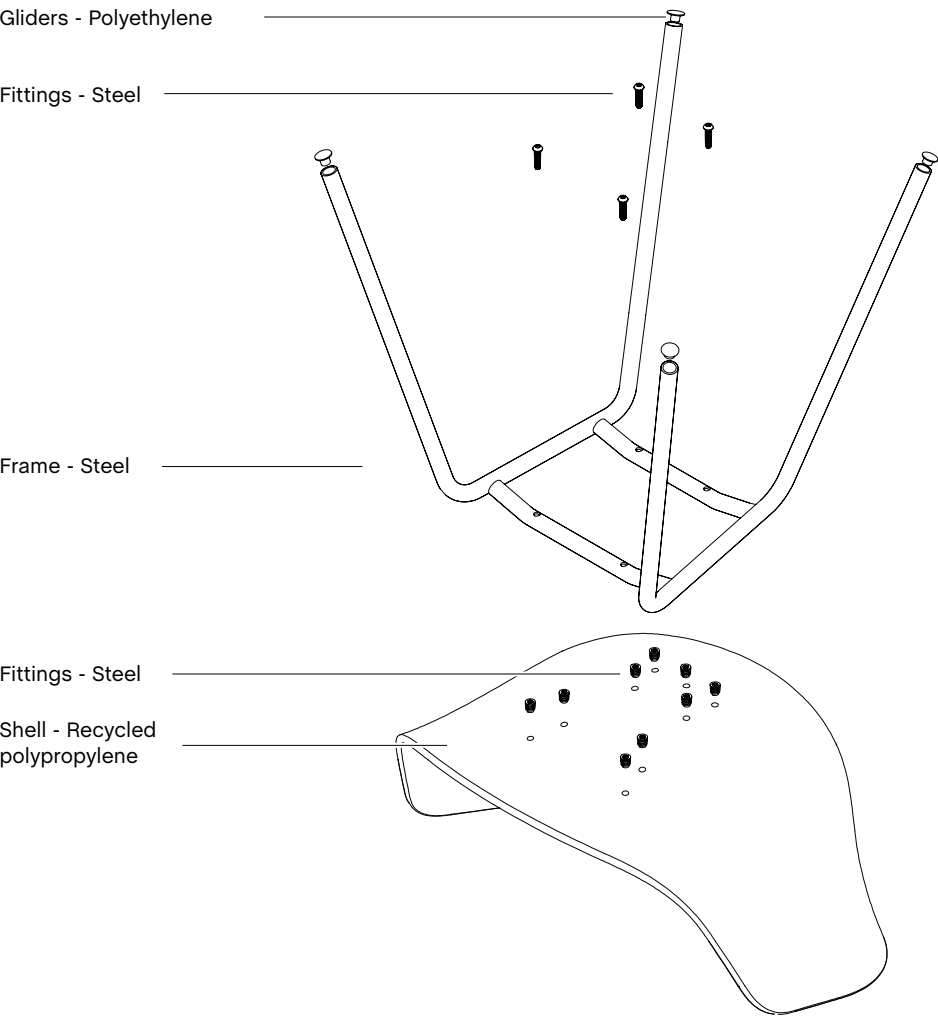



AAC 50

STEP 1  
Turn the chair upside down

STEP 2  
Remove all the bushings from the bottom of the seat

STEP 3  
Remove the wheels from the legs

STEP 4  
Separate the base from the seat

DISASSEMBLY

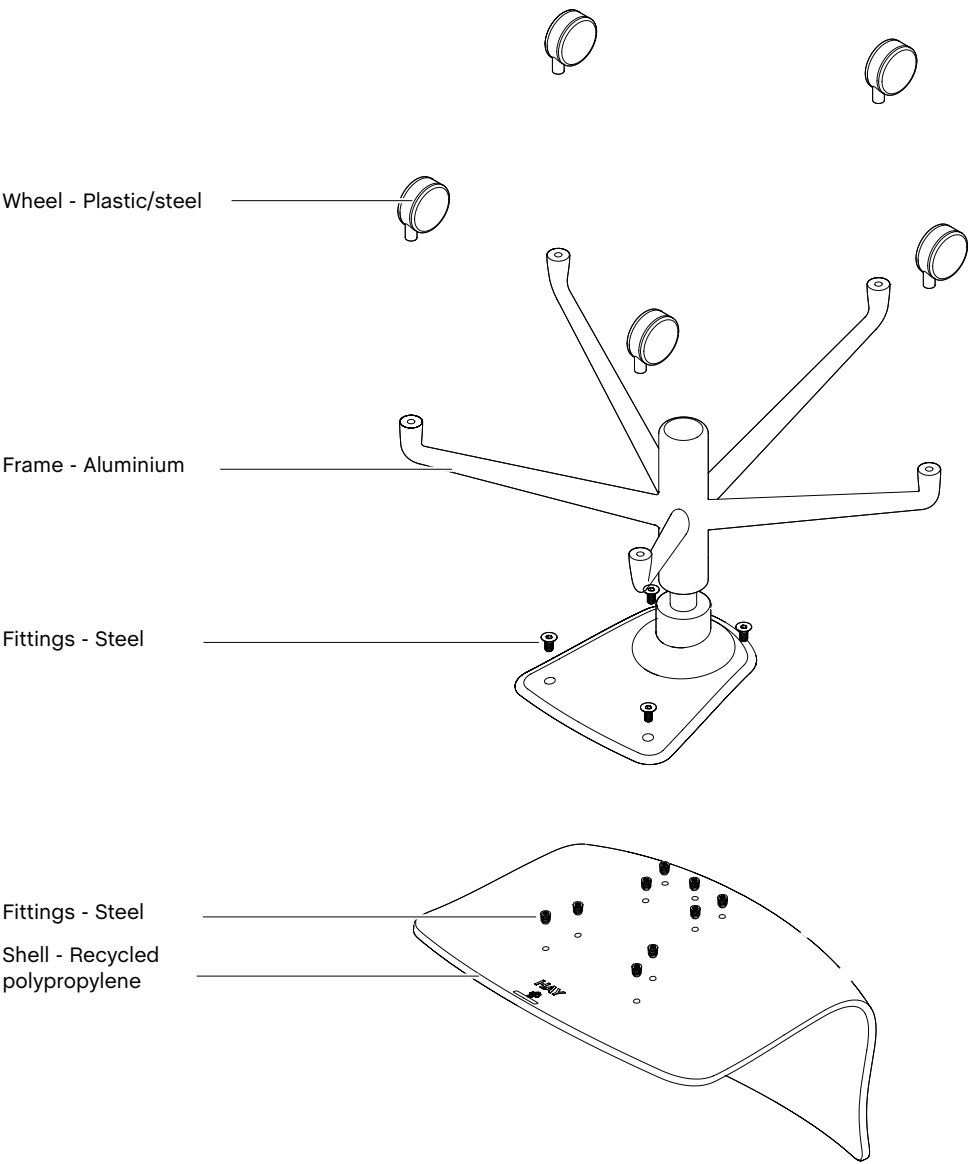



AAC 52

STEP 1  
Turn the chair upside down

STEP 2  
Remove all the bushings from the bottom of the seat

STEP 3  
Remove the wheels from the legs

STEP 4  
Separate the base from the seat

DISASSEMBLY

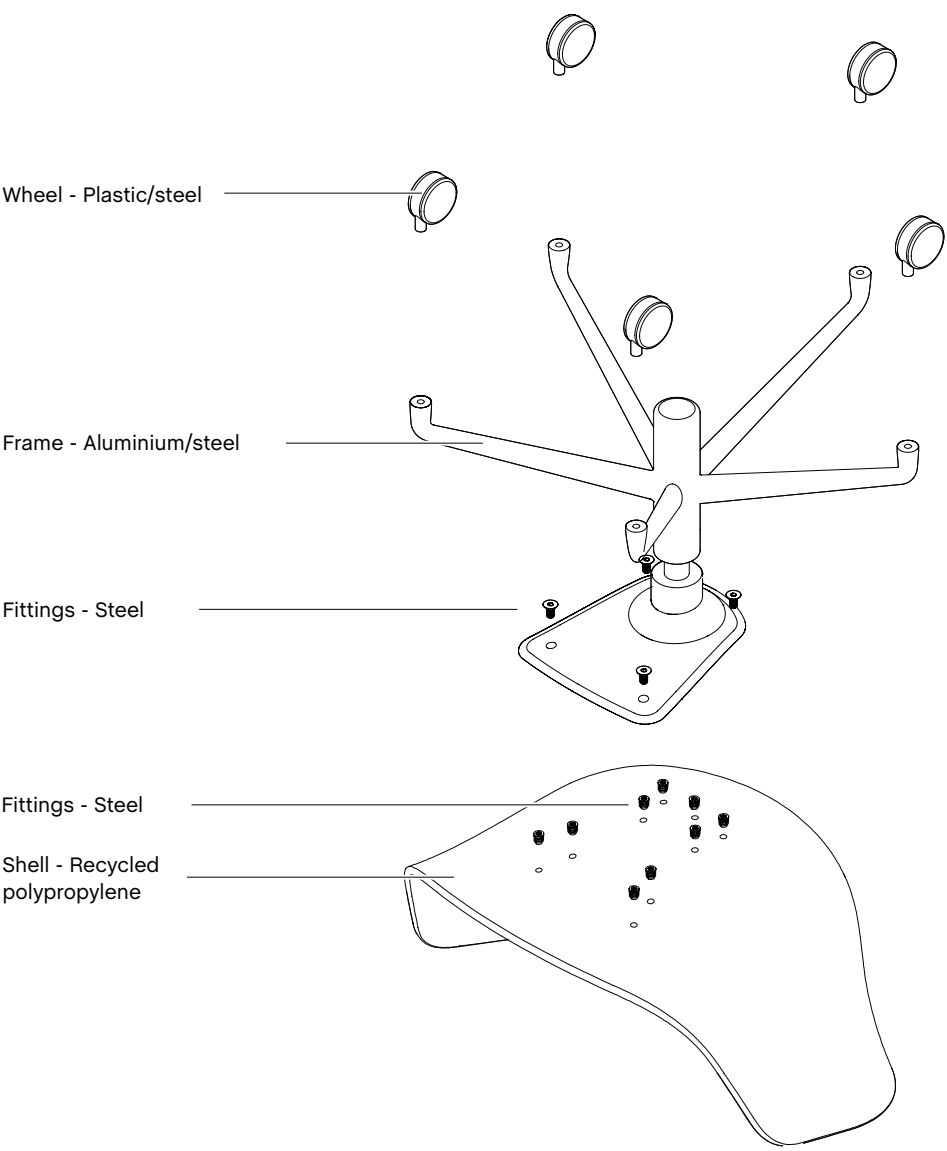



AAS 32

STEP 1  
Turn the barstool upside down

STEP 2  
Remove all the bushings from the bottom of the seat

STEP 3  
Remove the gliders and the footrest from the legs

STEP 4  
Separate the base from the seat

DISASSEMBLY

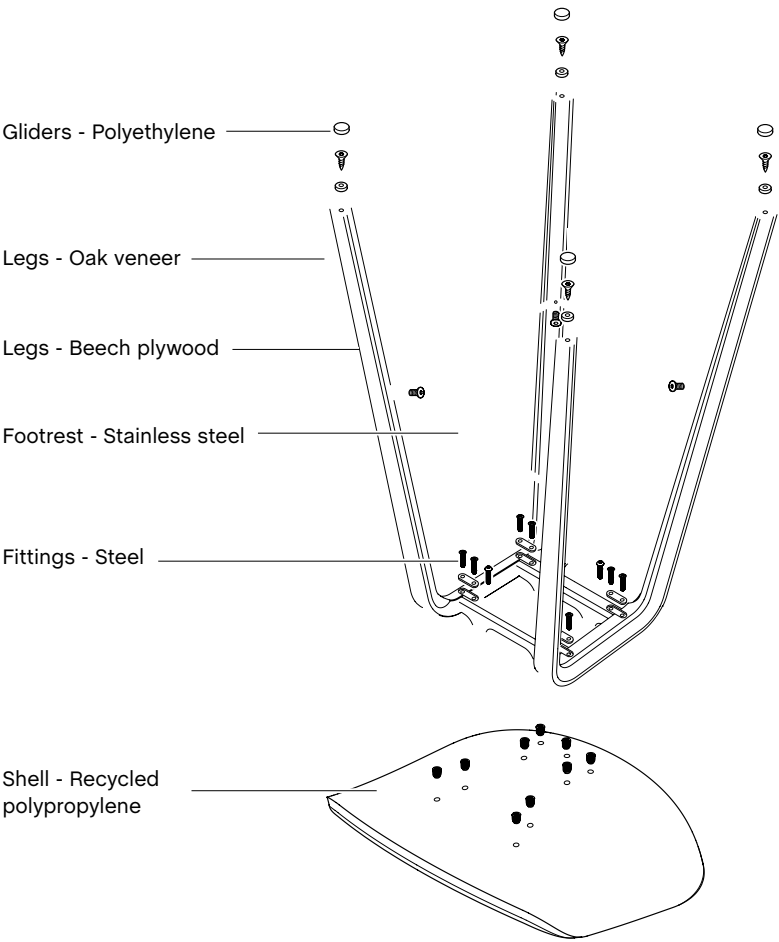



**AAS 38**

STEP 1  
Turn the barstool upside down

STEP 2  
Remove all the bushings from the bottom of the seat

STEP 3  
Remove the gliders and the footrest from the legs

STEP 4  
Separate the base from the seat

**DISASSEMBLY**

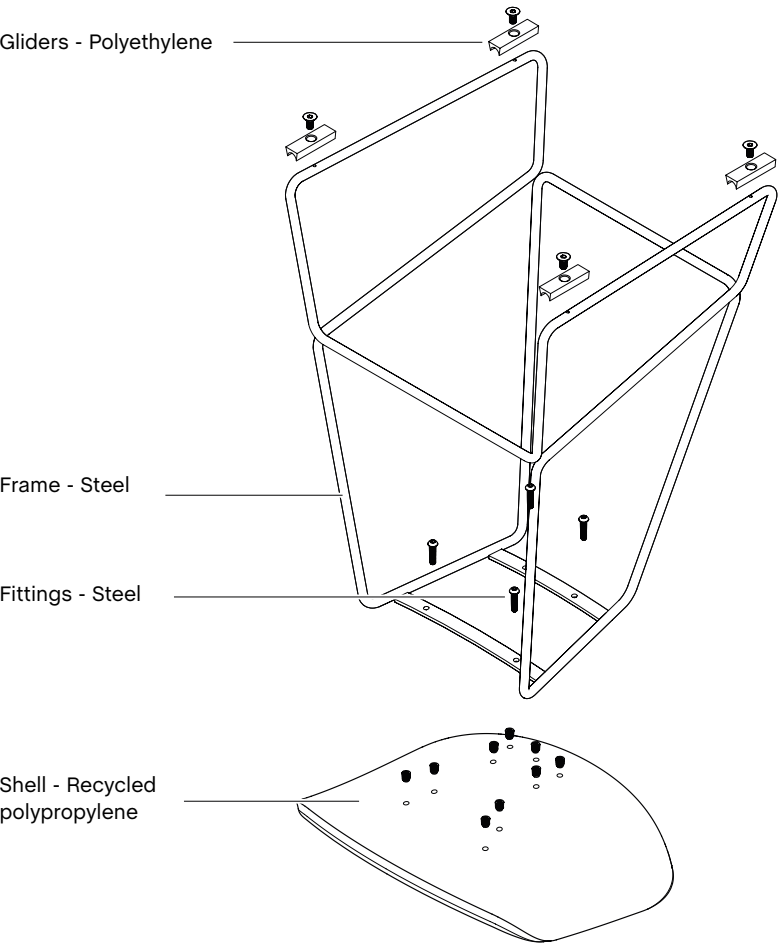



**SOFT EDGE 40 CHAIR**

STEP 1  
Hold the seat and backrest while unscrewing the rivets, using a power drill with a 10 mm bit

STEP 2  
Pull out the gliders from the legs

STEP 3  
Turn the chair upside down and drill out the rivets holding the cover

**DISASSEMBLY**

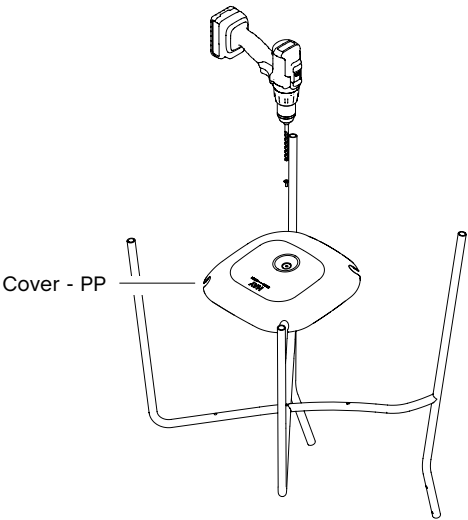
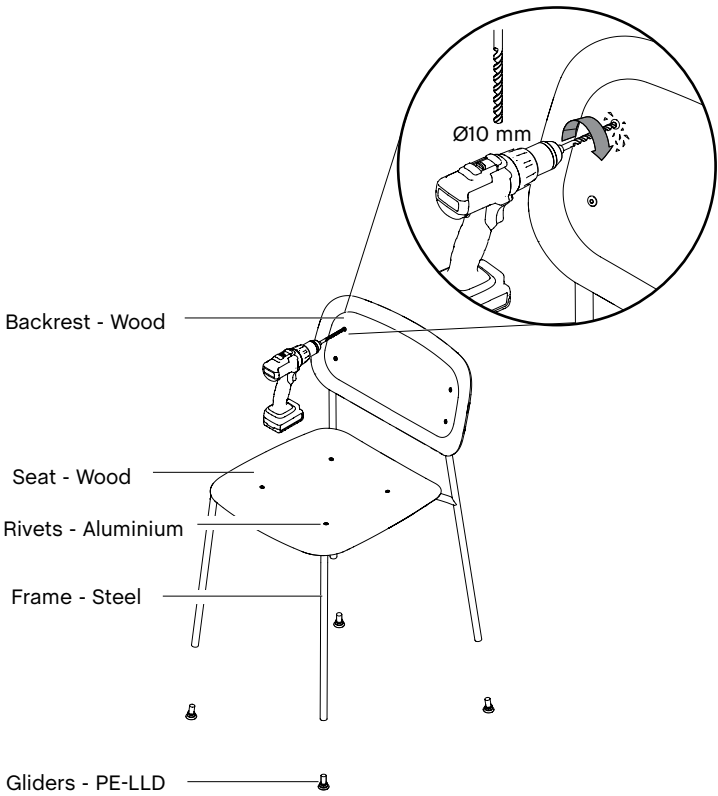



**SOFT EDGE 40 CHAIR WITH UPHOLSTERY**

STEP 1  
Hold the seat and backrest while unscrewing the rivets, using a power drill with a 10 mm bit

STEP 2  
Pull out the gliders from the legs

STEP 3  
Turn the chair upside down and drill out the rivets holding the cover

STEP 4  
Remove the upholstery and the foam from the wooden shell

**DISASSEMBLY**

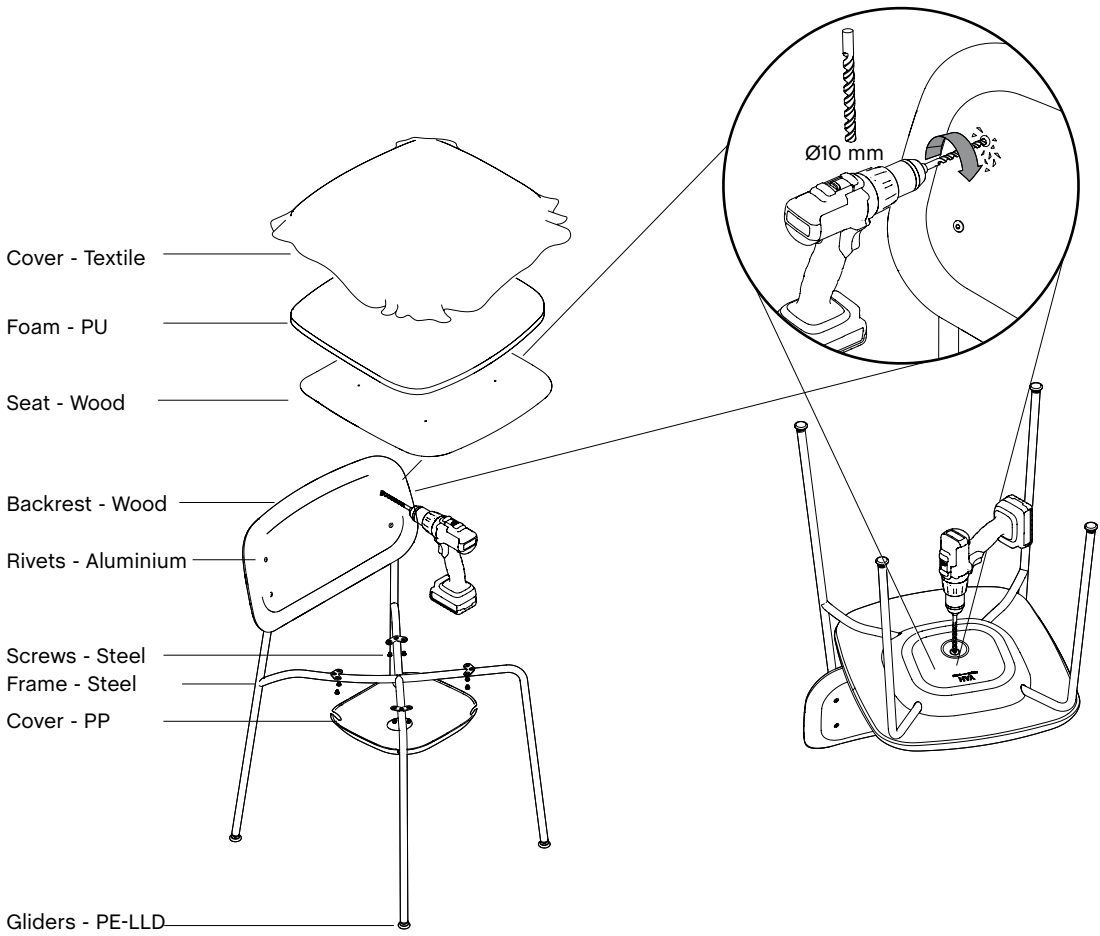



**SOFT EDGE 50 SLED**

STEP 1  
Hold the seat and backrest while unscrewing the rivets, using a power drill with a 10 mm bit

STEP 2  
Unscrew the gliders from the sled legs

STEP 3  
Turn the chair upside down and drill out the rivets holding the cover

**DISASSEMBLY**

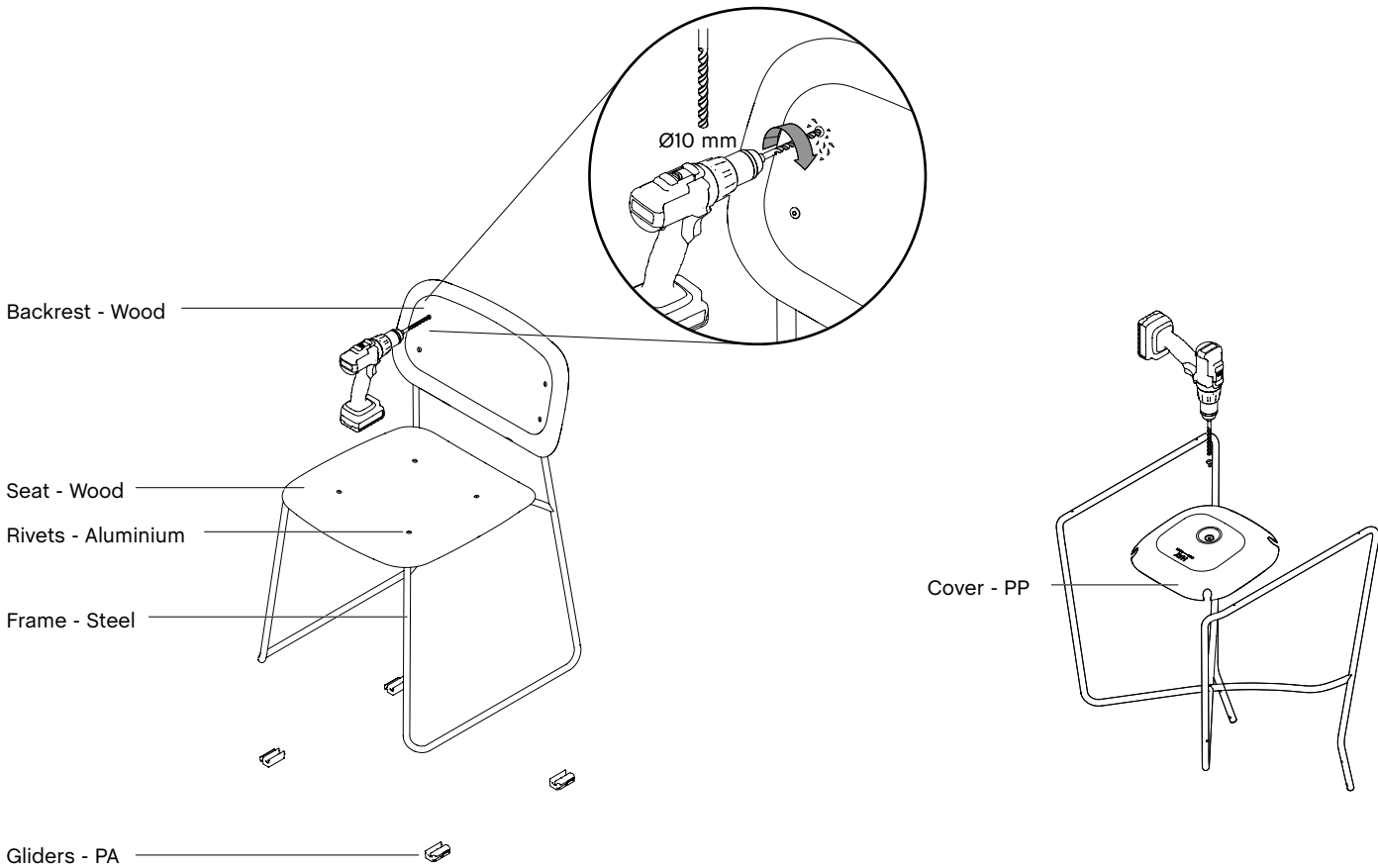





**SOFT EDGE 50 SLED WITH UPHOLSTERY**

STEP 1  
Hold the seat and backrest while unscrewing the rivets, using a power drill with a 10 mm bit

---

STEP 2  
Unscrew the gliders from the sled legs

---

STEP 3  
Turn the chair upside down and drill out the rivets holding the cover

---

STEP 4  
Remove the upholstery and the foam from the wooden shell

---

**DISASSEMBLY**

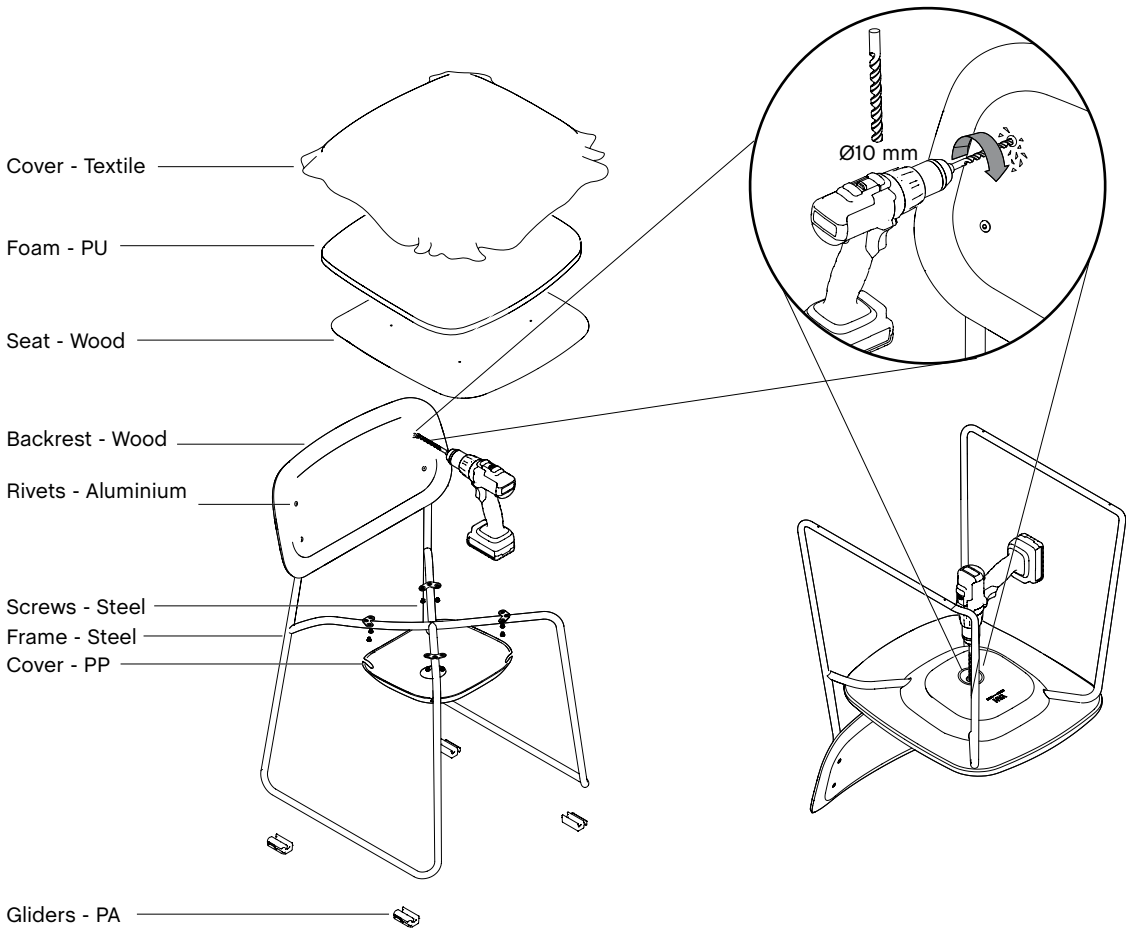



**SOFT EDGE 60 CHAIR**

STEP 1  
Turn the chair upside down

STEP 2  
Remove the cap from the gliders

STEP 3  
Unscrew the screw and remove the gliders' receivers

**DISASSEMBLY**

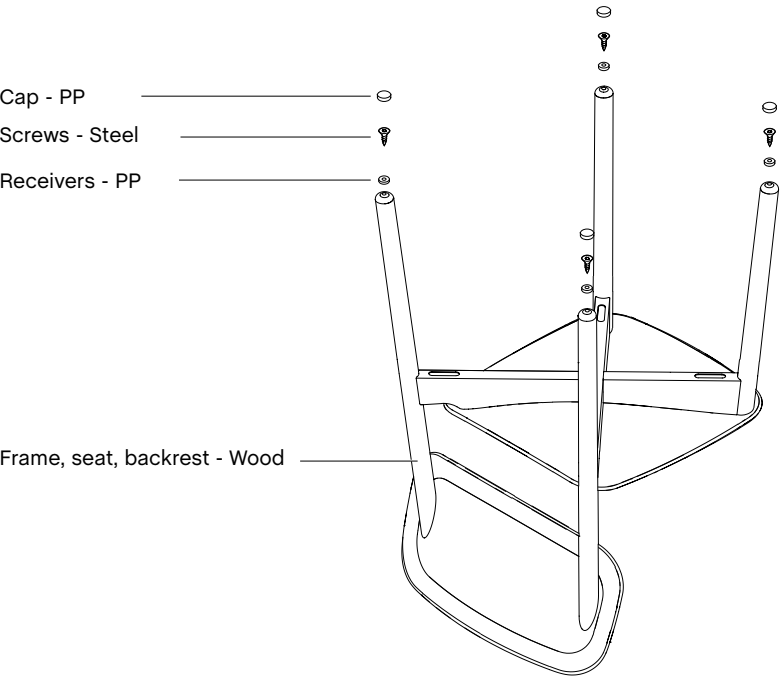



**SOFT EDGE 60 CHAIR WITH UPHOLSTERY**

STEP 1  
Turn the chair upside down

STEP 2  
Remove the cap from the gliders

STEP 3  
Unscrew the screw and remove the gliders' receivers

STEP 4  
Remove the upholstery and the foam from the wooden shell

**DISASSEMBLY**

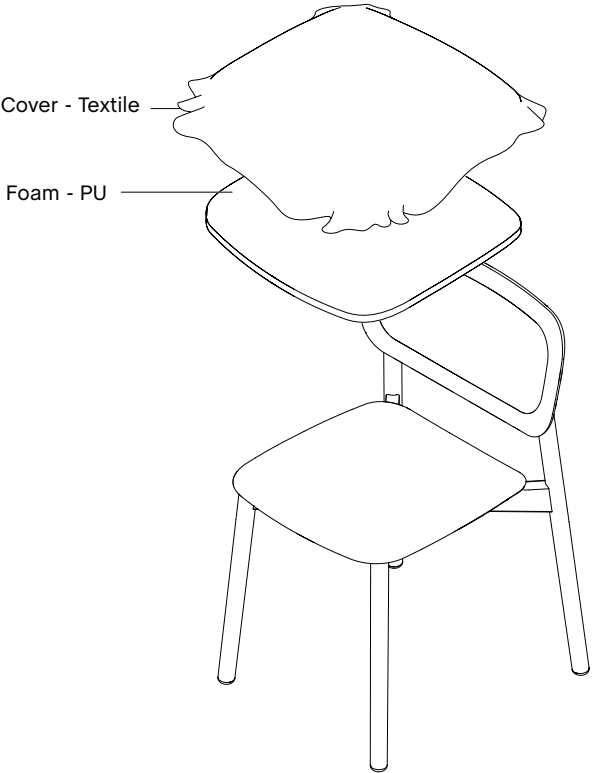
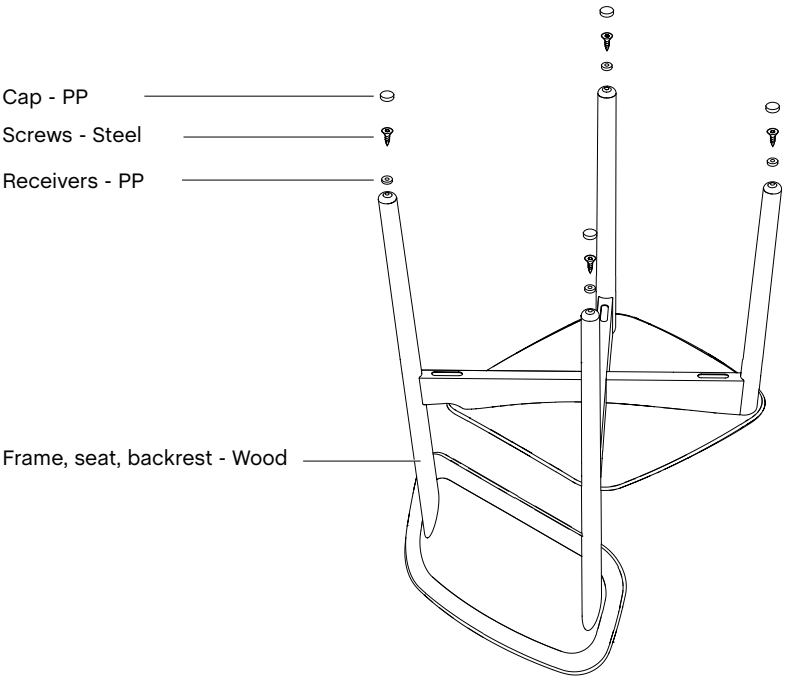



**SOFT EDGE 70 STOOL**

STEP 1  
Hold the seat while unscrewing the rivets, using a power drill with a 10 mm bit

---

STEP 2  
Pull out the gliders from the legs

---

STEP 3  
Turn the chair upside down and drill out the rivets holding the cover

---

**DISASSEMBLY**

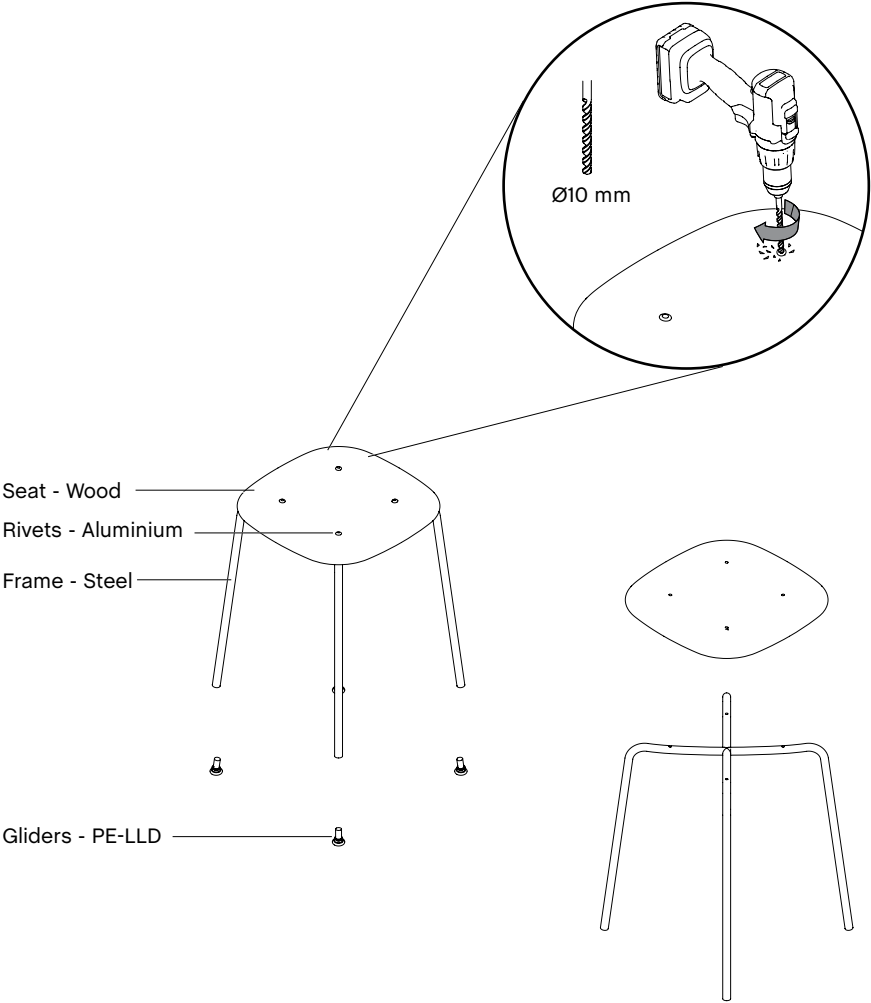



**SOFT EDGE 72 STOOL**

STEP 1  
Turn the stool upside down

---

STEP 2  
Remove the cap from the gliders

---

STEP 3  
Unscrew the screw and remove the gliders' receivers

---

**DISASSEMBLY**

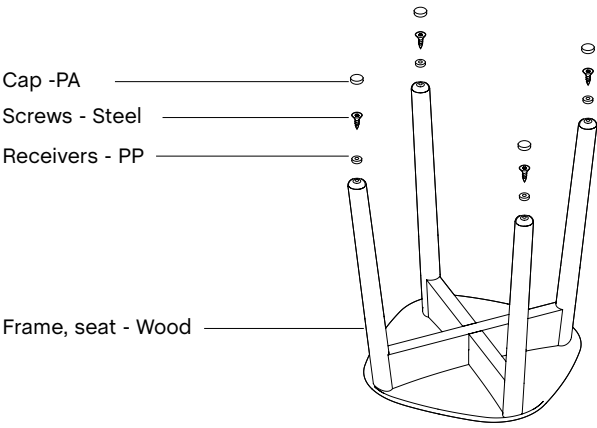



**SOFT EDGE 80 BAR STOOL**

STEP 1  
Hold the seat while unscrewing the rivets, using a power drill with a 10 mm bit

---

STEP 2  
Pull out the gliders from the legs

---

STEP 3  
Turn the stool upside down and drill out the rivets holding the cover

---

**DISASSEMBLY**

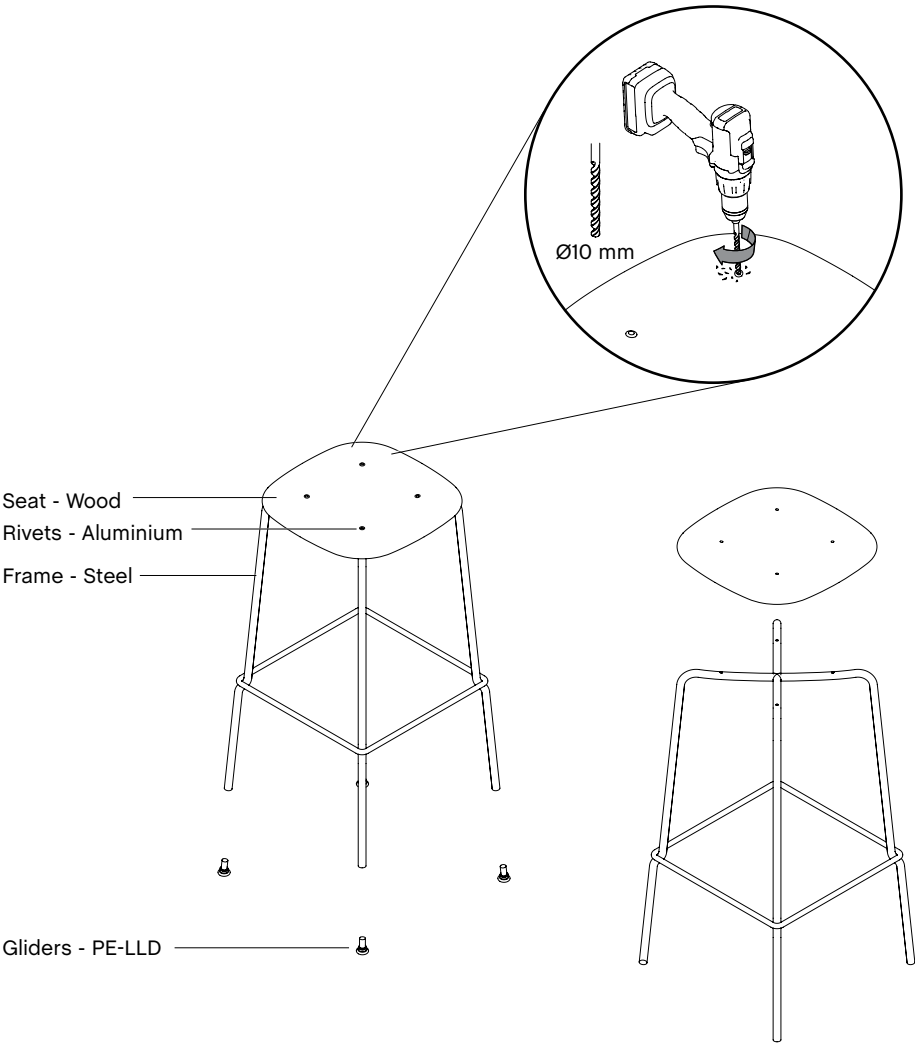



**SOFT EDGE 82 BAR STOOL**

STEP 1  
Turn the bar stool upside down

---

STEP 2  
Remove the cap from the gliders

---

STEP 3  
Unscrew the screw and remove the gliders' receivers

---

STEP 4  
Unscrew the screws holding the footrest and remove it

---

**DISASSEMBLY**

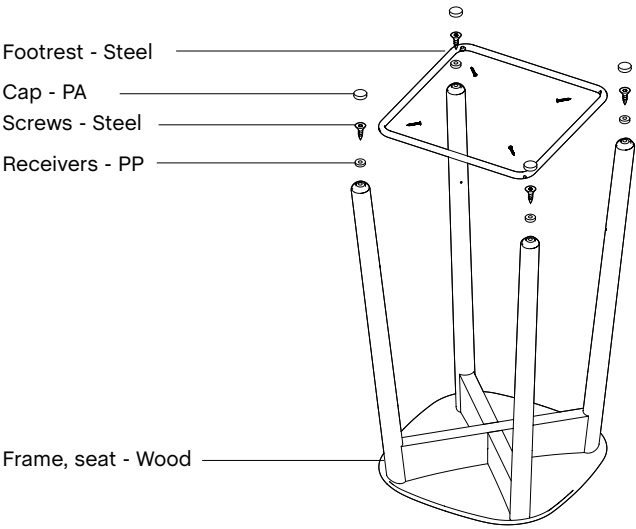



**SOFT EDGE 90 BAR STOOL**

STEP 1  
Hold the seat and backrest while unscrewing the rivets, using a power drill with a 10 mm bit

---

STEP 2  
Pull out the gliders from the legs

---

STEP 3  
Turn the bar stool upside down and drill out the rivets holding the cover

---

**DISASSEMBLY**

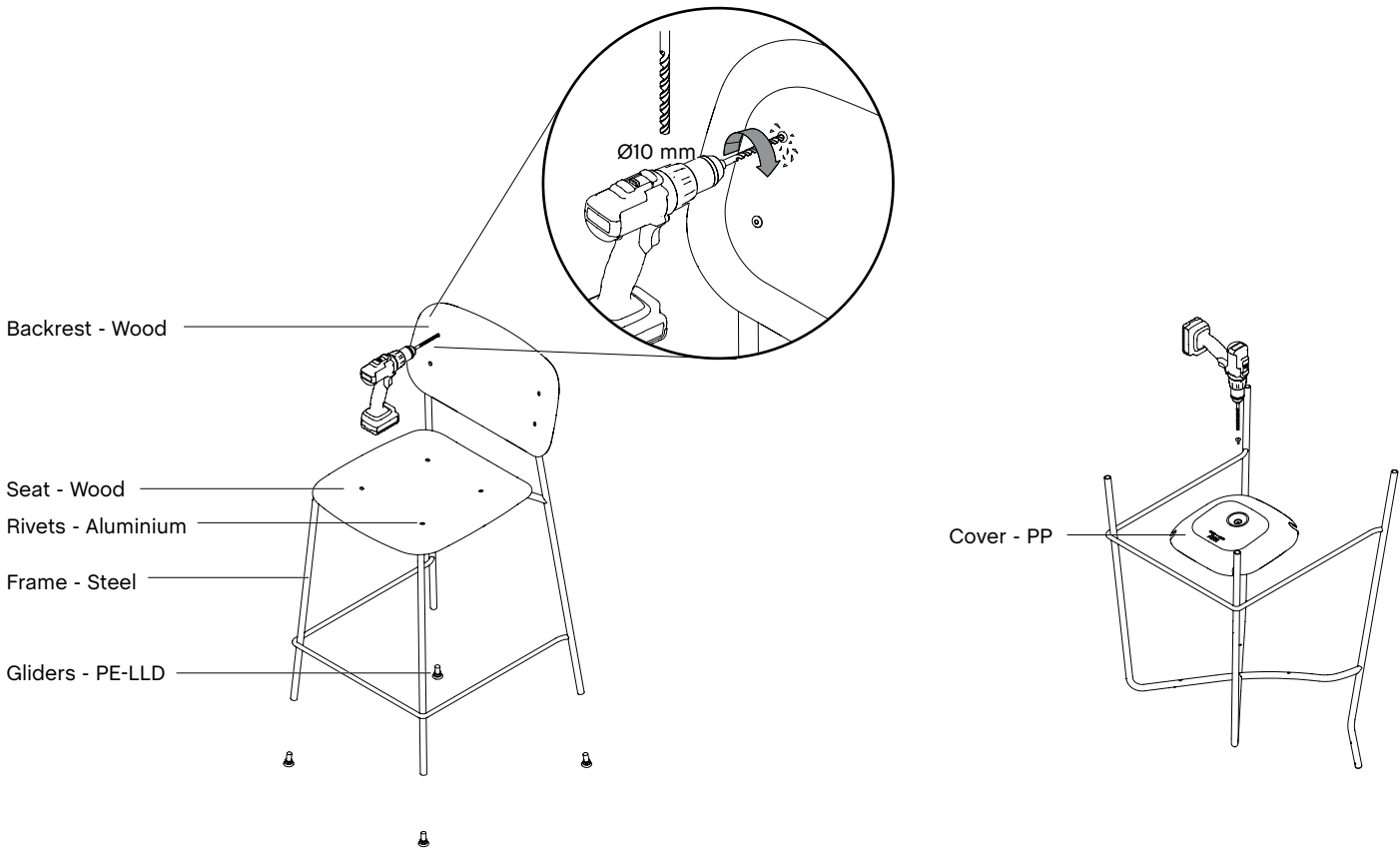





**SOFT EDGE 90 BAR STOOL WITH UPHOLSTERY**

STEP 1  
Hold the seat and backrest while unscrewing the rivets, using a power drill with a 10 mm bit

---

STEP 2  
Pull out the gliders from the legs

---

STEP 3  
Turn the bar stool upside down and drill out the rivets holding the cover

---

STEP 4  
Remove the upholstery and the foam from the wooden shell

---

**DISASSEMBLY**

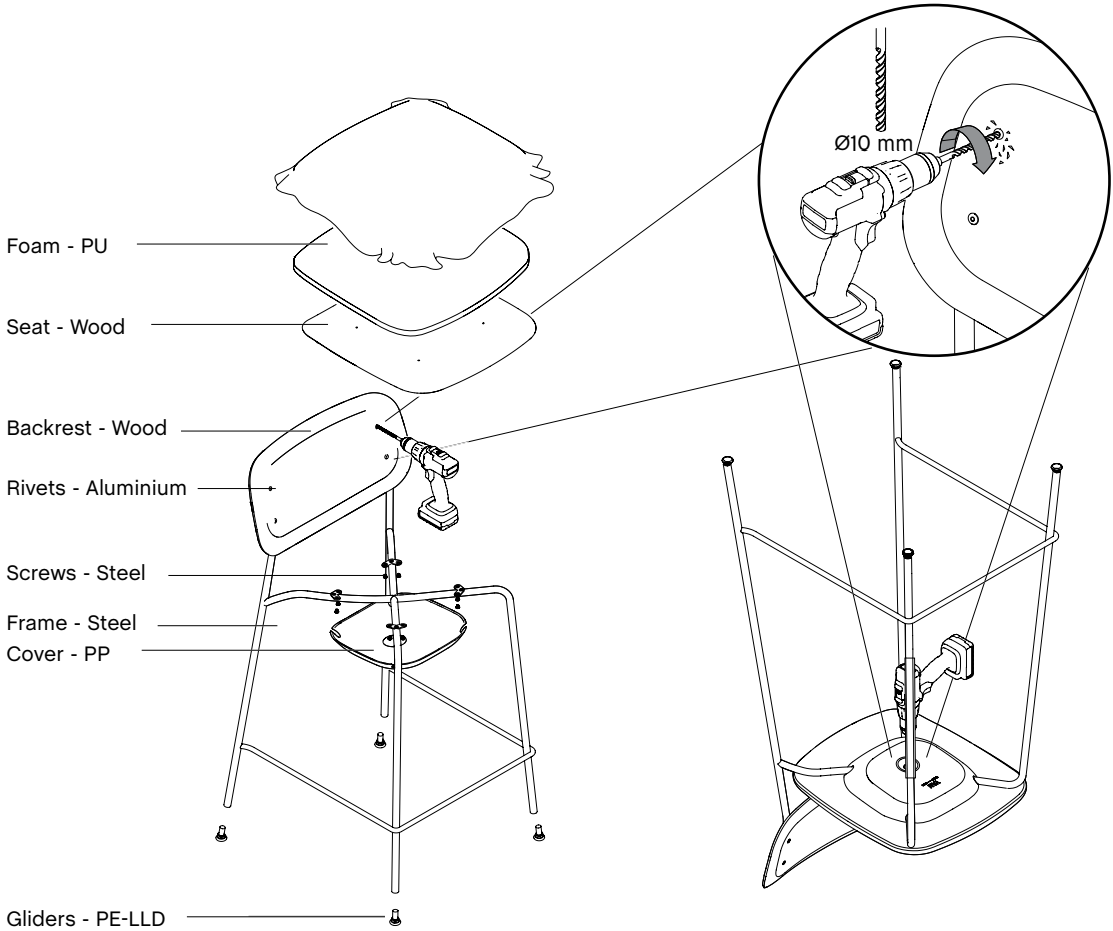



**SOFT EDGE 100 LOUNGE**

STEP 1  
Hold the seat and backrest while unscrewing the rivets, using a power drill with a 10 mm bit

STEP 2  
Pull out the gliders from the legs

STEP 3  
Turn the bar stool upside down and drill out the rivets holding the cover

**DISASSEMBLY**

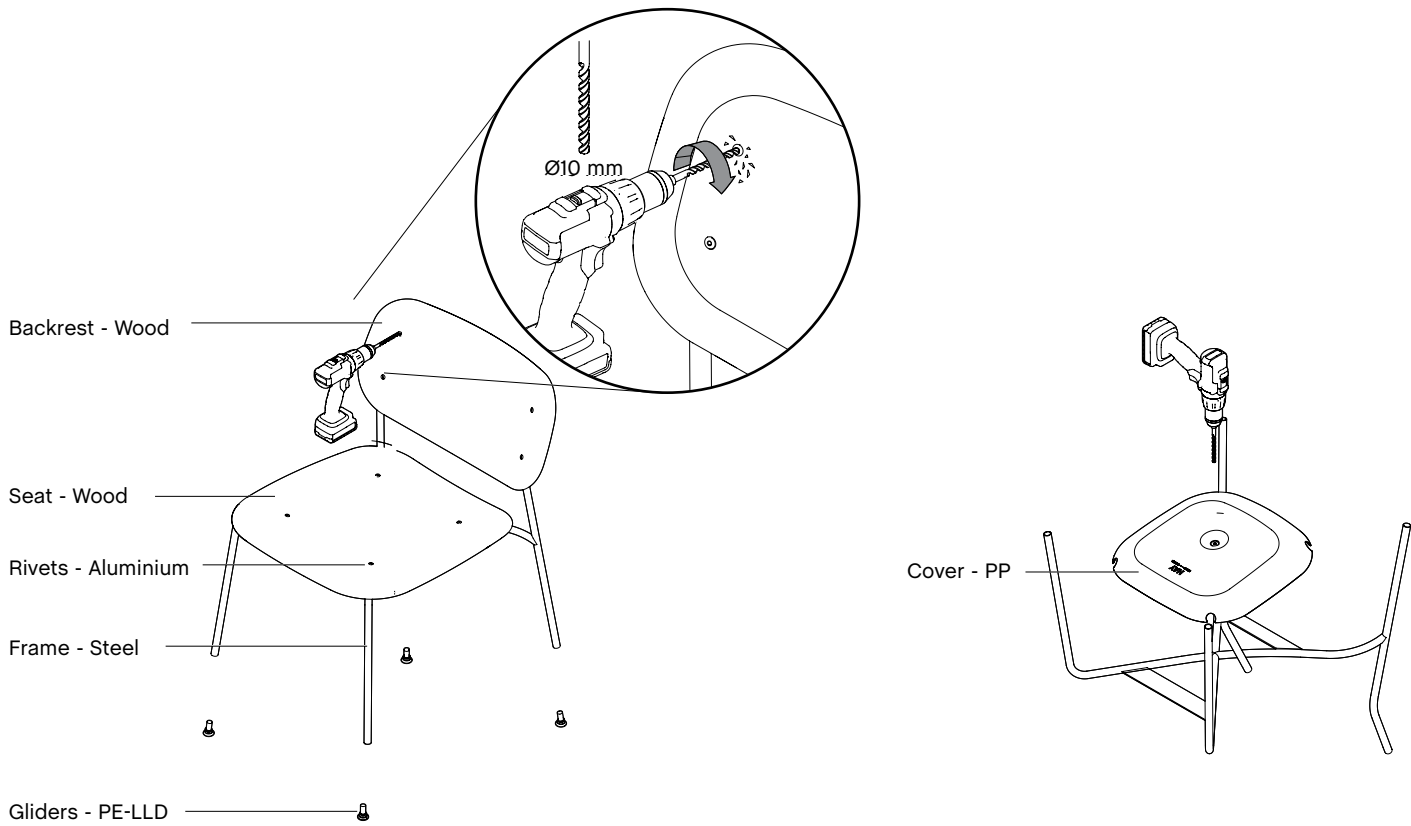



**SOFT EDGE 100 LOUNGE WITH UPHOLSTERY**

STEP 1  
Hold the seat and backrest while unscrewing the rivets, using a power drill with a 10 mm bit

---

STEP 2  
Pull out the gliders from the legs

---

STEP 3  
Turn the bar stool upside down and drill out the rivets holding the cover

---

STEP 4  
Remove the upholstery and the foam from the wooden shell

---

**DISASSEMBLY**

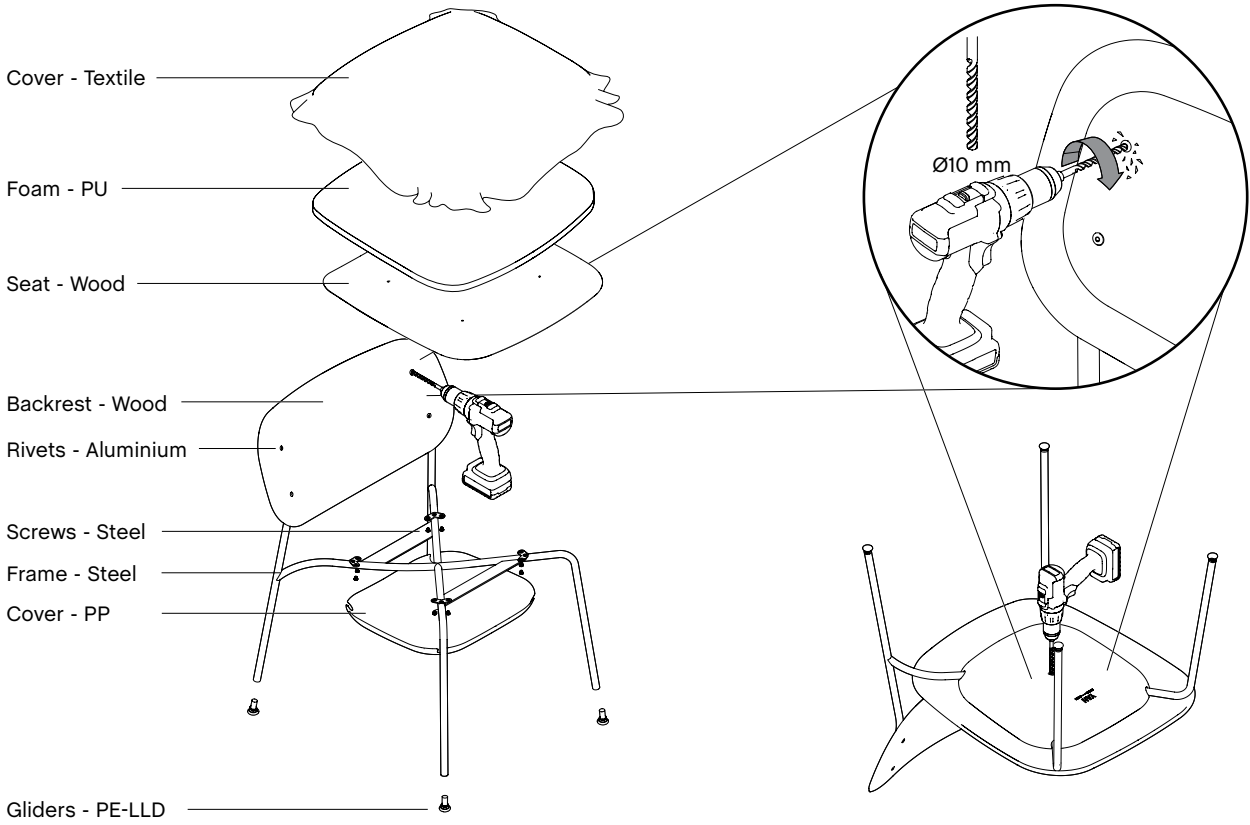



RESULT CHAIR

STEP 1  
Hold the seat and backrest while unscrewing the rivets, using a power drill with a 10 mm bit

STEP 2  
Remove the bumpers from the backrest posts and the gliders from the legs

DISASSEMBLY

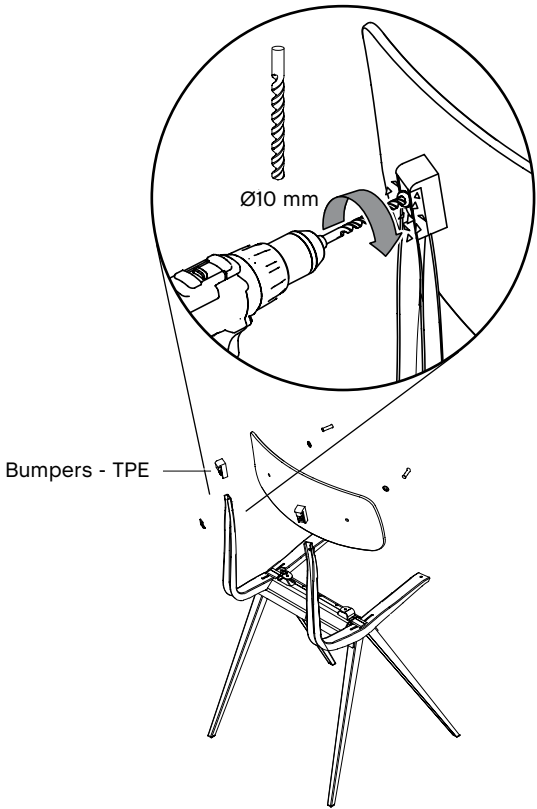
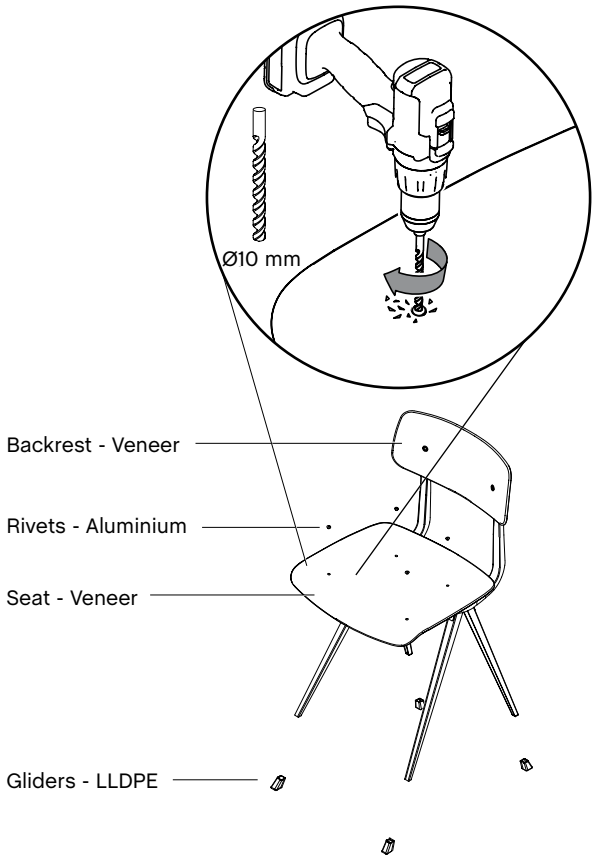



RESULT CHAIR WITH UPHOLSTERY

STEP 1  
Unscrew the screws underneath the seat

STEP 2  
Remove the upholstery and the foam from the wooden shell

STEP 3  
Hold the seat and backrest while unscrewing the rivets, using a power drill with a 10 mm bit

STEP 4  
Remove the bumpers from the backrest posts and the gliders from the legs

DISASSEMBLY

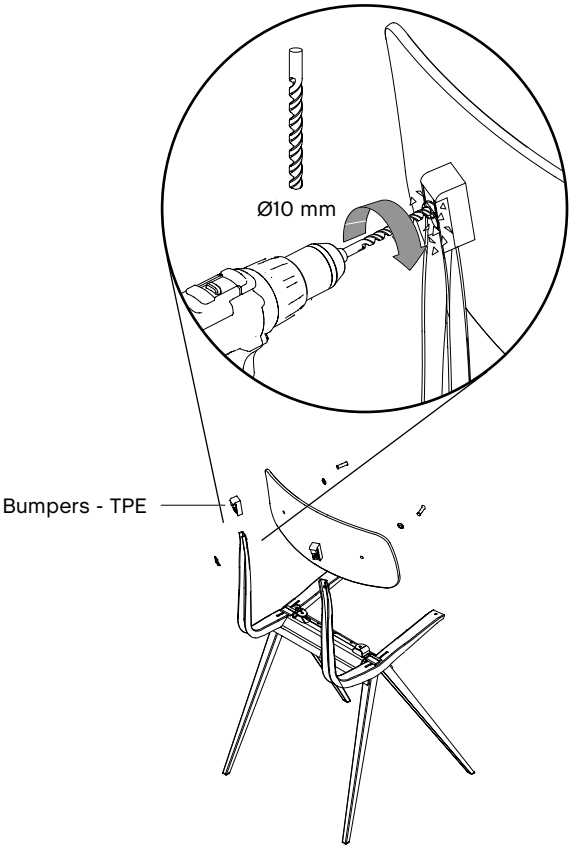
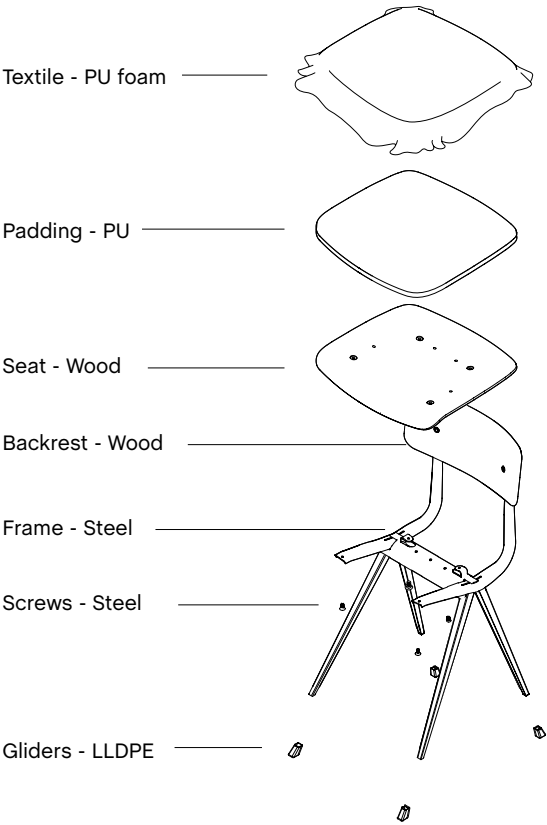



RESULT ARMCHAIR

STEP 1  
Hold the seat and backrest while unscrewing the rivets, using a power drill with a 10 mm bit

STEP 2  
Remove the bumpers from the backrest posts and the gliders from the legs

DISASSEMBLY

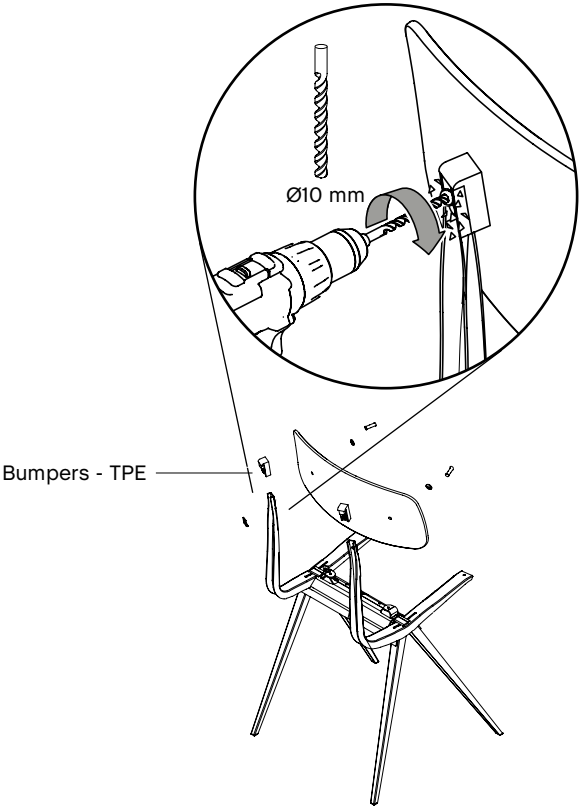
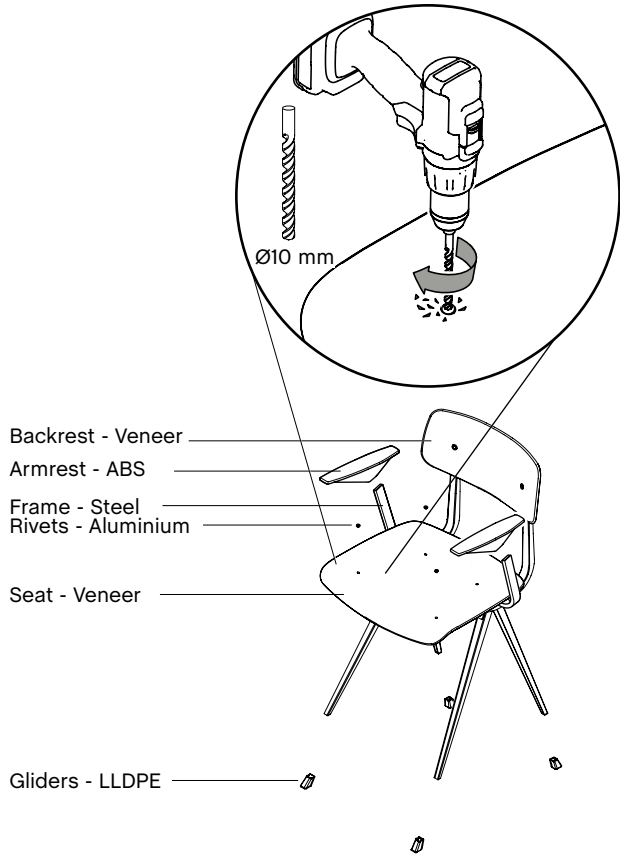



RESULT ARMCHAIR WITH SEAT UPHOLSTERY

STEP 1  
Unscrew the screws underneath the seat

STEP 2  
Remove the upholstery and the foam from the wooden shell

STEP 3  
Hold the seat and backrest while unscrewing the rivets, using a power drill with a 10 mm bit

STEP 4  
Remove the bumpers from the backrest posts and the gliders from the legs

DISASSEMBLY

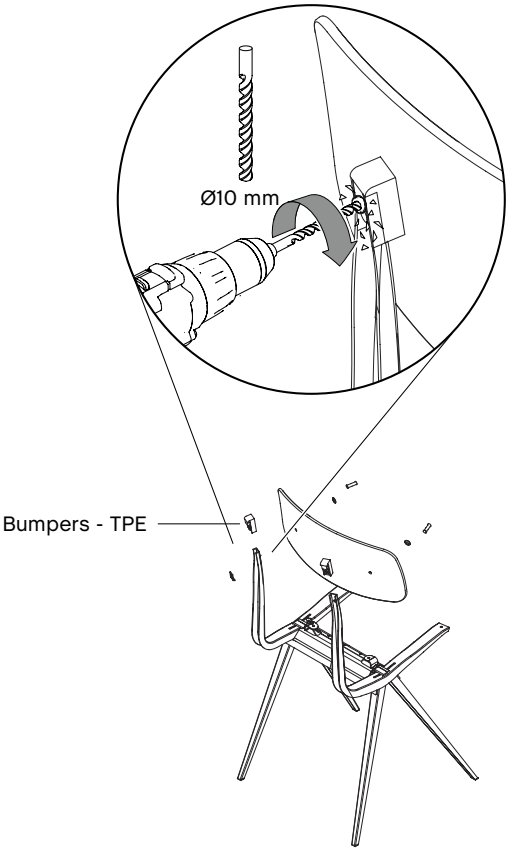
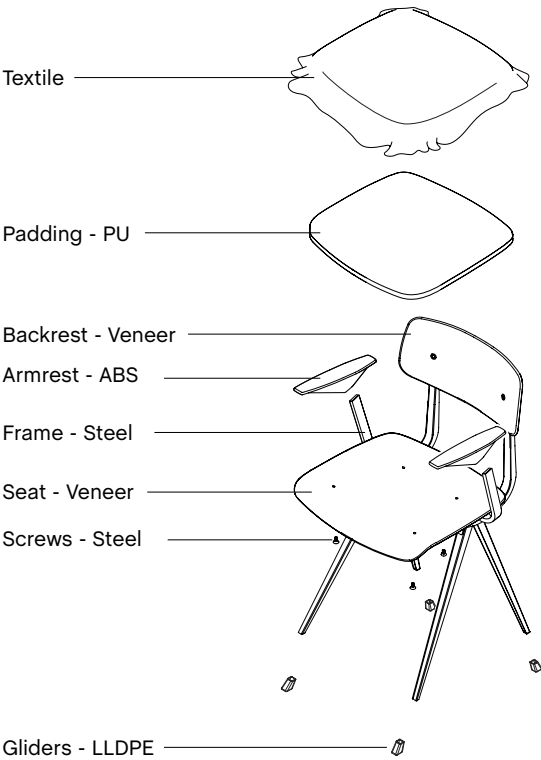



REVOLT CHAIR

STEP 1  
Unscrew the screws holding the seat and backrest

STEP 2  
Remove the screws and fittings underneath the seat

STEP 3  
Pull the gliders out of the legs

DISASSEMBLY

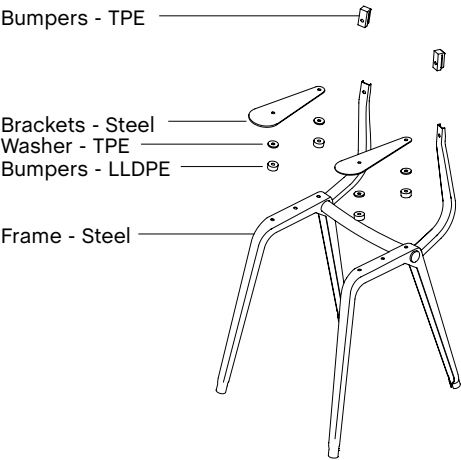
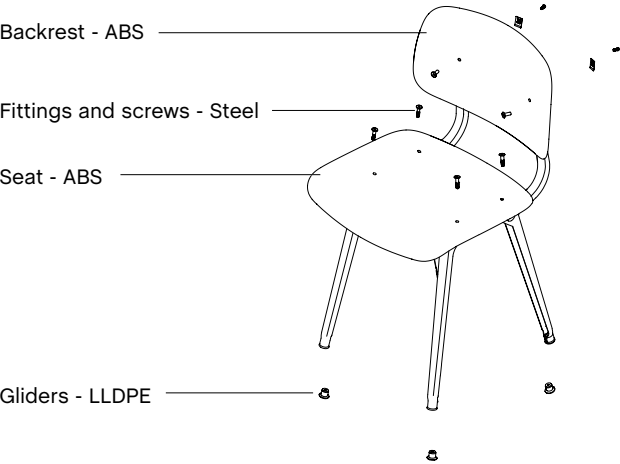





TABURETE 8 BAR STOOL

DISASSEMBLY

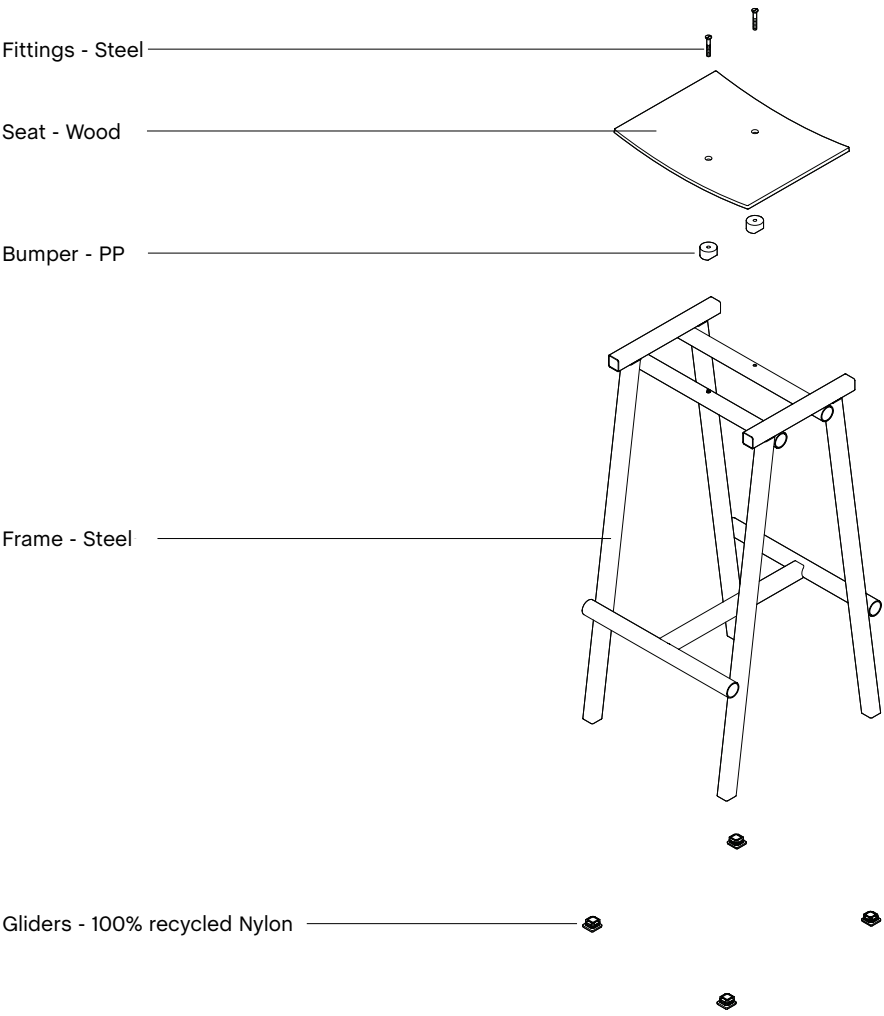



**CPH 10 TABLE**

STEP 1  
Turn the table upside down

---

STEP 2  
Unscrew all the screws holding the legs and crossbar

---

STEP 3  
Separate the reinforcement bar from the crossbar by unscrewing the screws

---

STEP 4  
Unscrew the gliders from the legs

---

**DISASSEMBLY**

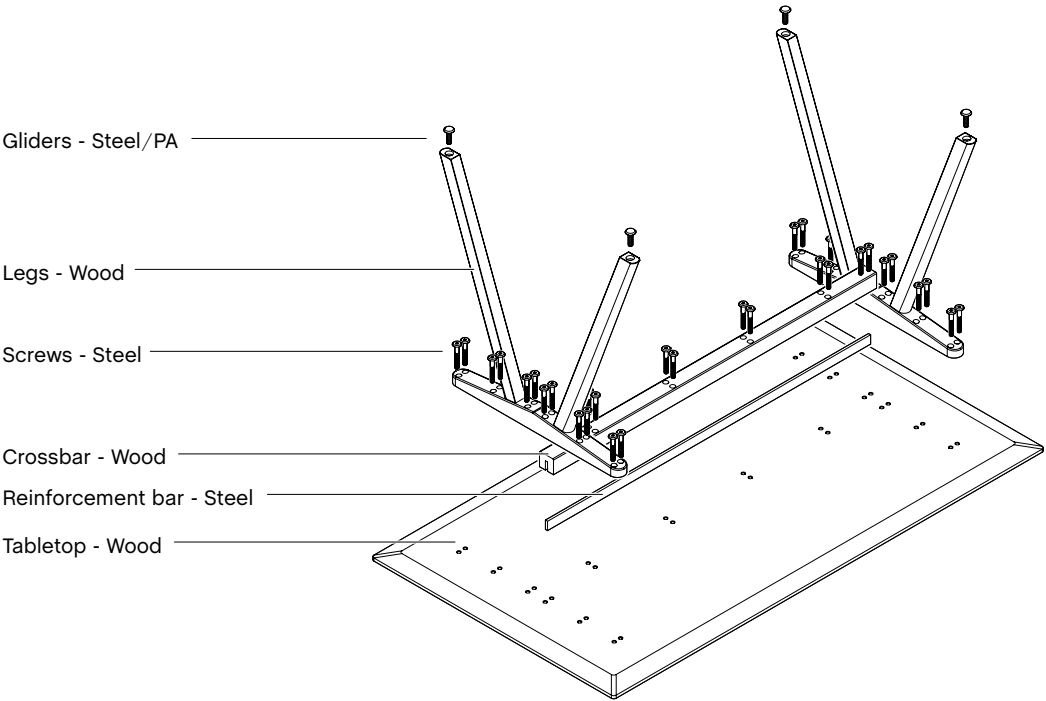



CPH 25 TABLE

STEP 1  
Turn the table upside down

STEP 2  
Unscrew all the screws holding the legs and crossbar

STEP 3  
Unscrew the gliders from the legs

DISASSEMBLY

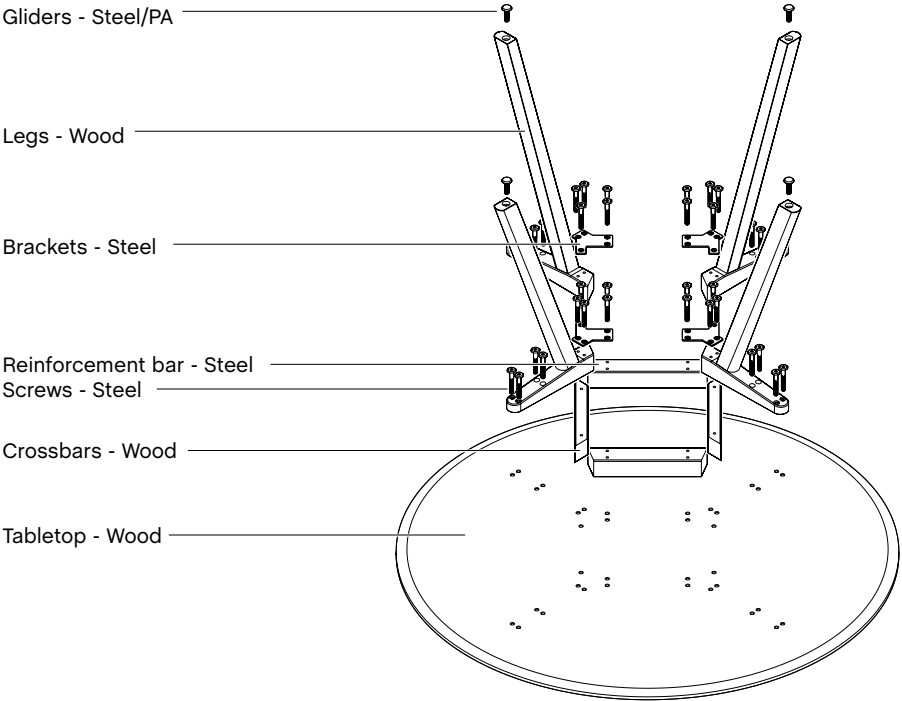



CPH 30 TABLE

STEP 1  
Turn the table upside down

---

STEP 2  
Unscrew all the screws holding the legs and crossbar

---

STEP 3  
Separate the reinforcement bar from the crossbar by unscrewing the screws

---

STEP 4  
Unscrew the gliders from the legs

---

DISASSEMBLY

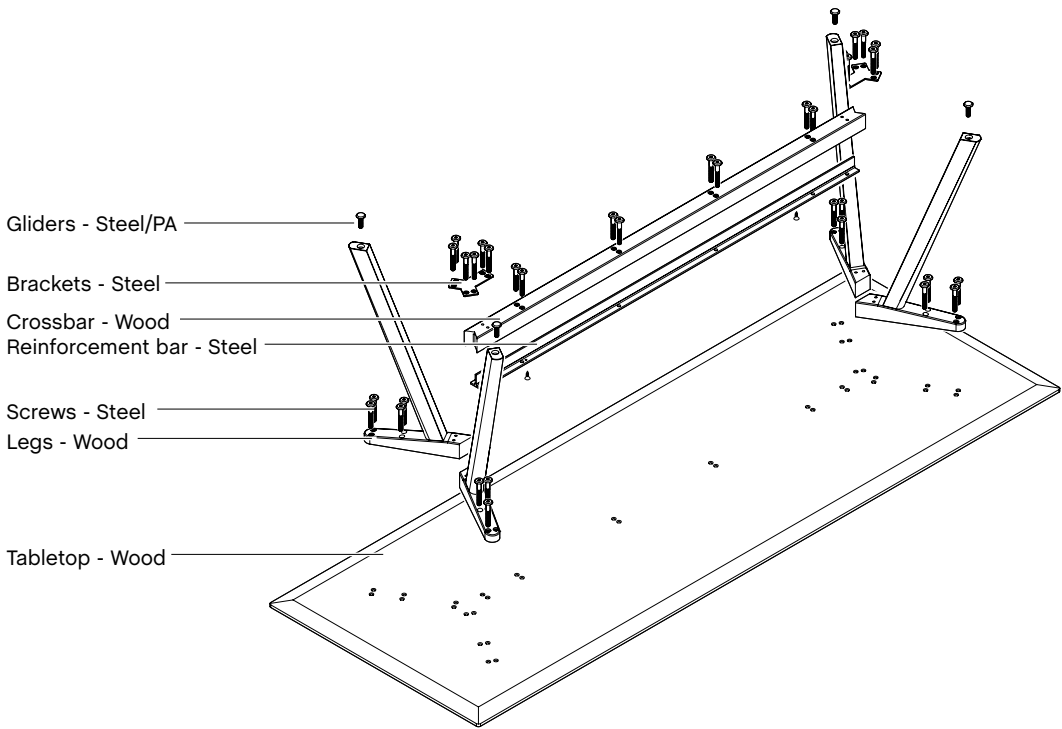



CPH 30 EXTENDABLE TABLE

STEP 1  
Turn the table upside down

STEP 2  
Unscrew all the screws holding the legs and crossbar

STEP 3  
Separate the reinforcement bar from the crossbar by unscrewing the screws

STEP 4  
Unscrew the gliders from the legs

DISASSEMBLY

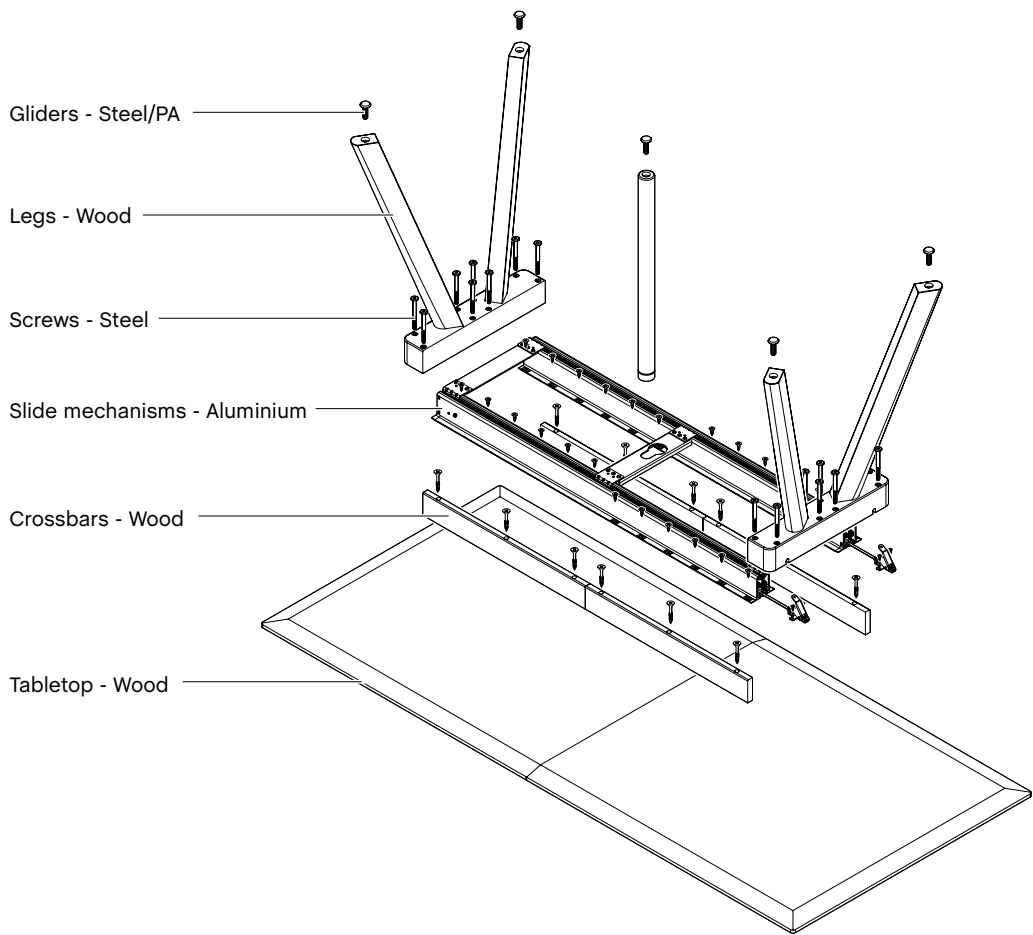



**CPH 90 TABLE**

STEP 1  
Turn the table upside down

---

STEP 2  
Unscrew all the screws holding the legs and crossbar

---

STEP 3  
Unscrew the gliders from the legs

---

**DISASSEMBLY**

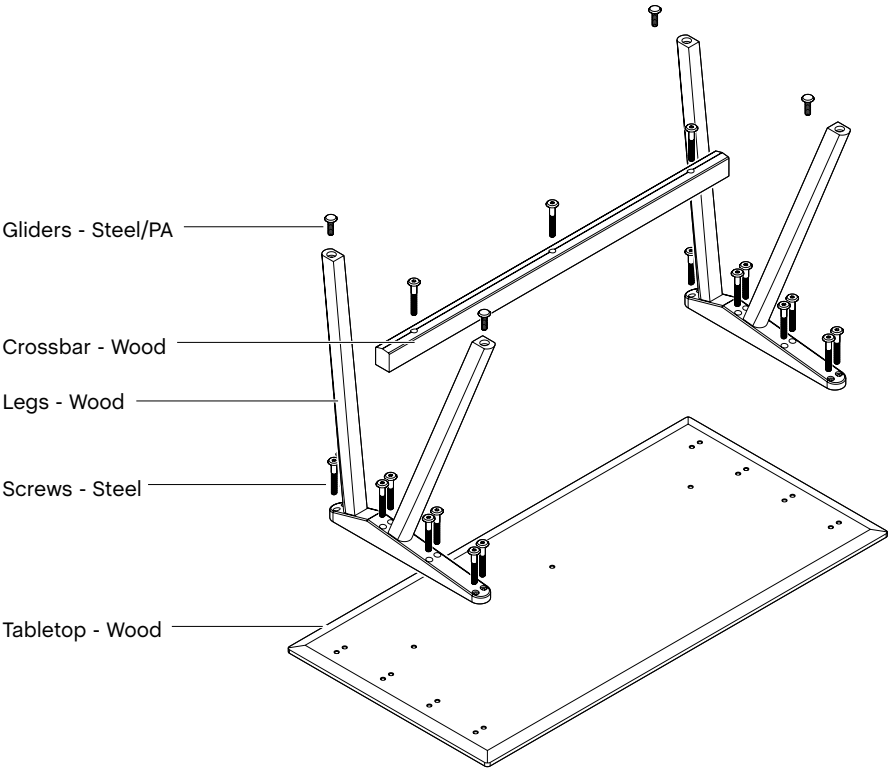



**CPH 190 TABLE**

STEP 1  
Turn the table upside down

---

STEP 2  
Unscrew the gliders from the legs

---

**DISASSEMBLY**

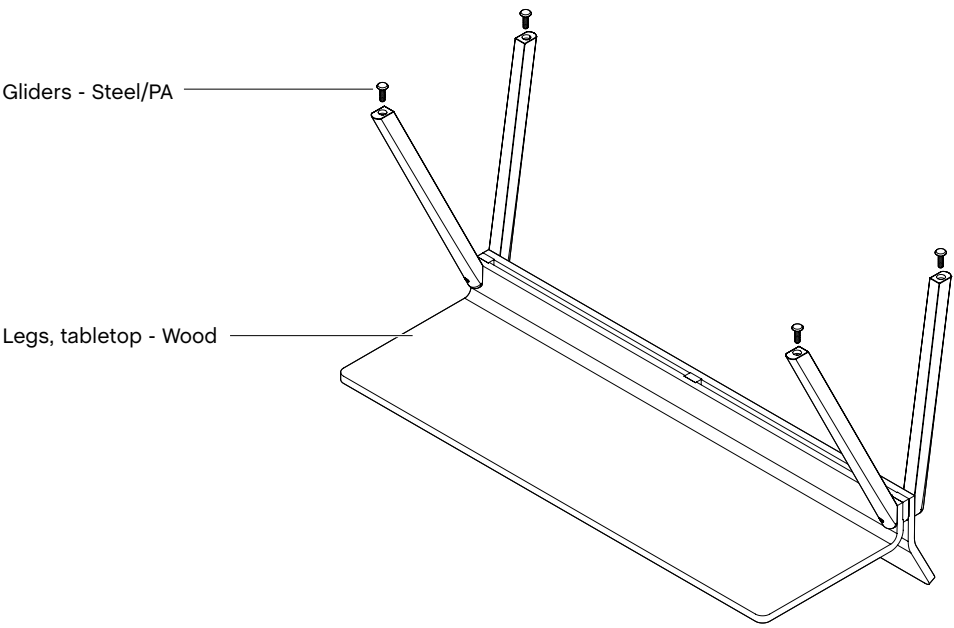



**CPH DEUX 210 TABLE**

STEP 1  
Turn the table upside down

---

STEP 2  
Unscrew all the screws holding the legs and crossbar

---

STEP 3  
Unscrew the gliders from the legs

---

**DISASSEMBLY**

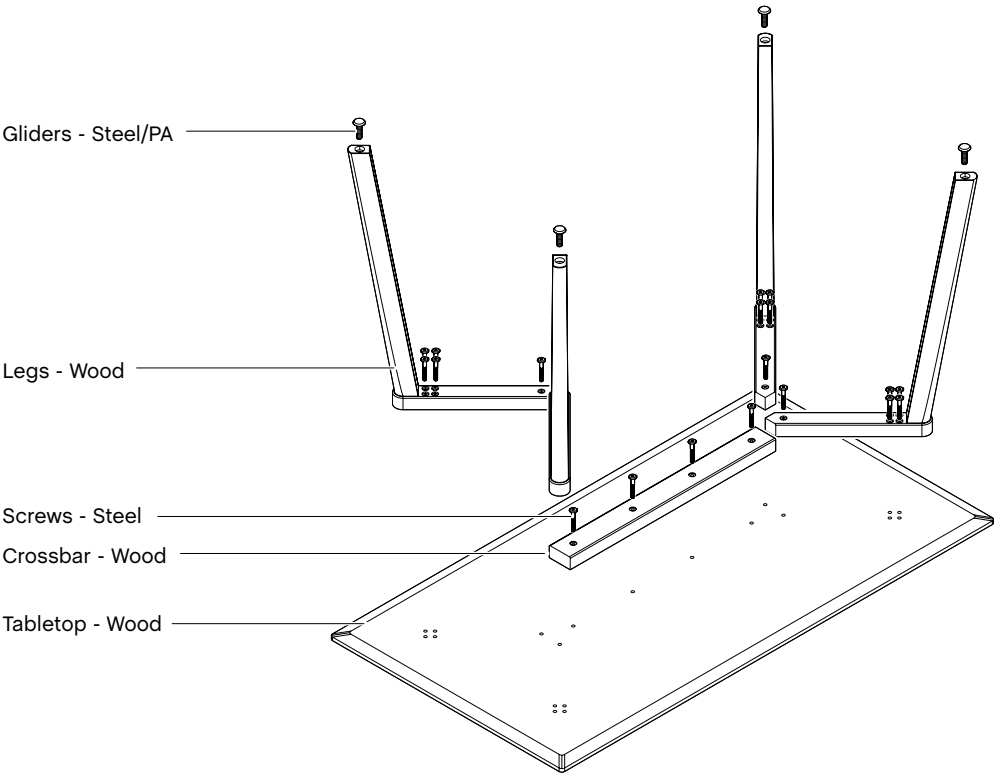





**CPH DEUX 215 BENCH**

STEP 1  
Turn the bench upside down

STEP 2  
Unscrew all the screws holding the legs and crossbar

STEP 3  
Unscrew the gliders from the legs

**DISASSEMBLY**

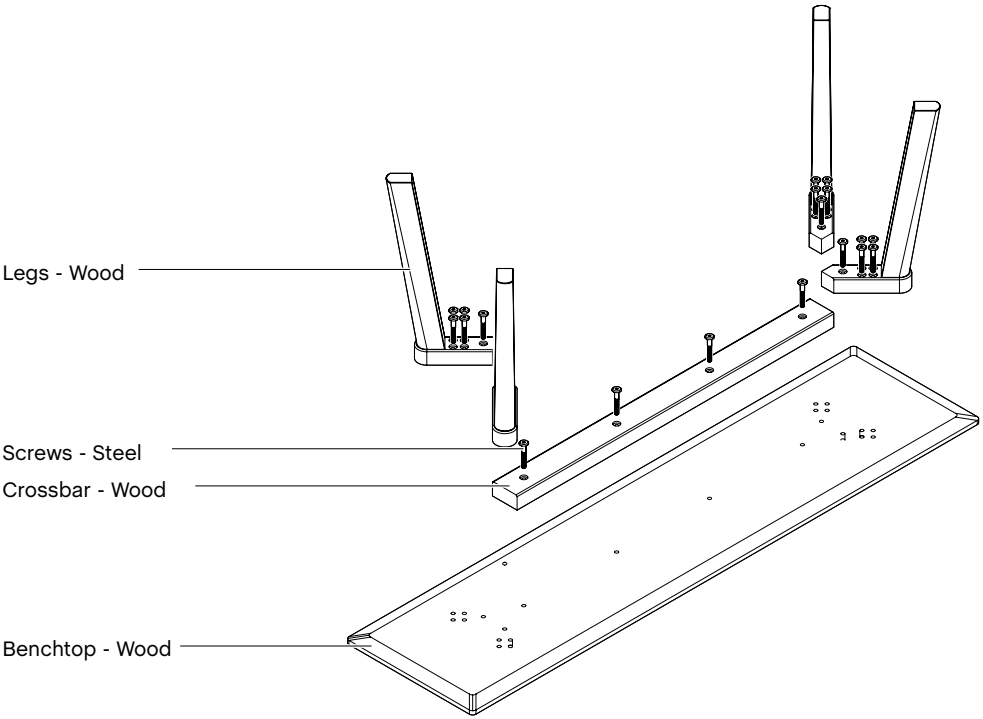



**CPH DEUX 220 TABLE**

STEP 1  
Turn the table upside down

---

STEP 2  
Unscrew all the screws holding the legs and crossbar

---

STEP 3  
Unscrew the gliders from the legs

---

**DISASSEMBLY**

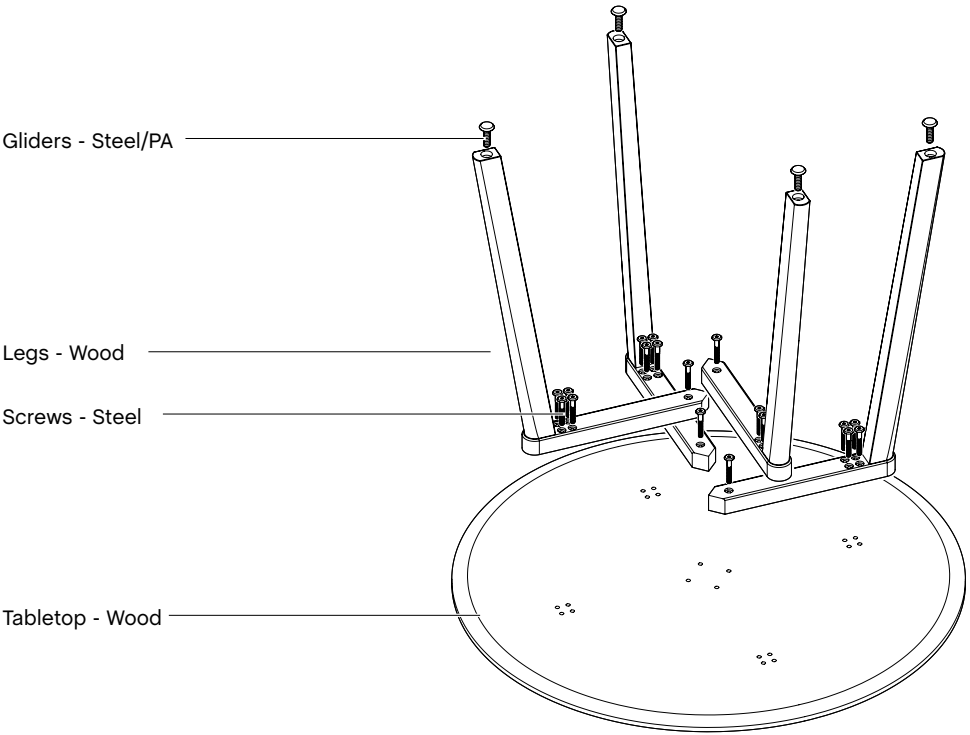



PASTIS TABLE

STEP 1  
Turn the table upside down

STEP 2  
Unscrew all the screws holding the legs and the column

DISASSEMBLY

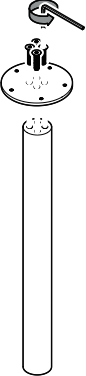
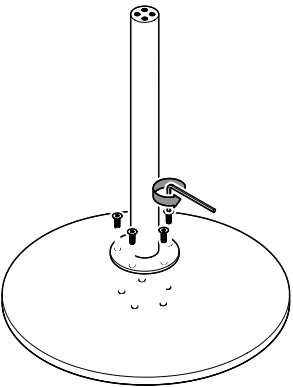
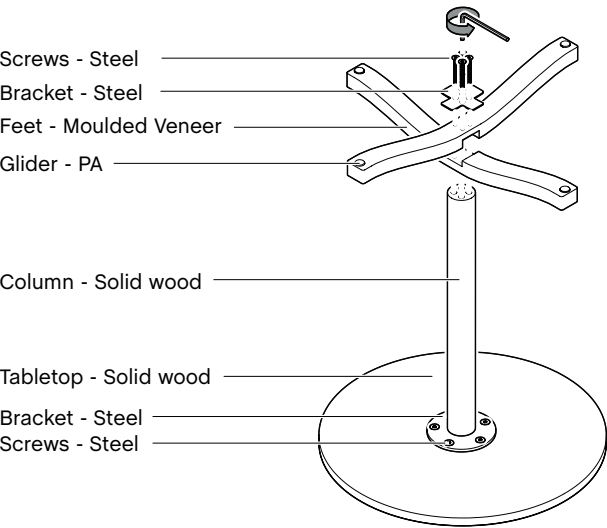



TRIANGLE LEG BENCH

STEP 1  
Turn the bench upside down

STEP 2  
Unscrew the bolts holding the legs

STEP 3  
Unscrew the feet and the tapping screw in the top of the leg

STEP 4  
Unscrew all the screws to separate the frame from the bench

STEP 5  
Unscrew the screws holding the brackets in each corner

DISASSEMBLY

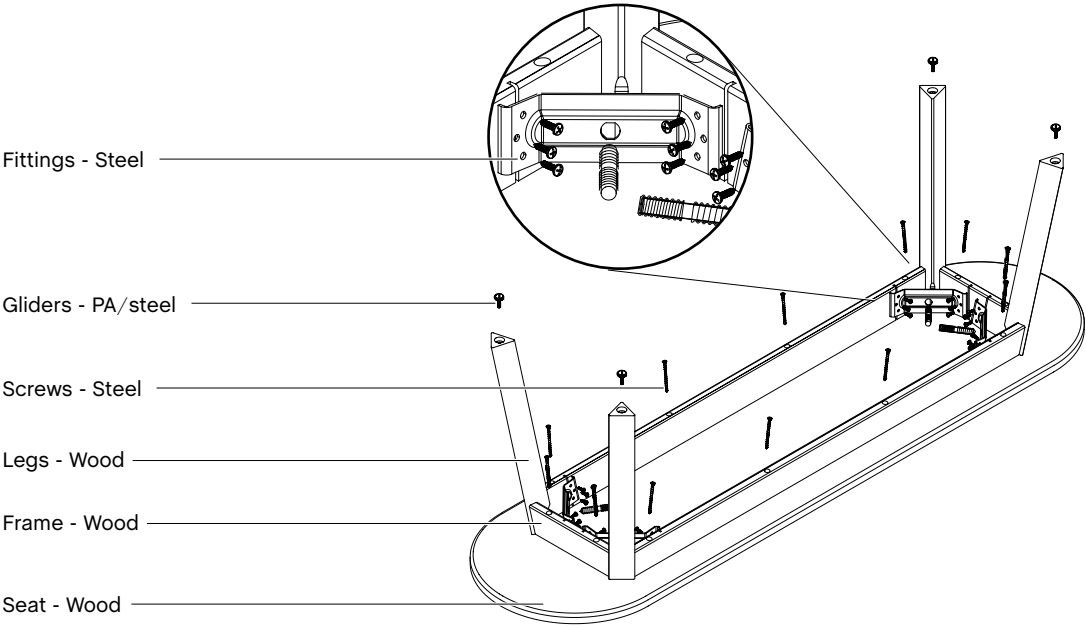



TRIANGLE LEG TABLE

STEP 1  
Turn the table upside down

STEP 2  
Unscrew the bolts holding the legs

STEP 3  
Unscrew the feet and the tapping screw in the top of the leg

STEP 4  
Unscrew all the screws to separate the frame from the table

DISASSEMBLY

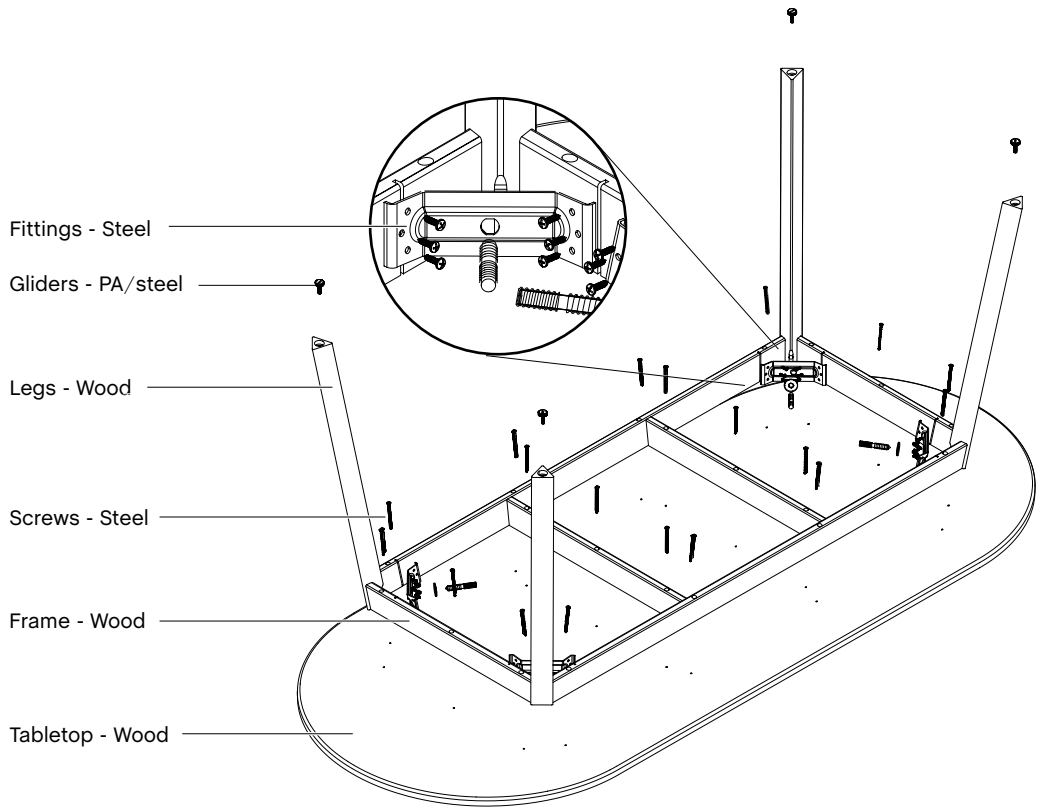



**LOOP STAND TABLE**

STEP 1  
Turn the table upside down

---

STEP 2  
Unscrew all the screws holding the legs and support bar

---

**DISASSEMBLY**

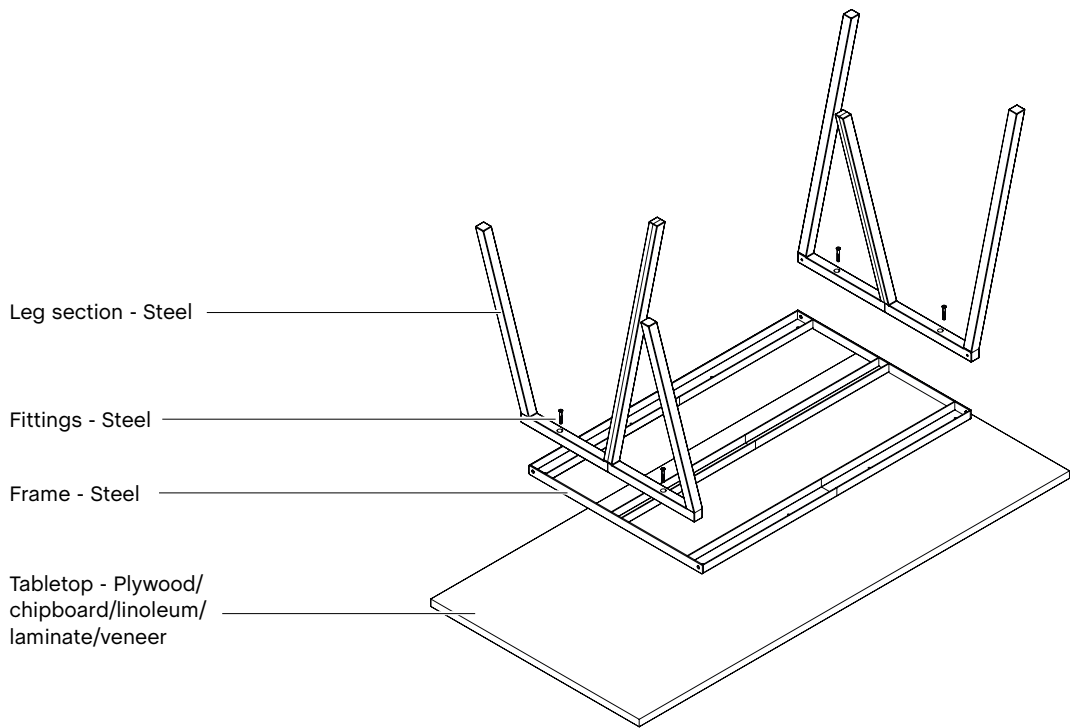



LOOP STAND ROUND TABLE

STEP 1  
Turn the table upside down

STEP 2  
Unscrew all the screws holding the leg section

DISASSEMBLY

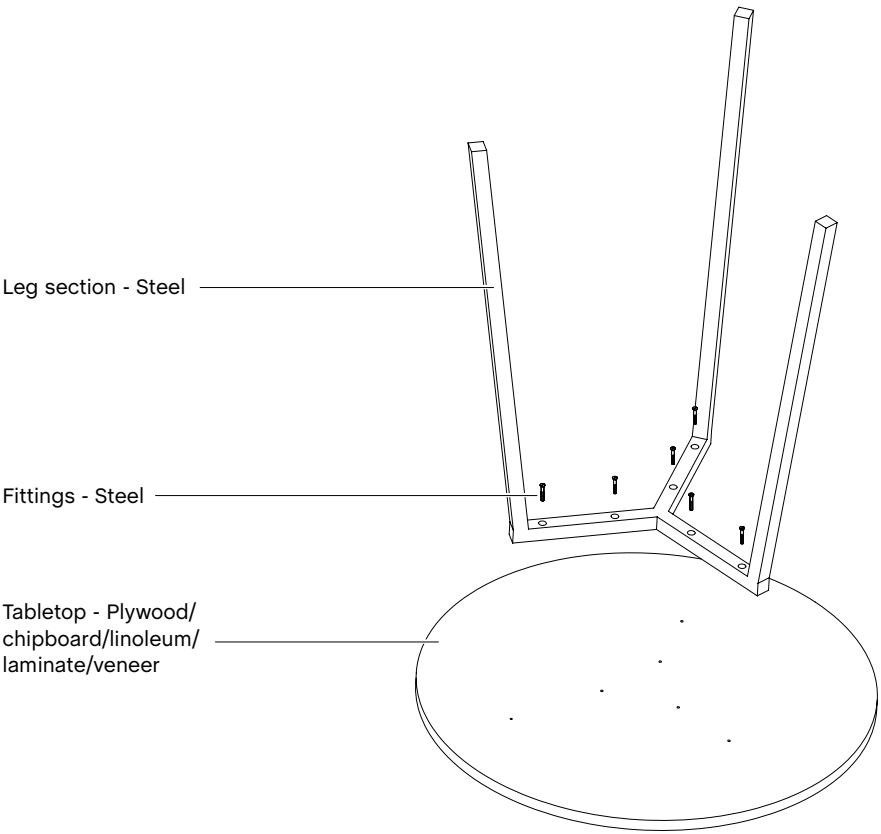



**BOA TABLE**

STEP 1  
Turn the table upside down

STEP 2  
Unscrew all the screws holding the legs and crossbar

STEP 3  
Unscrew the gliders from the legs

**DISASSEMBLY**

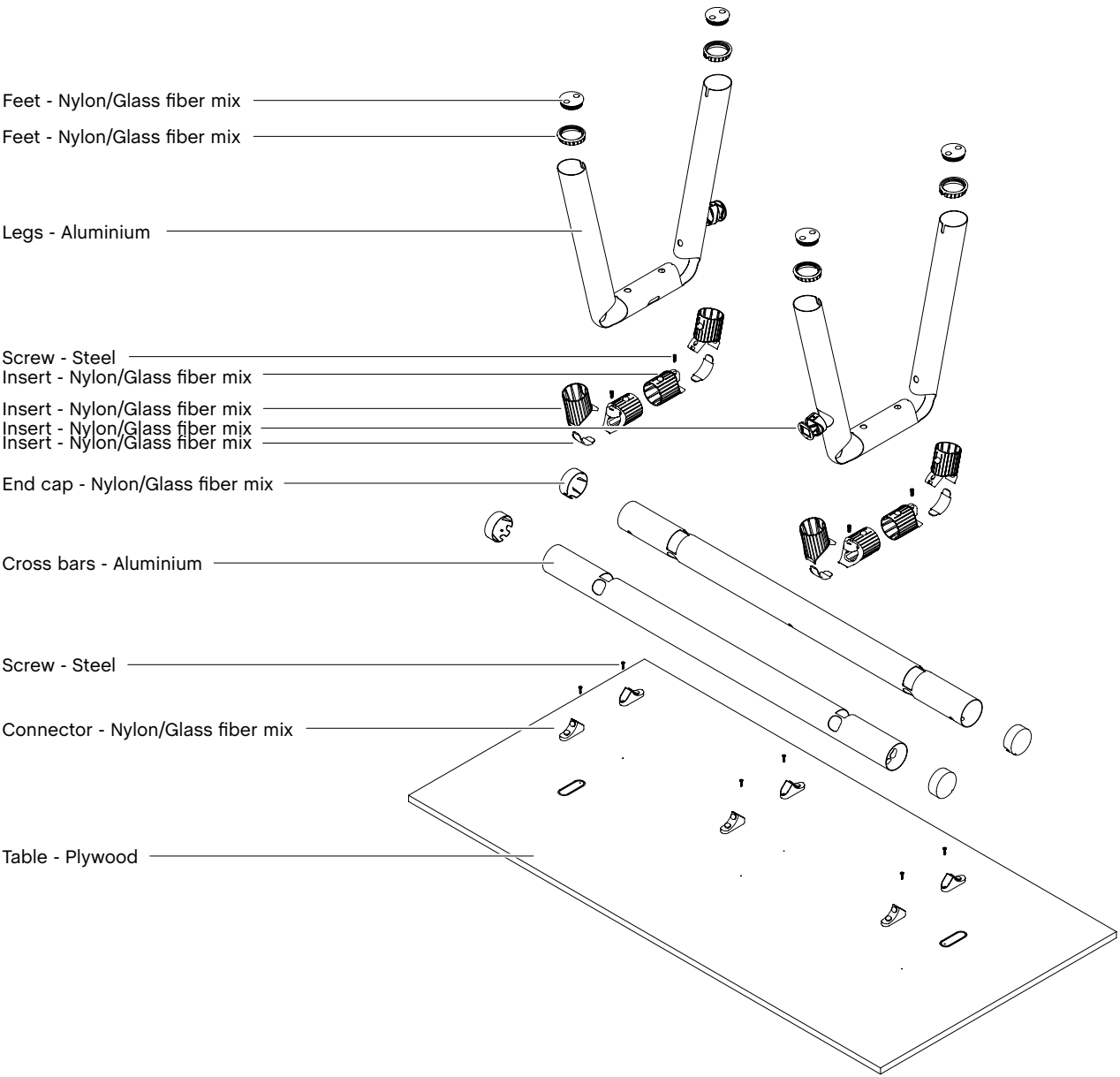





COLOUR RACK S-SHAPE

DISASSEMBLY

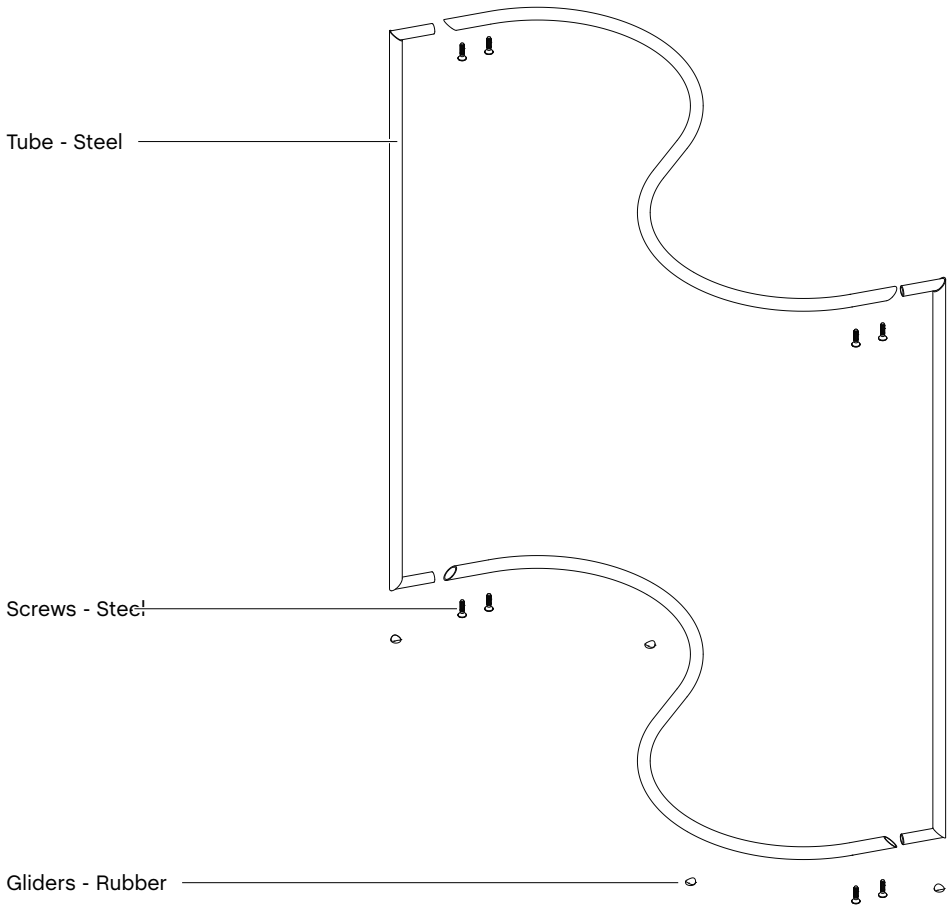



COLOUR RACK C-SHAPE

DISASSEMBLY

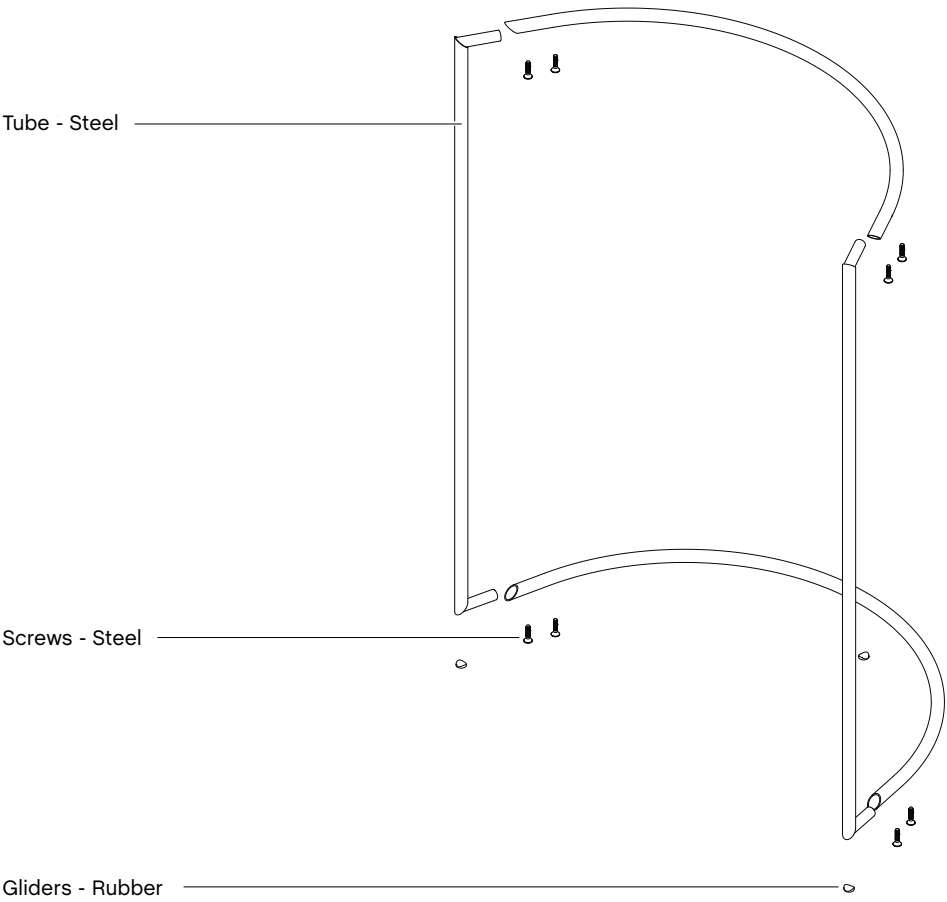



**X-LINE CHAIR**

STEP 1  
Turn the chair upside down

---

STEP 2  
Remove the gliders from the legs

---

**DISASSEMBLY**

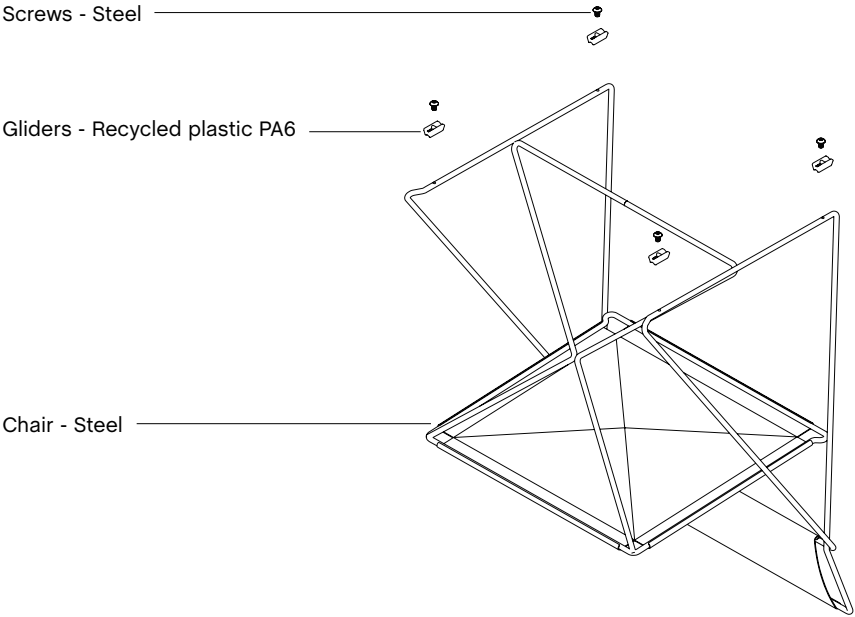

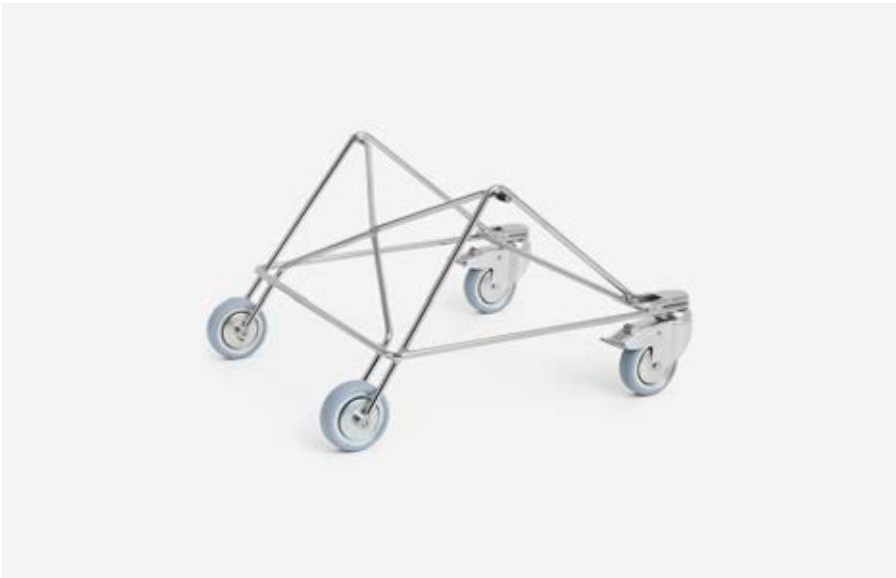

**X-LINE CHAIR TROLLEY**

STEP 1  
Unscrew the screws attaching the front wheels

---

STEP 2  
Unscrew the screws from the back wheels

---

STEP 3  
Remove the back wheels by detaching the lock pin

---

STEP 4  
Remove the plastic caps from the top of the chair trolley

---

**DISASSEMBLY**

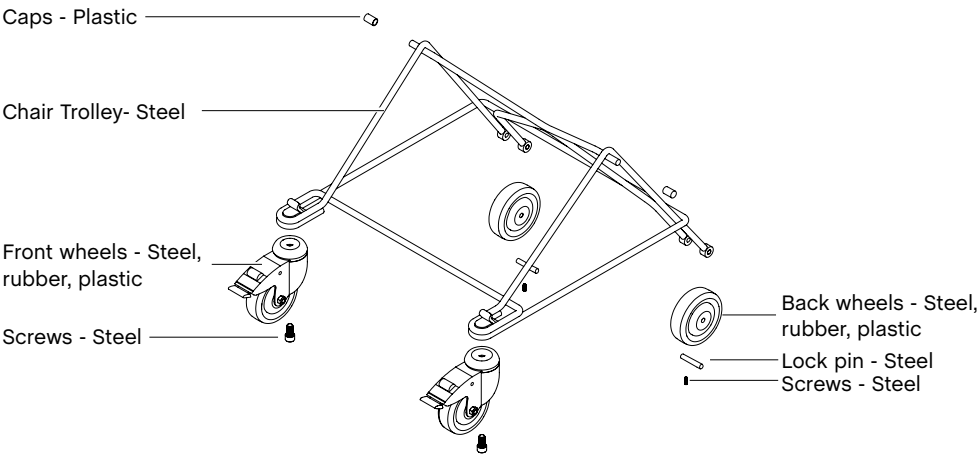



**AMANTA**

STEP 1  
Remove the legs and unscrew the steel pins

STEP 2  
Remove all cushions. Pull the tufted (capitonné) buttons on the backrest and top cushion and cut them so the cushion covers can be removed

STEP 3  
Unzip the cushion covers and remove the plywood boards from both the backrest and seat cushion foam

STEP 4  
Remove the steel fittings from the plywood boards

**DISASSEMBLY**

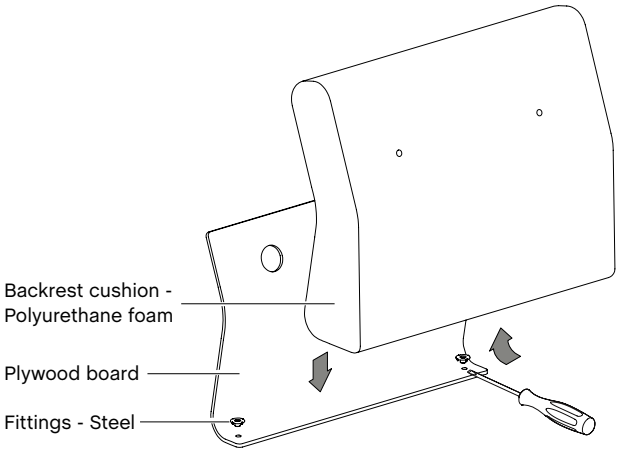
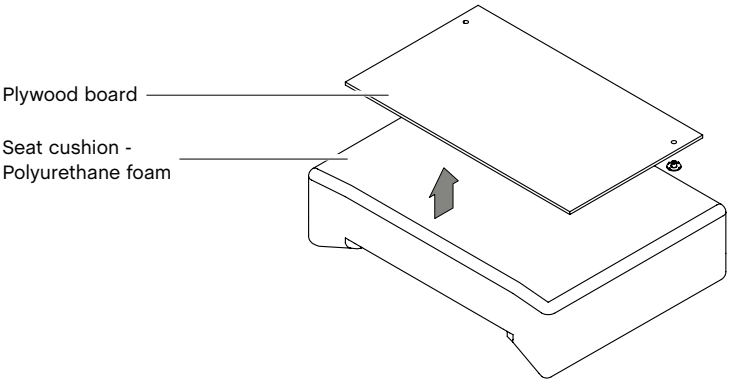
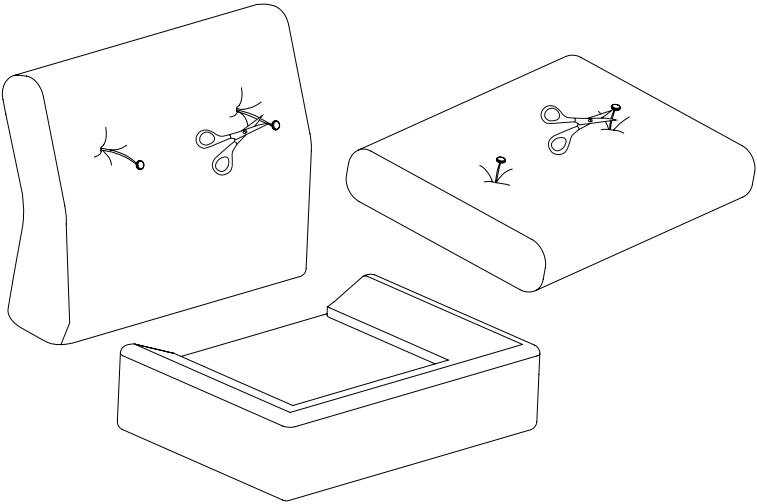
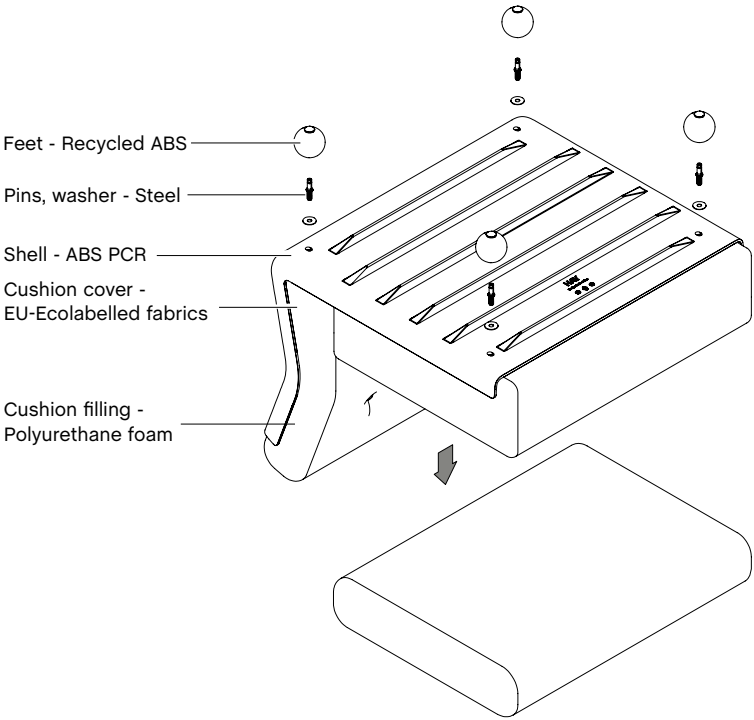



ANNEX TABLE | WOOD LEGS

STEP 1  
Turn the table upside down

STEP 2  
Unscrew all the screws holding the legs to the corners and aprons

STEP 3  
Unscrew the gliders from the legs

DISASSEMBLY

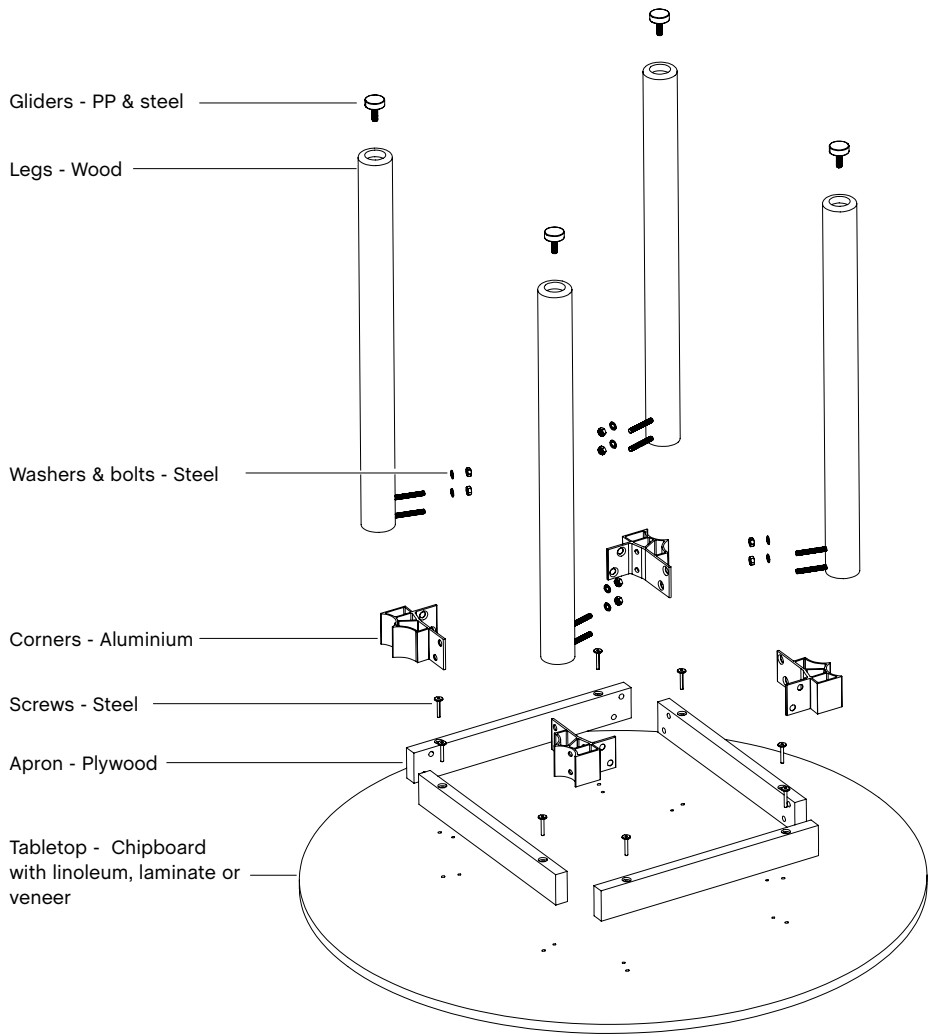



ANNEX TABLE | ALUMINIUM LEGS | 4 LEGS

STEP 1  
Turn the table upside down

STEP 2  
Unscrew all the screws holding the legs to the corners, the aprons, and the tabletop connectors attached to the tabletop

STEP 3  
Remove the gliders from the legs

DISASSEMBLY

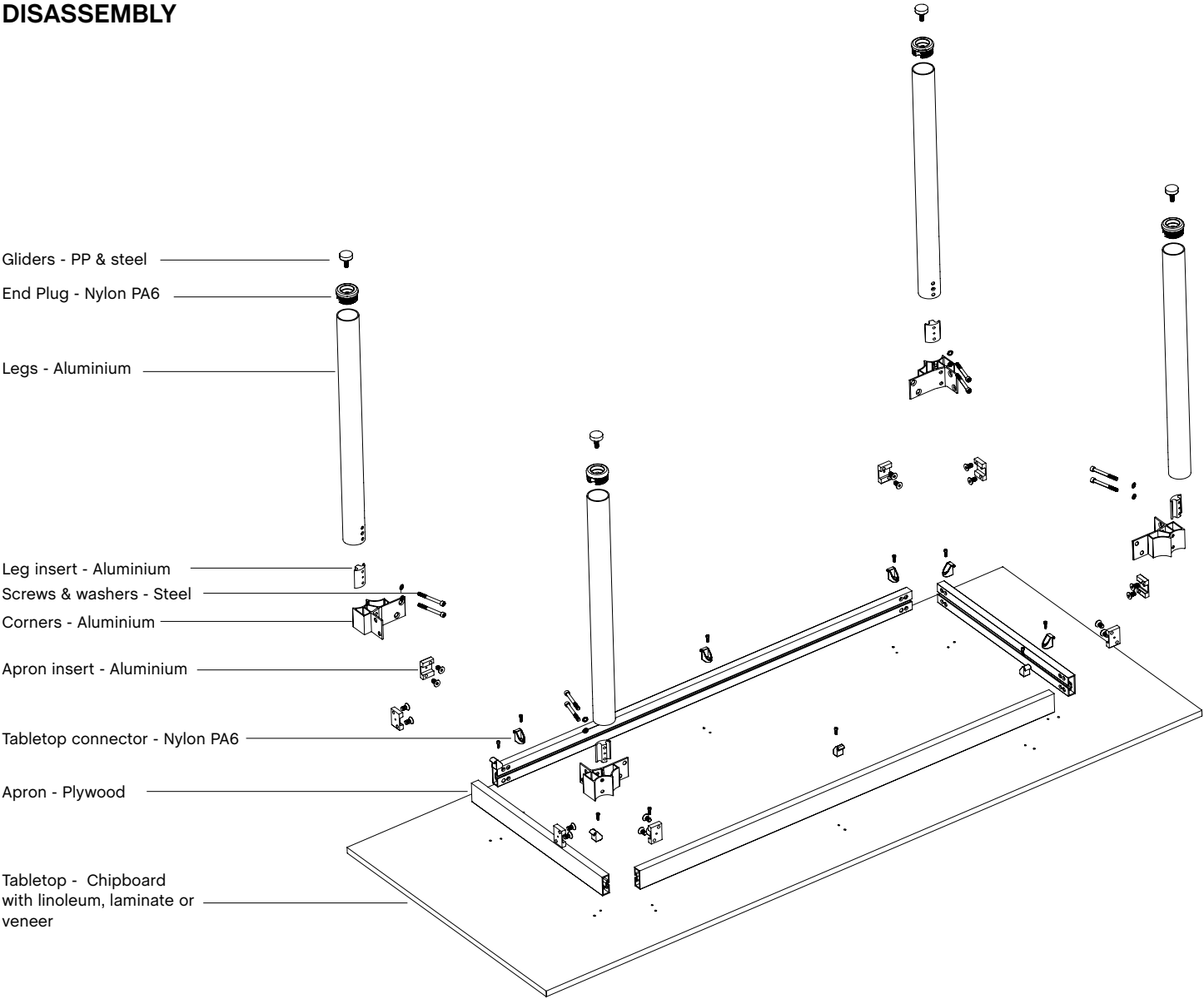



ANNEX TABLE | ALUMINIUM LEGS | 6 LEGS

STEP 1  
Turn the table upside down

STEP 2  
Unscrew all the screws holding the legs to the corners, the aprons, and the tabletop connectors attached to the tabletop

STEP 3  
Open the table latch

STEP 4  
Remove the gliders from the legs

DISASSEMBLY

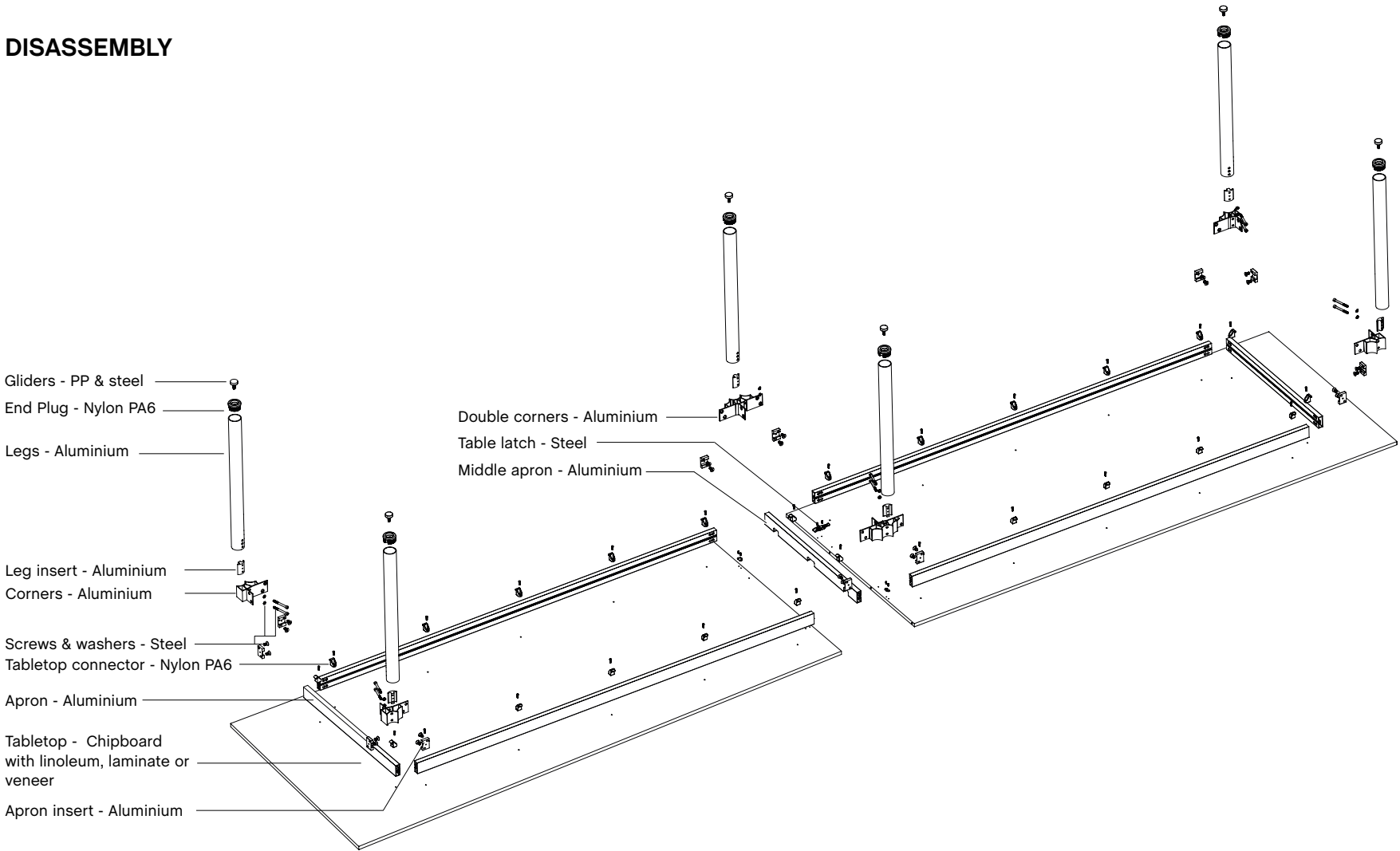





LAYOUT ARMCHAIR 211 | 212 | 213 | 214

STEP 1  
Turn the chair upside down

STEP 2  
Detach the seat from the shell by unscrewing the screws located at the bottom of the shell. Then, remove any fittings attached to the seat

STEP 3  
Return the chair to its upright position

STEP 4  
Unscrew the screws and separate the shell from the frame

STEP 5  
Remove the legs and steel inserts from aluminium plate

STEP 6  
Remove the gliders from the frame

If your version is 213 or 214, with an upholstered cover or seat, please refer to the disassembly guide further down in this document for instructions on how to proceed.

DISASSEMBLY

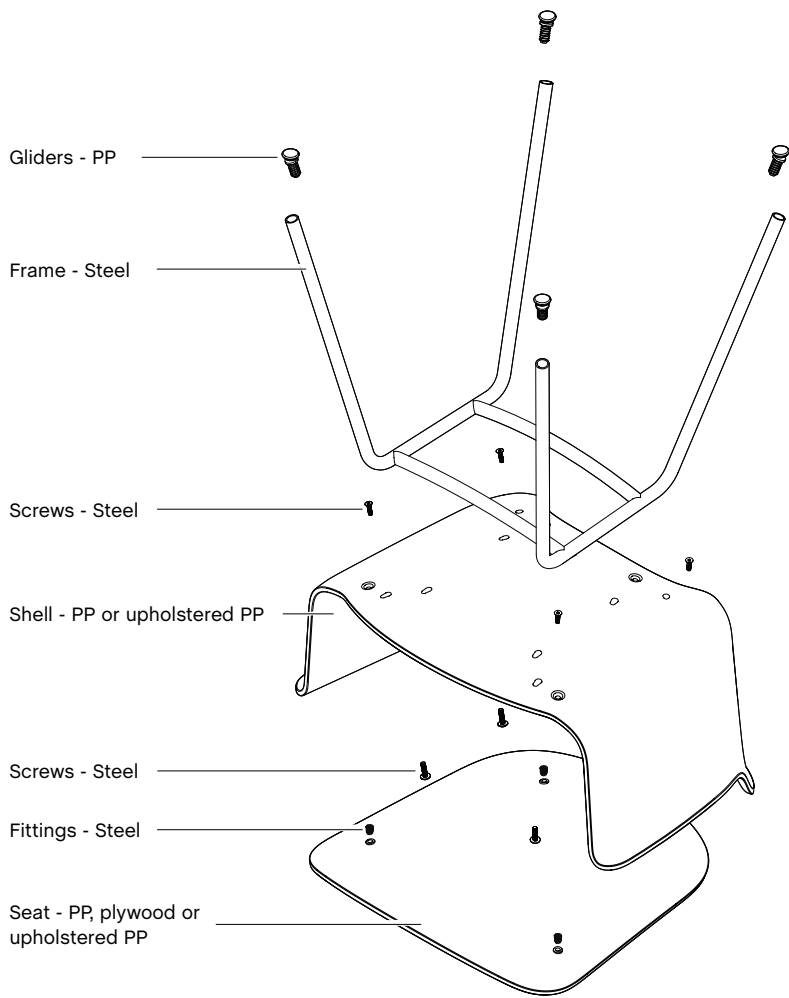



LAYOUT ARMCHAIR 221 | 222 | 223 | 224

STEP 1  
Turn the chair upside down

STEP 2  
Detach the seat from the shell by unscrewing the screws located at the bottom of the shell. Then, remove any fittings attached to the seat

STEP 3  
Return the chair to its upright position

STEP 4  
Unscrew the screws and separate the shell from the frame

STEP 5  
Remove the wood legs and steel inserts from aluminium plate

STEP 6  
Remove the gliders from the frame

If your version is 223 or 224, with an upholstered cover or seat, please refer to the disassembly guide further down in this document for instructions on how to proceed.

DISASSEMBLY

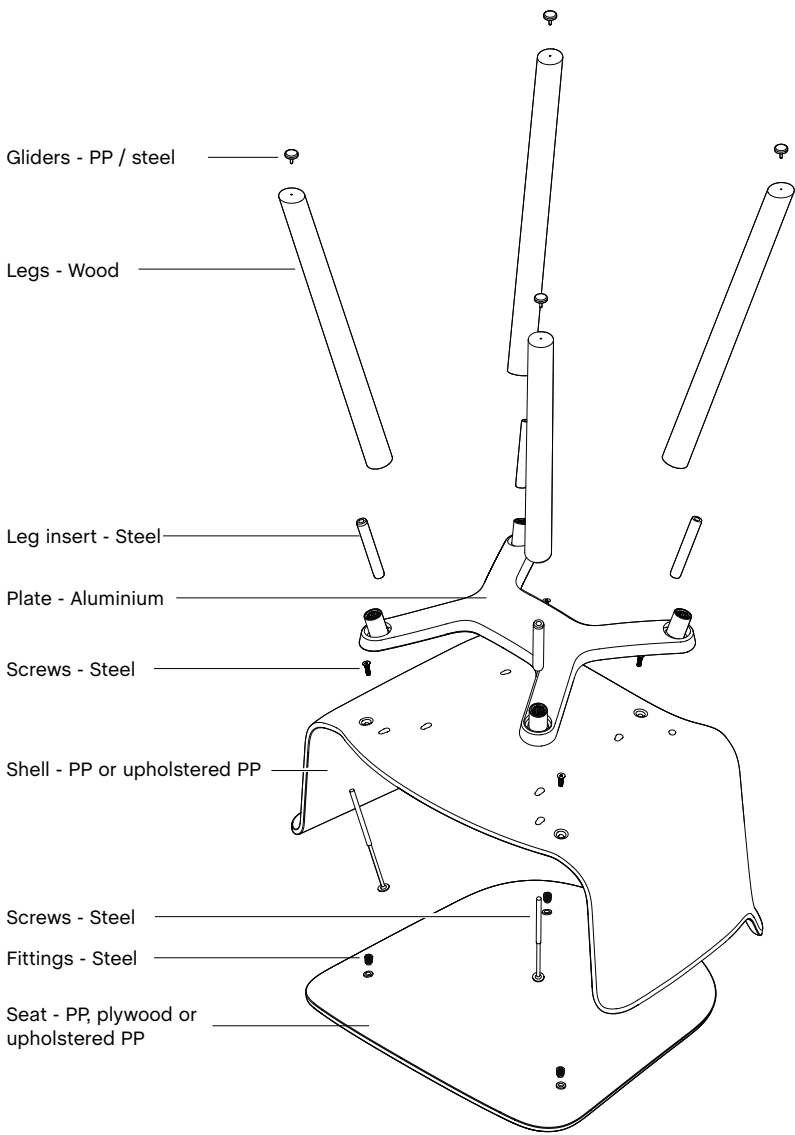



LAYOUT ARMCHAIR 231 | 232 | 233 | 234

STEP 1  
Turn the chair upside down

STEP 2  
Detach the seat from the shell by unscrewing the screws located at the bottom of the shell. Then, remove any fittings attached to the seat

STEP 3  
Return the chair to its upright position

STEP 4  
Unscrew the screws and separate the shell from the frame

STEP 5  
Detach the aluminium plate from the swivel column by applying vertical force

STEP 6  
Detach the foot from the swivel column by unscrewing the screws located at the bottom centre of the foot

STEP 7  
Remove the gliders from the foot

If your version is 233 or 234, with an upholstered cover or seat, please refer to the disassembly guide further down in this document for instructions on how to proceed.

DISASSEMBLY

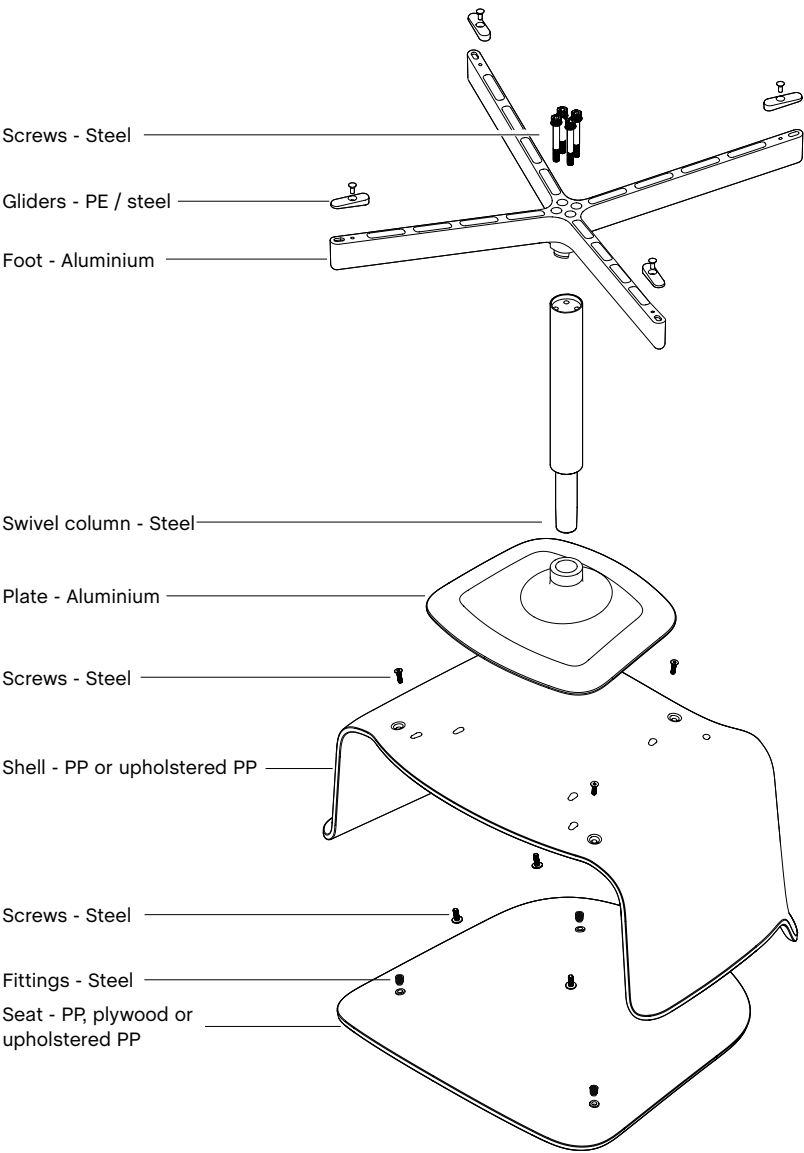



## DISASSEMBLY

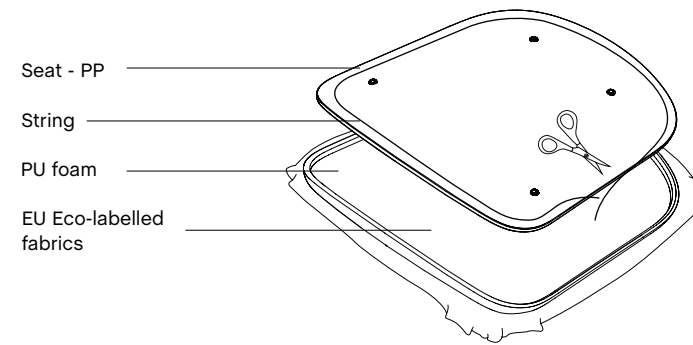

## LAYOUT SEAT UPHOLSTERY

### STEP 1

Once the seat is removed from the frame, turn it upside down

---

### STEP 2

Cut the string with scissors. Separate the PU foam and textile from the seat

---



LAYOUT FULL UPHOLSTERY

STEP 1  
Release the two Velcro flaps to reveal both ends of the zipper.  
Then open the zipper, ensuring it is completely unzipped at the end

---

STEP 2  
Release the Velcro securing the cover to the shell, then pull the cover off

---

DISASSEMBLY

