

DESIGN BY BRUNO REY FOR DIETIKER, IN COLLABORATION WITH HAY

HAY

REY COLLECTION

HIGHLIGHTS

- A family of chairs, stools, bar stools, tables and coffee tables available in different colours and finishes
- Known for its combination of aluminium cast brackets with wood
- Available in both original colours, as well as new tones selected by HAY
- The chairs have been modified in new dimensions to accommodate contemporary lifestyle requirements
- The Chair and Bar Stool are available with selected seat upholstery options
- The Chair and Stool are stackable up to 4 pcs.
- Suitable for a wide variety of private and public environments



REY COLLECTION DESIGN BY BRUNO REY FOR DIETIKER, IN COLLABORATION WITH HAY

Based on the original Rey Collection designed by Swiss designer Bruno Rey in 1971, HAY has teamed up with Dietiker to present the Rey Chair, Stool, and Bar Stool, along with the Bruno Rey Table and Coffee Table, in a new updated form. Centred around the acclaimed stackable chair design, which combines cast aluminum brackets with wooden parts, the entire collection is unified by a shared language of rounded edges and robust connections. The collection retains the functionality and resilience of the classic designs and has been modified with new dimensions to accommodate contemporary lifestyle requirements. Rey is available in both the original colours as well as new tones and upholstery options selected by HAY. It's essential yet distinct design language makes it suitable for a variety of domestic, public, or corporate settings, from living rooms and halls to cafés and receptions.





Rey Bar Stool H65 | Cream white water-based lacquered beech



Rey Chair | Grape red water-based lacquered beech
Rey Stool | Grape red water-based lacquered beech
Rey Table | Vulcano laminate & deep black water-based lacquered beech



Rey Chair | Deep blue water-based lacquer beech



MATERIALS

CHAIR, BAR STOOL & STOOL

Moulded plywood with beech veneer. Legs in solid beech. Bar Stool with chromed steel footrest. 25 mm foam on upholstered chairs and bar stools

GLIDER

Plastic. Standard on all variants. Suitable for all floorings that are not too sensitive





Rey Chair | Cream white water-based lacquered beech

COLOUR & FINISH | CHAIR, BAR STOOL & STOOL

Please note that the colours are indicative

	MODEL				
COLOUR & FINISH		Rey Chair	Rey Bar Stool Low	Rey Bar Stool High	Rey Stool
Scarlet red water-based lacquered beech		<input type="checkbox"/>	<input type="checkbox"/>	<input type="checkbox"/>	<input type="checkbox"/>
Deep black water-based lacquered beech		<input type="checkbox"/>	<input type="checkbox"/>	<input type="checkbox"/>	<input type="checkbox"/>
Golden water-based lacquered beech		<input type="checkbox"/>	<input type="checkbox"/>	<input type="checkbox"/>	<input type="checkbox"/>
Umber brown water-based lacquered beech		<input type="checkbox"/>	<input type="checkbox"/>	<input type="checkbox"/>	<input type="checkbox"/>
Deep blue water-based lacquered beech		<input type="checkbox"/>	<input type="checkbox"/>	<input type="checkbox"/>	<input type="checkbox"/>
Cream white water-based lacquered beech		<input type="checkbox"/>	<input type="checkbox"/>	<input type="checkbox"/>	<input type="checkbox"/>
Fall green water-based lacquered beech		<input type="checkbox"/>	<input type="checkbox"/>	<input type="checkbox"/>	<input type="checkbox"/>
Soft mint water-based lacquered beech		<input type="checkbox"/>	<input type="checkbox"/>	<input type="checkbox"/>	<input type="checkbox"/>
Grape red water-based lacquered beech		<input type="checkbox"/>	<input type="checkbox"/>	<input type="checkbox"/>	<input type="checkbox"/>
Slate blue water-based lacquered beech		<input type="checkbox"/>	<input type="checkbox"/>	<input type="checkbox"/>	<input type="checkbox"/>

SEAT UPHOLSTERY | CHAIR

Deep blue  Steelcut 190	Slate blue  Steelcut trio 113	Scarlet red  Steelcut trio 636	Deep black  Steelcut trio 124	Golden  Steelcut trio 213	Umber brown  Steelcut trio 376
Fall green  Steelcut trio 916	Grape red  Steelcut trio 416	Fall green  Relate 921	Soft mint  Relate 921	Cream white  Mode 011	

SEAT UPHOLSTERY | BAR STOOL

Deep blue  Steelcut 190	Slate blue  Steelcut trio 113	Scarlet red  Steelcut trio 636	Deep black  Steelcut trio 124
Golden  Steelcut trio 213	Umber brown  Steelcut trio 376	Cream white  Mode 011	



MATERIALS

TABLE

Chipboard core with laminate or veneer tabletop and ABS or veneer edge. Legs in solid beech.

COFFEE TABLE

Chipboard core with veneer tabletop and veneer edge. Legs in solid beech.

COLOUR & FINISH | REY COFFEE TABLE

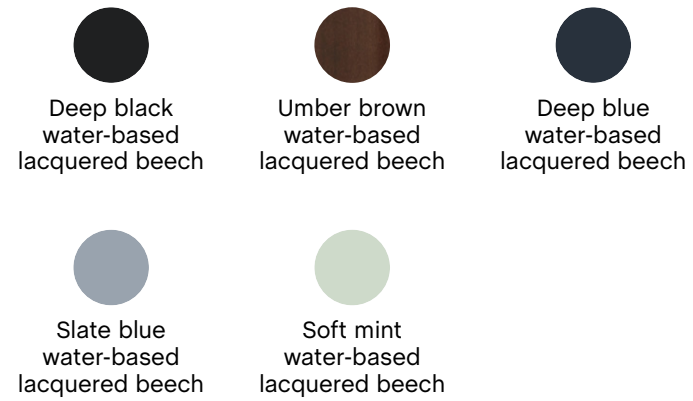

COLOUR & FINISH | REY TABLE

	FRAME	Deep black water-based lacquered beech	Golden water-based lacquered beech	Deep blue water-based lacquered beech	Slate blue water-based lacquered beech
TABLETOP					
Gull laminate Pfleiderer U18031					
Royal blue laminate Pfleiderer U17500					
Ivory white laminate Pfleiderer U11506					
Vulcano laminate Pfleiderer U12011					
Golden water-based lacquered beech					

DIMENSIONS

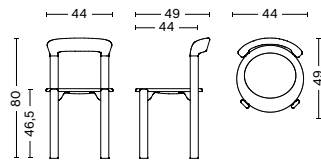

CHAIR
Width 44 cm
Depth 49 cm
Height 80 cm
Seat height 46,5 cm
Seat depth 44 cm
Weight 6,3 kg

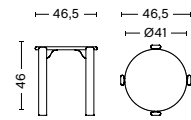

STOOL
Width 46,5 cm
Depth 46,5 cm
Height 46 cm
Diameter seat 41 cm
Weight 6 kg

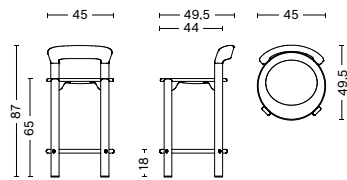

BAR STOOL LOW
Width 45 cm
Depth 49,5 cm
Height 87 cm
Seat height 65 cm
Seat depth 44 cm
Footrest height 18 cm
Weight 7,8 kg

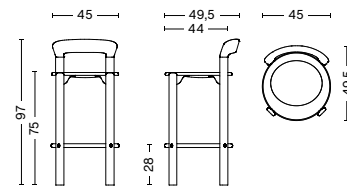

BAR STOOL HIGH
Width 45 cm
Depth 49,5 cm
Height 97 cm
Seat height 75 cm
Seat depth 44 cm
Footrest height 28 cm
Weight 8,4 kg

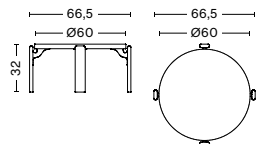

COFFEE TABLE
Width 66,5 cm
Depth 66,5 cm
Height 32 cm
Diameter tabletop 60 cm
Weight 5,9 kg

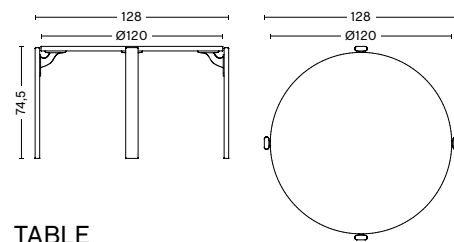

TABLE
Width 128 cm
Depth 128 cm
Height 74,5 cm
Diameter tabletop 120 cm
Weight 30 kg





PRODUCT INFORMATION

DESIGN YEAR
Relaunched 2022

COUNTRY OF ORIGIN
Hungary

OPTIONS
Felt gliders for wooden floor
Seat upholstery on Chair and Bar stool
CMHR foam (fire retardant)

CARE & MAINTENANCE
Our Care & Maintenance offers guidance for optimal maintenance of your HAY product.
[LINK TO CARE & MAINTENANCE](#)

TESTS | SEATING

EN TEST EN 16139 - L2
Non-domestic seating
Applies to Chair, Bar Stool & Stool

BIFMA ANSI BIFMA X5.1
Office chairs
Applies to Bar Stool

BIFMA ANSI BIFMA X5.4
Lounge and public seating
Applies to Chair & Stool

TESTS | TABLES

EN TEST EN 15372 - L2
Non-domestic tables
Applies to Table & Coffee Table

BIFMA ANSI BIFMA X5.5
Desk and table
Applies to Table & Coffee Table

SUSTAINABILITY

HAY focuses on developing long-lasting products that minimise our environmental impact. We optimise the use of sustainable materials such as recycled materials, FSC-certified wood and water-based lacquer, with a growing number of eco-certified products. We have strict regulatory requirements, and the majority of our products are tested to comply with international standards for strength, durability and safety.

[LINK TO ENVIRONMENTAL PROFILE](#)